

DIMENSIONS	cm	
(A) 6"	15	MAX.
(B) 1-1/2"	4	MIN.
(C) 1/2"	1.5	MIN.
(D) 1"	2.5	MIN.
(E) 12"	30	APPROX.

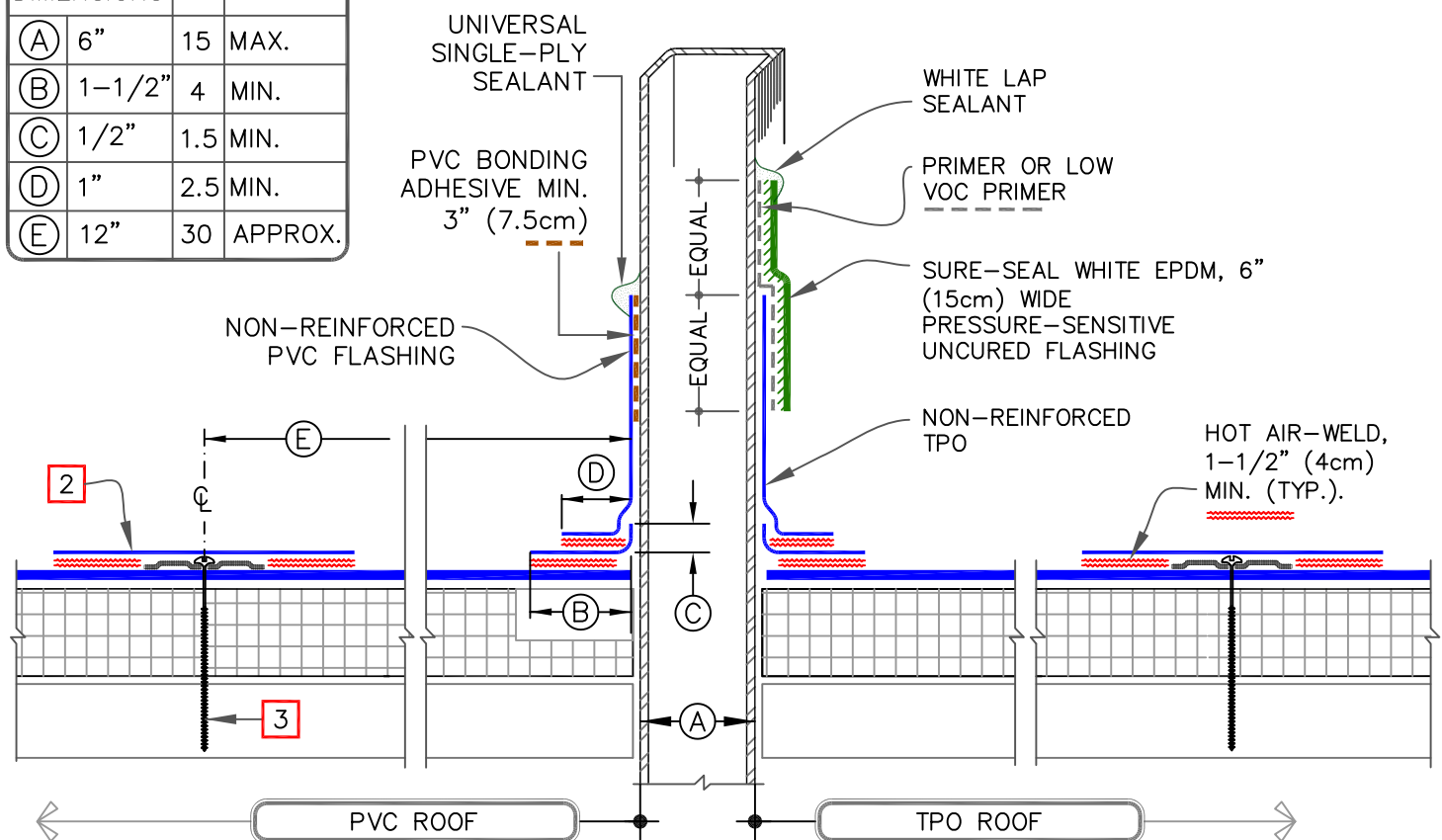

FASTENER TYPES ON MECHANICALLY FASTENED ROOF ASSEMBLY

DECK TYPE	FASTENERS	PLATES
STEEL & WOOD DECK	HP-X	PIRANHA
	OR	
	HP-XTRA	PIRANHA XTRA
CONCRETE DECK	CD-10 OR HD 14-10	PIRANHA

NOTES:

1. REMOVE ALL EXISTING LEAD AND FLASHING MATERIAL BEFORE INSTALLING PRE-FABRICATED SQUARE TUBE WRAP.
2. 8" (20cm) PRE-CUT PVC REINFORCED COVER STRIP. KEE HP 8" REINFORCED COVER STRIP IS AVAILABLE FOR USE WITH KEE HP MEMBRANE.
3. CARLISLE FASTENERS & SEAM FASTENING PLATES FOR MECHANICALLY FASTENED SYSTEM (NOT REQUIRED ON ADHERED SYSTEM). SEE TABLE ABOVE.
4. T-JOINT COVERS ARE NOT REQUIRED ON WHITE, TAN OR GRAY, FOR ADDITIONAL COLORS IT IS REQUIRED TO COVER T-JOINTS.

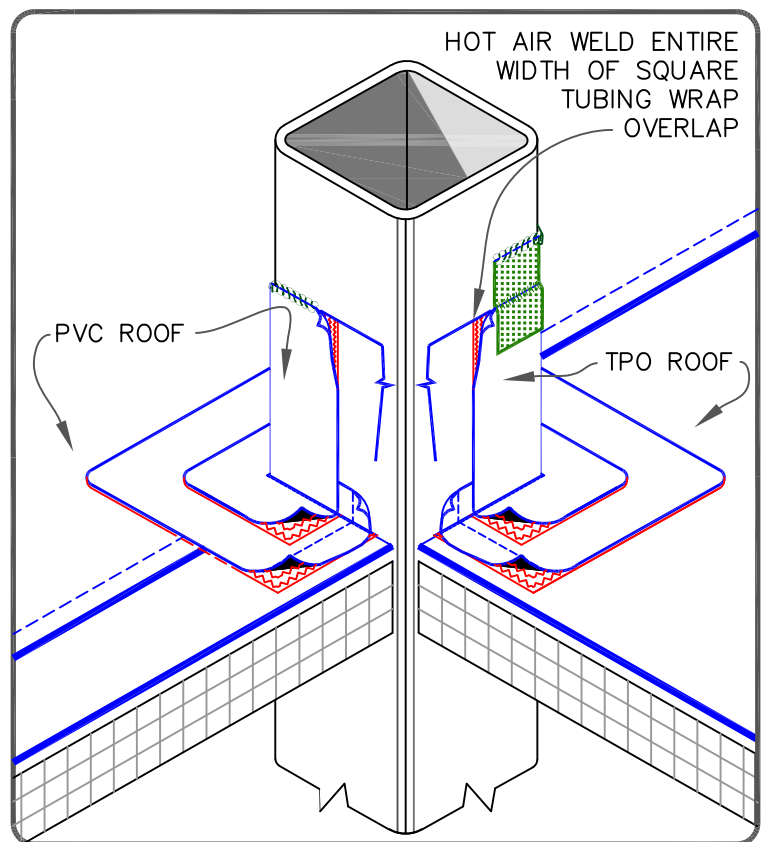

FIELD-FABRICATED SQUARE TUBE FLASHING

MAXIMUM WARRANTY: 20 YEARS



DETAIL NO.

U-8D

THERMOPLASTIC UNIVERSAL