

| REVISION STATUS - ALL SHEETS ARE THE SAME REVISION | | | | |
|--|------|-------------|------------|----------|
| ZONE | REV. | DESCRIPTION | DATE | APPROVED |
| | X1 | DEVELOPMENT | 02/15/2017 | KRH |

NOTES: UNLESS OTHERWISE SPECIFIED

- 1 MATERIAL: MATERIAL SPECIFIED AT INDIVIDUAL PART LEVEL
- 2 ALL DIMENSIONS ARE TO THEORETICAL SHARP.
- 3 REMOVE BURRS AND BREAK ALL SHARP EDGES .03 MAX.
- 4 ALL DIMENSIONS ARE IN INCHES UNLESS STATED OTHERWISE.
- 5 PARTS SHALL BE FREE OF GREASE AND CUTTING FLUID.
- 6 POWDER COAT PER MIL-PRF-24712A (TYPE 3, CLASS 3)

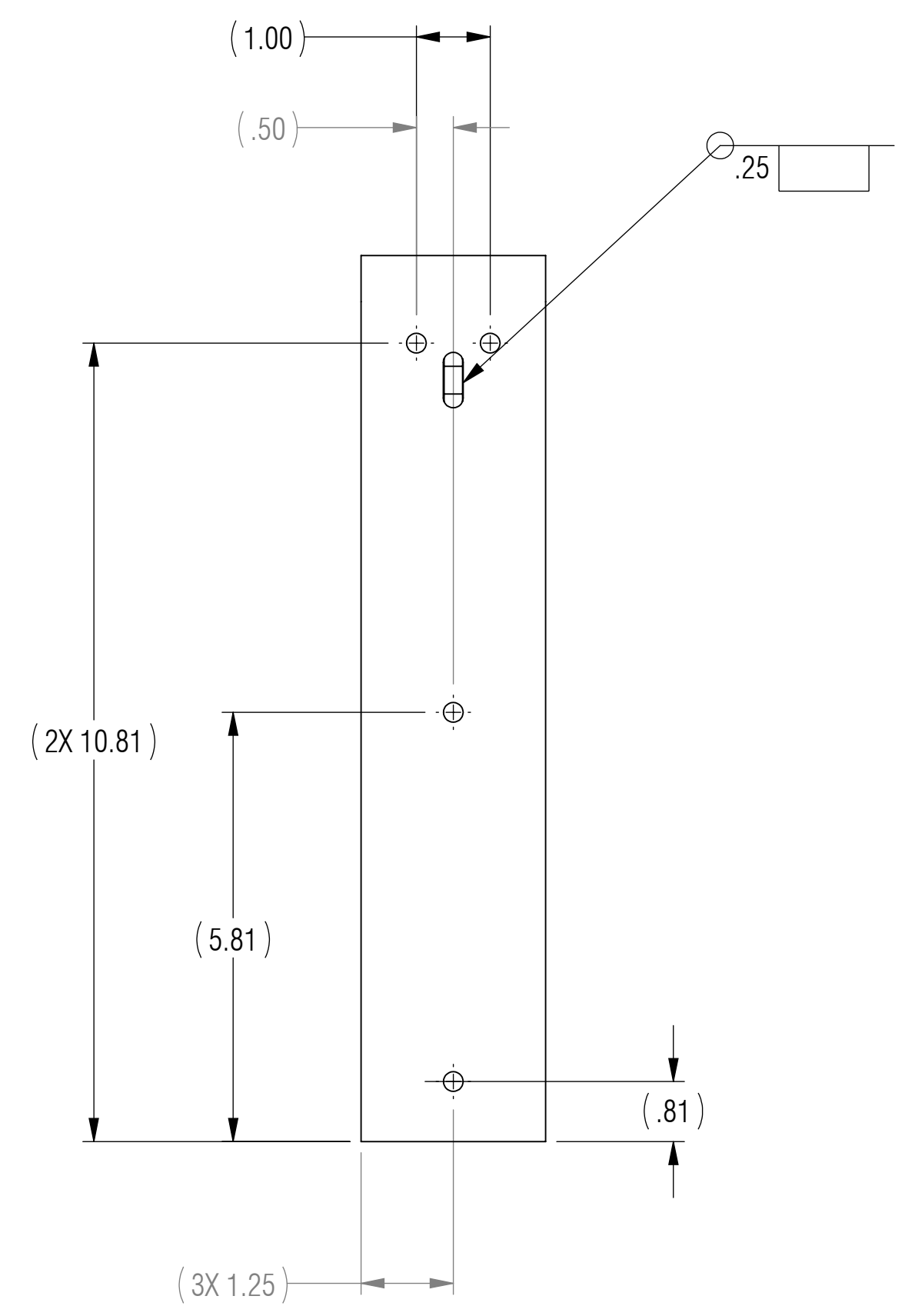
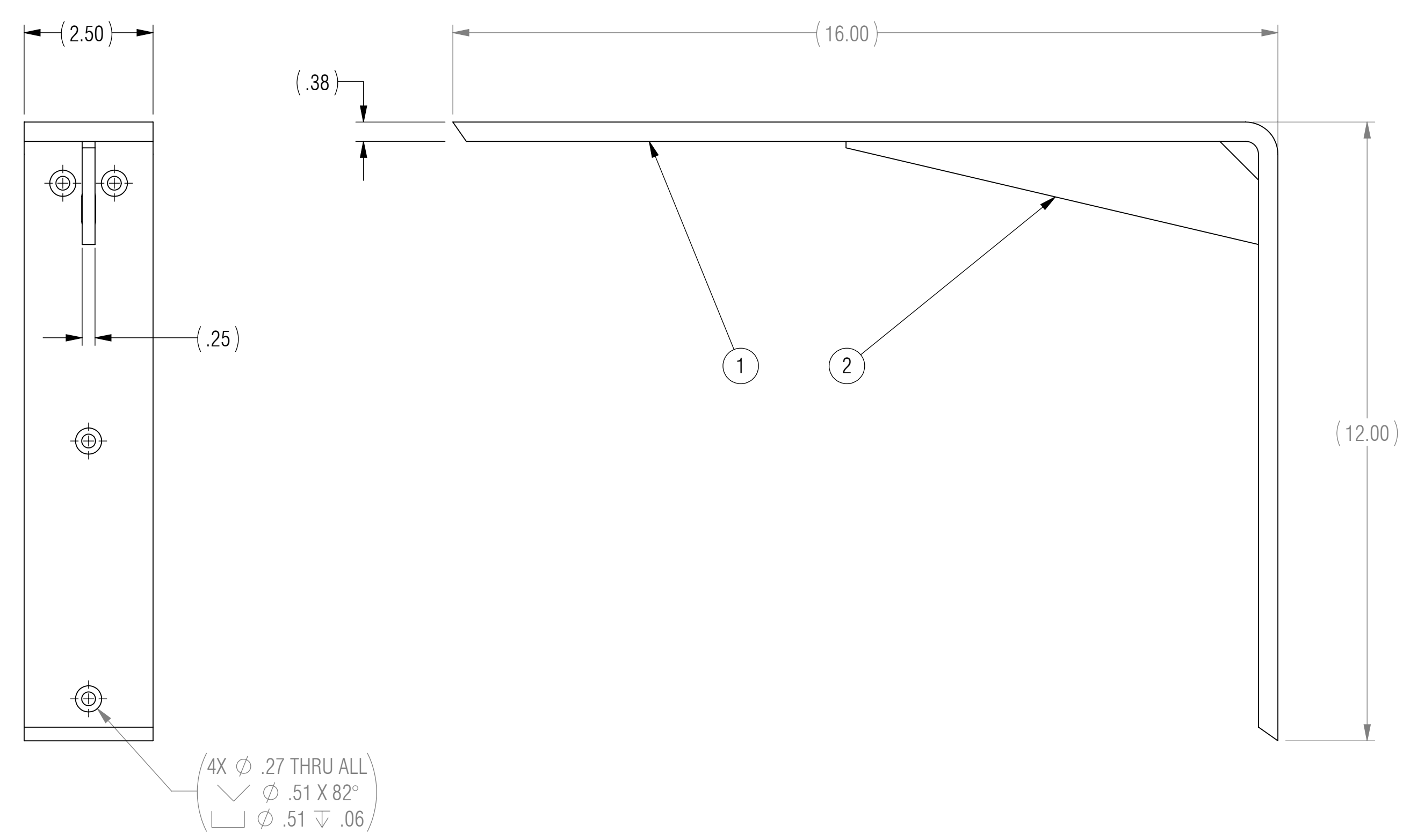
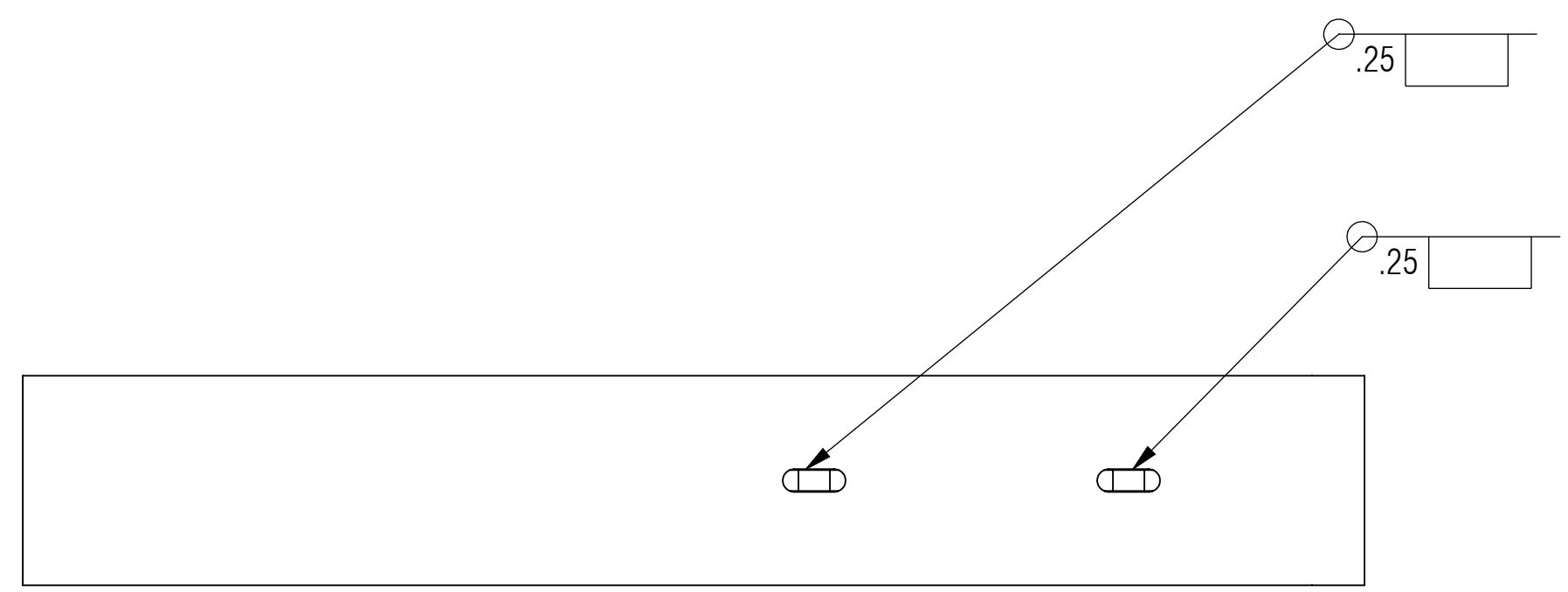

(4X ϕ .27 THRU ALL)
 \sphericalangle ϕ .51 X 82°
 \sqsubset ϕ .51 ∇ .06

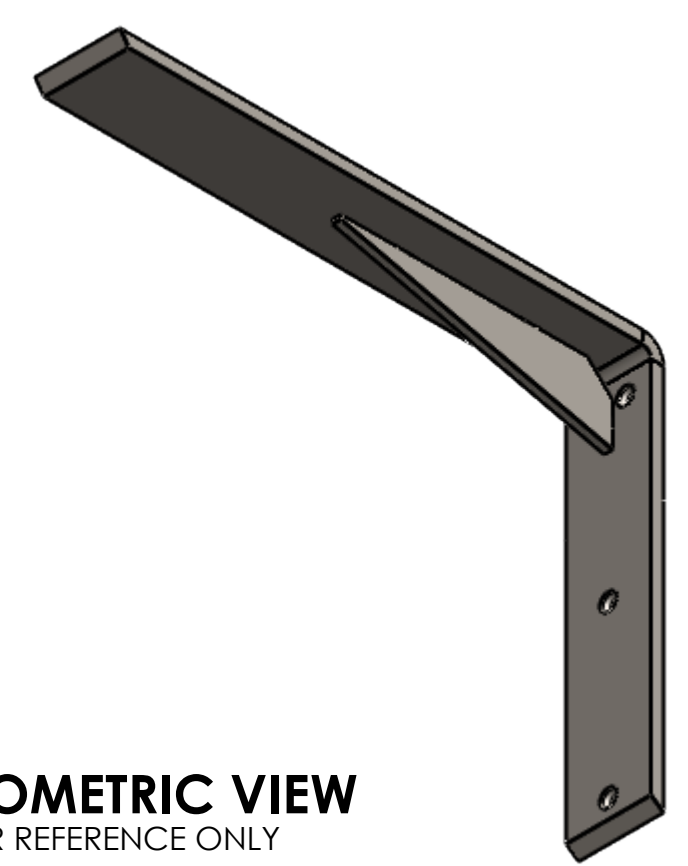

ISOMETRIC VIEW
FOR REFERENCE ONLY

| BOM TABLE | | | |
|-----------|-------------|-------------------------|------|
| ITEM NO. | PART NUMBER | DESCRIPTION | QTY. |
| 1 | FMM-16X12 | FRONT MOUNTING MODIFIED | 1 |
| 2 | G-08 | GUSSET | 1 |

| | | | |
|---|--|---|----------------|
| UNLESS OTHERWISE SPECIFIED: DIMENSIONS ARE IN INCHES | | ENGINEER | |
| TOLERANCES ARE: | | ENGINEER | |
| .XX ± .01 | ANGLES | ENGINEER | |
| .XXX ± .005 | XX° ± 1° | CHECKED | CAS 02/15/2017 |
| | | DRAWN | KRH 02/15/2017 |
| | | MANAGER APPROVAL | |
| INTERPRET DRAWINGS IN ACCORDANCE WITH: | | THE INFORMATION ON THIS DRAWING IS PROPRIETARY AND SHALL NOT BE DISCLOSED, USED, OR DUPLICATED FOR PROCUREMENT OR MANUFACTURING PURPOSES WITHOUT THE EXPRESS WRITTEN CONSENT OF CENTERLINE STEEL, LLC | |
| ASME Y14.100 | ENGINEERING DRAWING PRACTICES | THIRD ANGLE PROJECTION | |
| ASME Y14.38 | ABBREVIATIONS | | |
| ASME Y14.5 | DIMENSIONING AND TOLERANCING | | |
| ASME Y14.6 | SCREW THREAD REPRESENTATION | | |
| ASME Y14.8 | CASTINGS, FORGINGS & MOLDED PARTS | | |
| AWS A2.4 | WELDING SYMBOLS | | |
| IEEE STD 315 | SYMBOLS FOR ELECTRICAL AND ELECTRONIC DIAGRAMS | | |
| USED ON | APPLICATION | | |

RELEASED

FRONT MOUNTING PLUS

| | | | |
|-------|-----------|--------------|-----|
| SIZE | CAGE CODE | DRAWING NO | REV |
| D | | FMP-16X12 | X1 |
| SCALE | 1:2 | SHEET 1 OF 1 | |