

**SILL OPENING
(HIGH CELL)
(EXTRUSION)
(CS-6506)**

FLASHING DESIGN MAY VARY
DUE TO PANEL MODULE LAYOUT

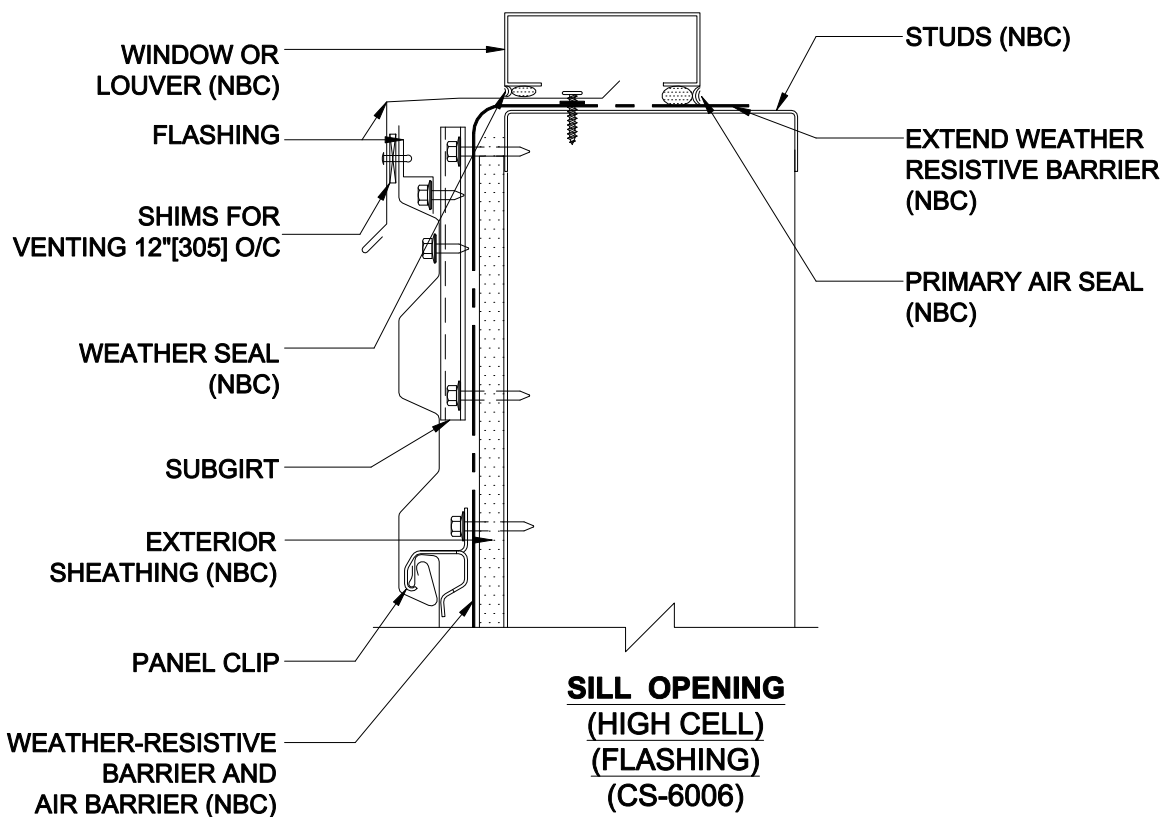

**SILL OPENING
(HIGH CELL)
(FLASHING)
(CS-6006)**

(NBC) = NOT BY CENTRIA



CENTRIA
CENTRIA Architectural Systems

CONCEPT SERIES PANELS
HORIZONTAL APPLICATION

page
CSH-18

Oct. 16