

CLARION BATHWARE

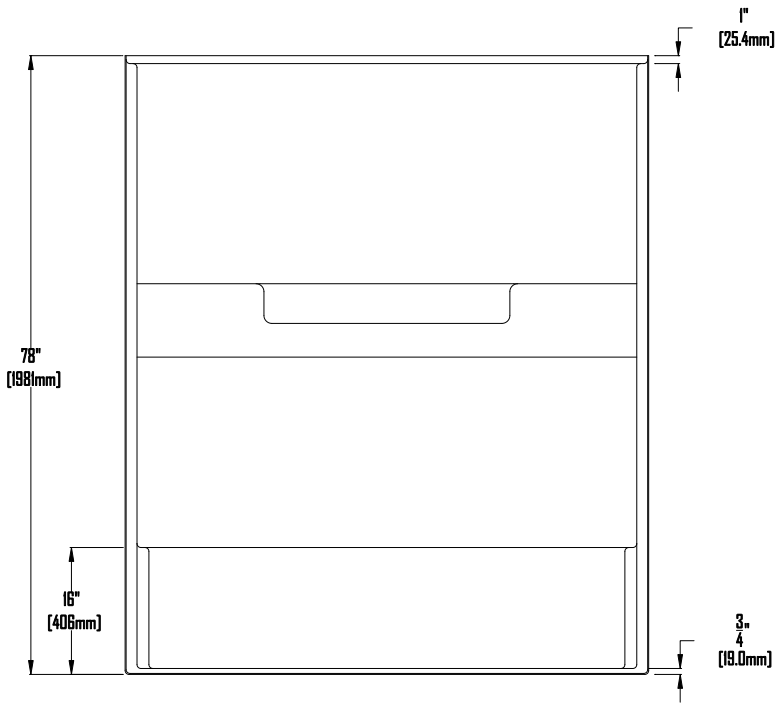

ELEVATION

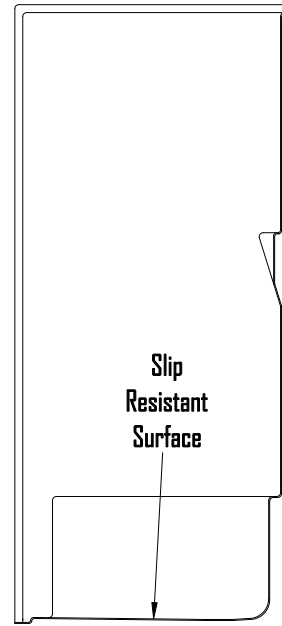

SECTION "A - A"

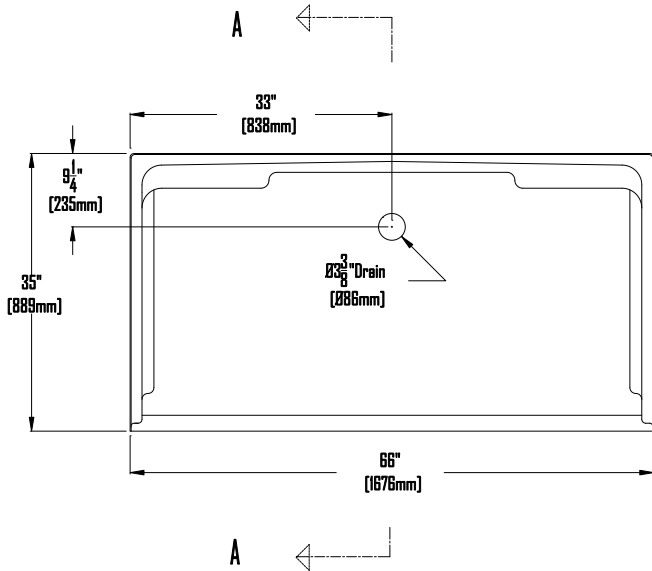

PLAN

Specifications:

- * Special installation instructions for this unit must be followed carefully
- * Units comply with NAHB, ADA, HUD UM73-A, ANSI-Z124.2 and ANSI A117.1
- * Wood reinforced floor
- * Slip resistant floor
- * 1" [25.4mm] nailing flange
- * All dimensions +/- 1/4" [6.35mm]
- * Clarion Bathware reserves the right to change design and/or dimensions
- * Dimensions are the same for RE, RG, MP, and CU versions of this model
- * Accepts Model 6635TX34 tub insert so that this unit can be converted to a tub/shower.

66" [1676mm] Convertible Barrier-Free Shower Stall

With 3/4" [19.1mm] Threshold

Model 66358FSD34

Signature For Approval:

Date:

Customer: _____
 Arch./Engr: _____
 Contractor: _____
 Cls. Engr: _____

Shipperville, Pa. 16254
 Phone: 814-226-5374
 Fax: 814-226-0730
 www.clarionbathware.com

Dwg. by: DJC

Engr. Ckd. by: BAM

DATE OF LAST REVISION: 9/9/03