

FLOORS, INTERIOR

Wood Subfloor, 16" o.c. Joist Spacing

Chemical Resistant, Epoxy Mortar and Grout

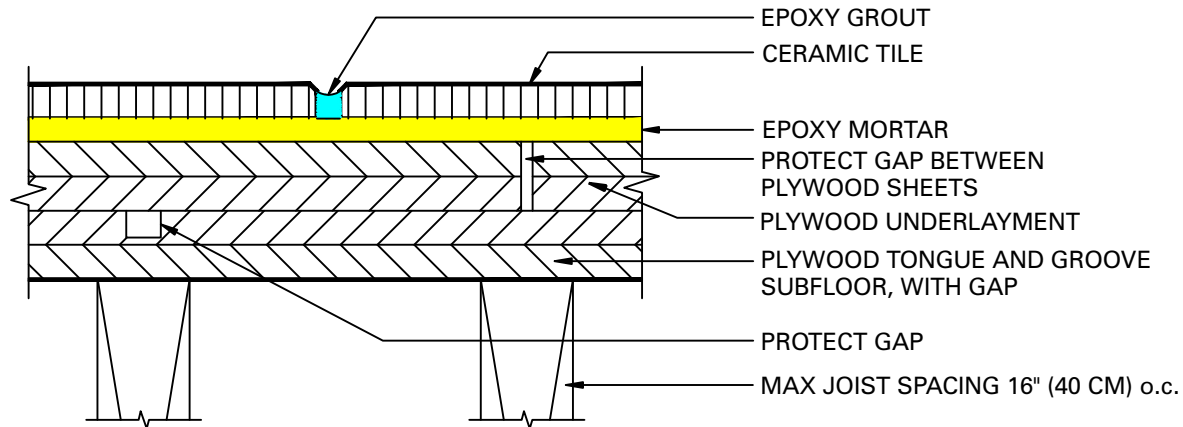

Grout Option:

- CEG-2000™ 100% Solids Commercial Epoxy Grout

Epoxy Mortar Options:

- CEG-2000™ 100% Solids Commercial Epoxy Grout
- 100% Solids Epoxy Mortar

These drawings have been taken from Tile Council of America's (TCA) Handbook for Ceramic Tile Installation and are also compatible with the drawings in Terrazzo, Tile and Marble Association of Canada's (TTMAC) Handbook. For your convenience, Custom Building Products options are substituted for TCA's and TTMAC's generic product descriptions. Please refer to the handbooks for complete information.

