

FLOORS, INTERIOR

Wood Subfloor, 16" o.c. Joist Spacing

Mortar Bed, Lath

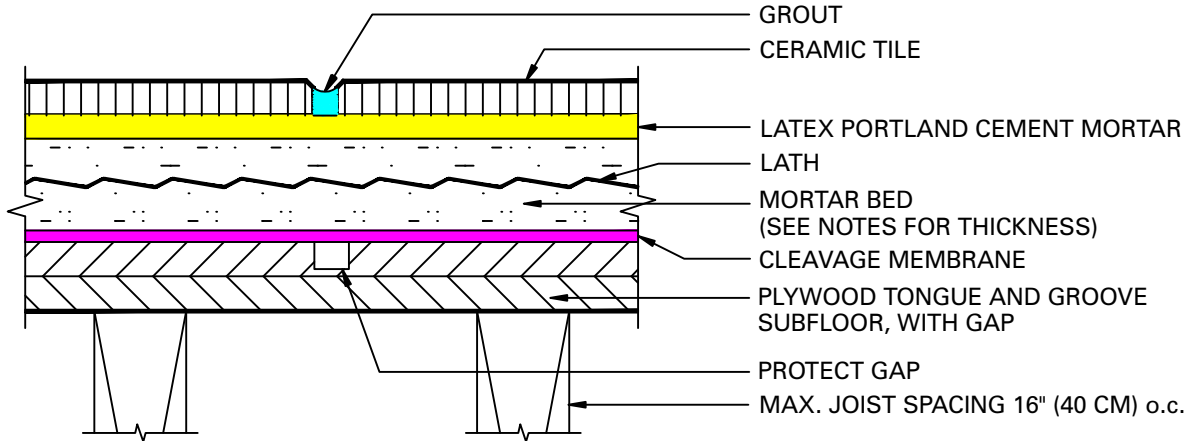

Grout Options:

- Prism® SureColor® Grout
- Polyblend® Sanded Grout
- Polyblend® Non-Sanded Grout

Waterproofing Membrane Options:

- RedGard® Waterproofing and Crack Prevention Membrane
- Custom® 9240 Waterproofing and Anti-Fracture Membrane

Note: This installation method calls for a cleavage membrane. RedGard or Custom 9240 can be substituted as a cleavage membrane when a high-end cleavage membrane is desired as a waterproofing and anti-fracture membrane.

Latex Portland Cement Mortar Options:

- MegaLite® Crack Prevention Mortar
- MegaFlex® Crack Prevention Mortar
- FlexBond® Crack Prevention Mortar
- ProLite® Tile & Stone Mortar
- VersaBond Flex® Fortified Thin-Set Mortar
- Complete Contact™ Fortified Mortar
- Porcelain Tile Fortified Thin-Set Mortar

Rapid Setting Mortars:

- MegaLite® Rapid Set Crack Prevention Mortar
- ProLite® Rapid Set Tile & Stone Mortar
- SpeedSet™ Fortified Thin-Set Mortar
- Complete Contact™ RS Fortified Mortar

Medium Bed Mortars:

- Marble & Granite Fortified Premium Mortar
- Medium Bed Mortar
- Complete Contact™ Fortified Mortar
- Complete Contact™ RS Fortified Mortar

Note: Residential installations: 3/4" (19 mm) min. mortar thickness for areas up to and including 100 sq. ft. (9.29 m²) and 1-1/4" (3.2 cm) min. mortar thickness for areas greater than 100 sq. ft. (9.29 m²).

These drawings have been taken from Tile Council of America's (TCA) Handbook for Ceramic Tile Installation and are also compatible with the drawings in Terrazzo, Tile and Marble Association of Canada's (TTMAC) Handbook. For your convenience, Custom Building Products options are substituted for TCA's and TTMAC's generic product descriptions. Please refer to the handbooks for complete information.



CUSTOM[®]
BUILDING PRODUCTS