

NOTE:
 1. DIMENSIONS AND NOTES ON THIS DRAWING SUPERSEDE TITLE BLOCK
 2. ALUMINUM ASSOCIATION STANDARD TOLERANCES APPLY FOR EXTRUSION PROFILE.
 3. ALL DIMENSIONAL LIMITS APPLY BEFORE COATING, I.E. PAINT COAT OR ANODIZE COAT.

REVISION HISTORY				
REV	DESCRIPTION	ECN #	MFG APPRO	DATE
0				

OUTLINE LETTERS FOR THE LOGO

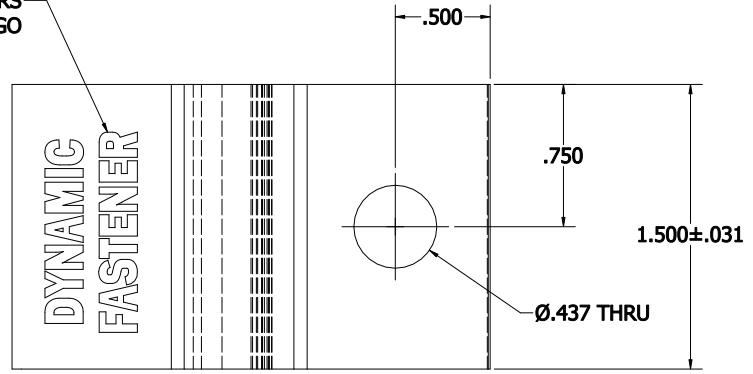

OUTLINE LETTERS FOR THE LOGO

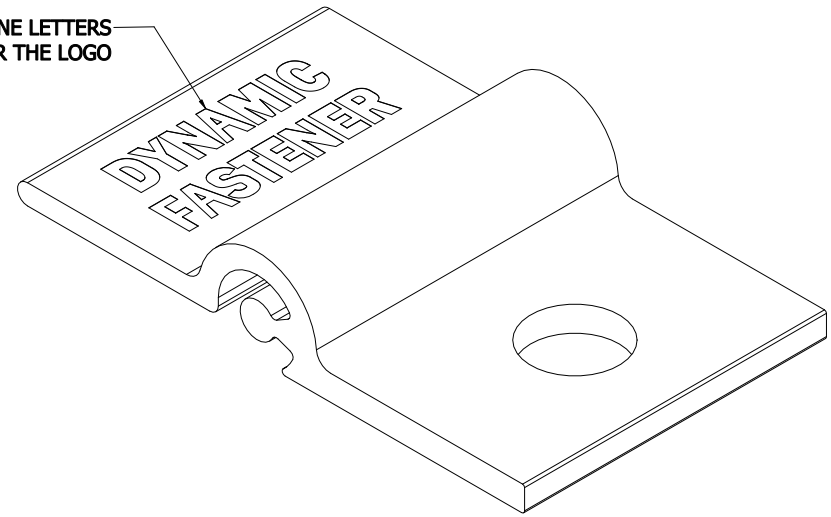

ISO METRIC VIEW
SCALE: 3X

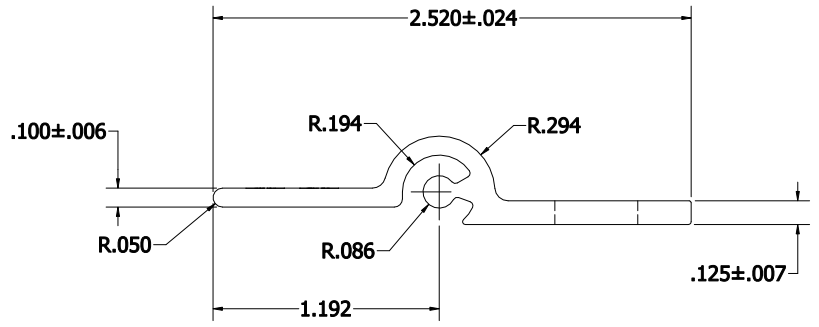

END VIEW
SEE EXTRUSION DIE PRINT FOR MORE DETAILS

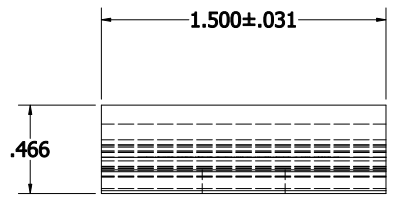

DRAWN BY: DUC LE	DATE: 9/14/2018
FINISH: MILL	
MASS: N/A	
MATERIAL: ALUM ALLOY 6061-T6	
ITEM CODE: 5622F9001	
LENGTH: 1.5"	
CAD FILE: M:/FAB/ALEX/SAP DOC/DYNAMIC/DYNACLIP	

DYNAMIC FASTENER		
PART NAME: DYNA-CLIP		
SIZE C	DRAWING NO.: DYNA-CLIP DWG	REV. 0
DO NOT SCALE DRAWING		SHEET 1 OF 1

DIMENSIONS ARE IN INCHES.
 ALUMINUM ASSOCIATION STANDARD TOLERANCES APPLY FOR EXTRUSION PROFILE ONLY, UNLESS OTHERWISE SPECIFIED, FAB DIMS TOLERANCES ARE:
 FRACTIONAL: ±.01" ; ANGULARITY: ±1'
 [.XXX : ±.020] [.XX : ±.031] [.X : ±.063]
 DRAWING GENERATED BY INVENTOR SOFTWARE

THE INFORMATION CONTAINED IN THIS DRAWING IS THE SOLE PROPERTY OF AFCO INDUSTRIES, INC. ANY REPRODUCTION IN PART OR WHOLE WITHOUT THE WRITTEN PERMISSION OF AFCO INDUSTRIES, INC. IS PROHIBITED.