

# RAKE FLASHING - OPTIONS

MC-19A

SEE DRAWING MC-12B FOR ADDITIONAL FLASHING INFORMATION

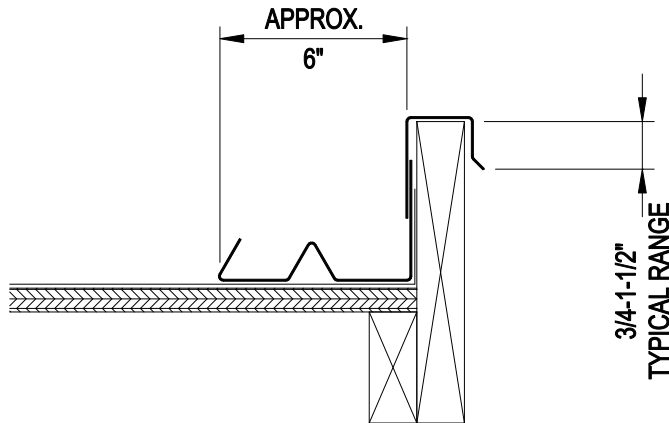

2 PIECE METAL PAN FLASHING WITH DRIP EDGE

NOTE:  
6" PAN DIMENSION WILL VARY  
BASED ON EXPECTED WATER  
FLOW & DEPTH OF FLASHING.  
TYPICAL ALL DETAILS.

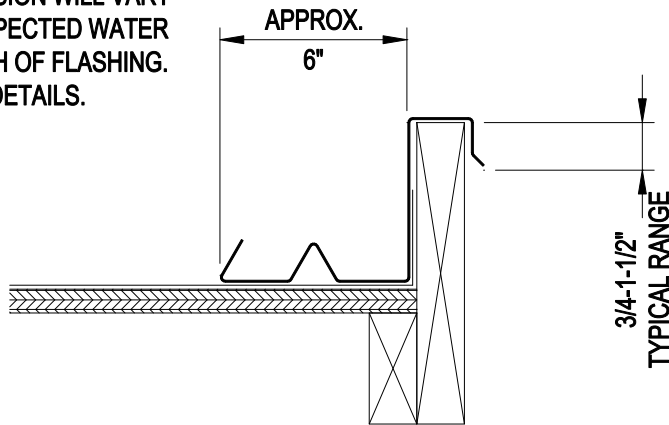

ONE METAL PAN FLASHING WITH DRIP EDGE



OPTIONAL CLEAT DRIP EDGE

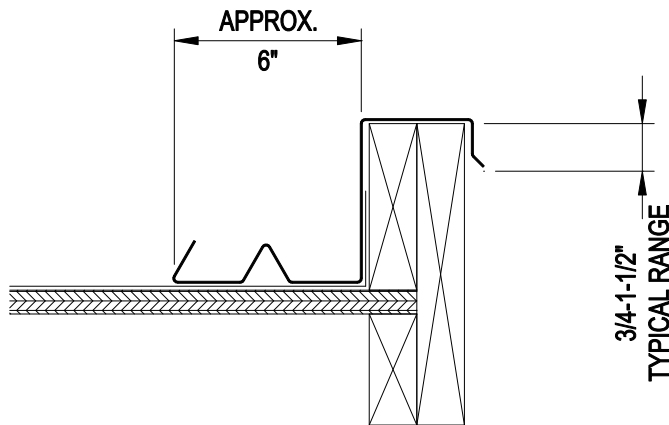

METAL PAN FLASHING WITH DRIP EDGE

Notes:

1. Flashing details may vary according to local weather conditions, slope of roof and tributary water area.
2. Underlayment will extend a minimum of 4" up vertical wood blocking, wall, or to the top of gable fascia.
3. Sheet metal Flashing should be a minimum of 26 ga. G-90 galvanized steel, 16 oz. copper or an equivalent longevity non-corrosive metal.
4. Dimensions shown are minimums and are intended to be approximate to allow for reasonable tolerances due to field conditions.
5. Rake flashing and wood nailer/trim board will be raised above the roof deck to a height greater than the height of the installed roof tile.