

EQUITONE EXPOSED FASTENER USING VERTICAL GIRT SYSTEMS ON STEEL STUD CONSTRUCTION

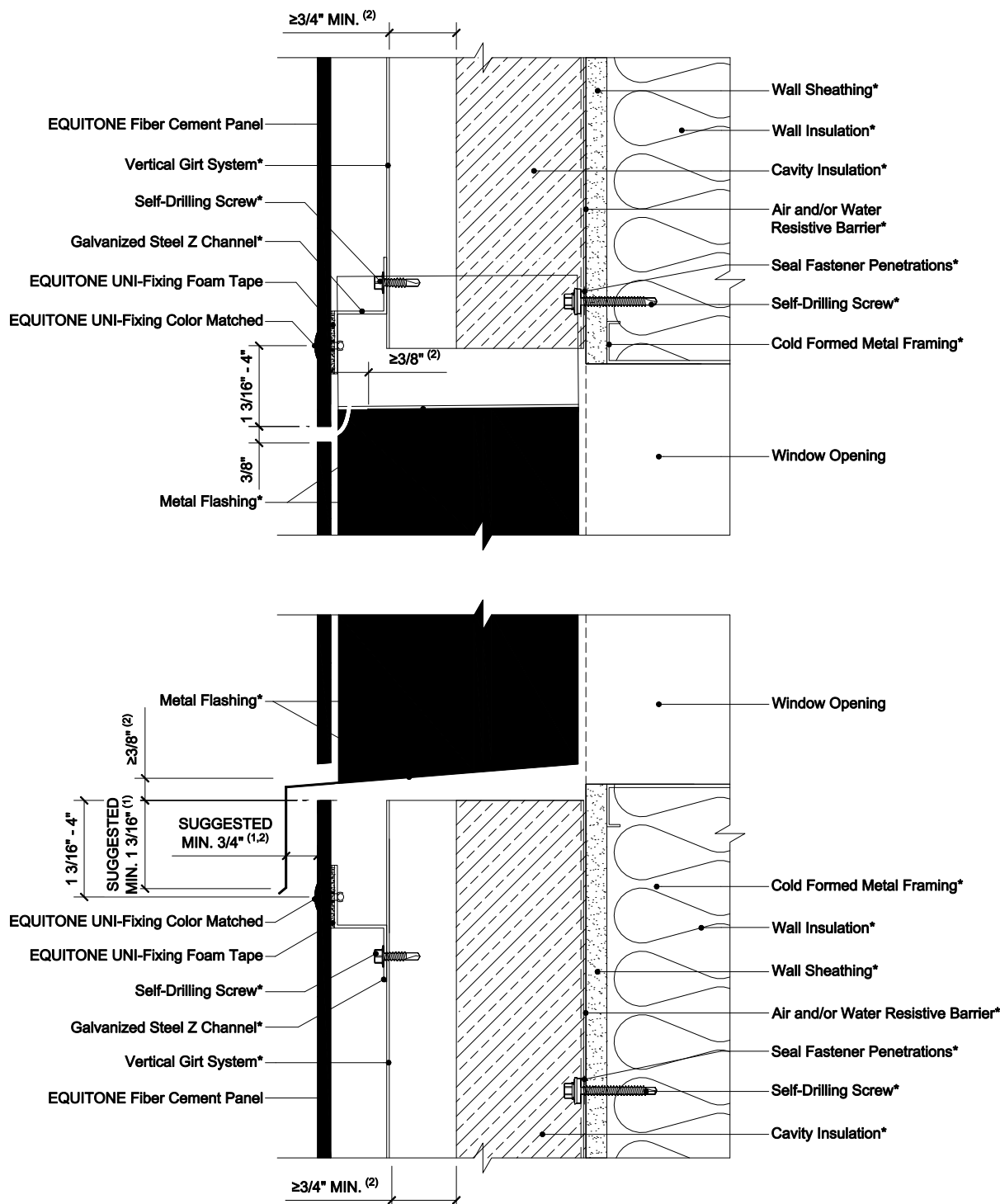

NOTES:

1. A smaller overlap or offset is possible, but it may increase the risk of water marks and panel staining caused by runoff. Smaller capping is also more prone to wind driven rain entering the cavity. At minimum, EQUITONE's ventilation guidelines must be followed.
2. Inlet/Outlet, air cavity, and closure perforation sizing should be modified, from those expressed herein, depending upon building height and/or local legislation. Visit the Planning and Application Guide - Face Fixing to Metal for additional information
3. (*) symbol represents materials not supplied by EQUITONE.

DETAIL #: EQ-EF-VG-SS-WHS2

RELEASE: 202412

REGION: NORTH AMERICA

WWW.EQUITONE.COM

WINDOW HEAD AND
SILL DETAILS -
OPTION 2