

NOTE:  
 BOTTOM LAYER OF INSULATION SHALL BE LAID DOWN IN  
 A STAGGERED PROFILE, STAGGER AND OFFSET TOP LAYER  
 OF INSULATION FROM BOTTOM LAYER TO PREVENT  
 ALIGNED EDGES.

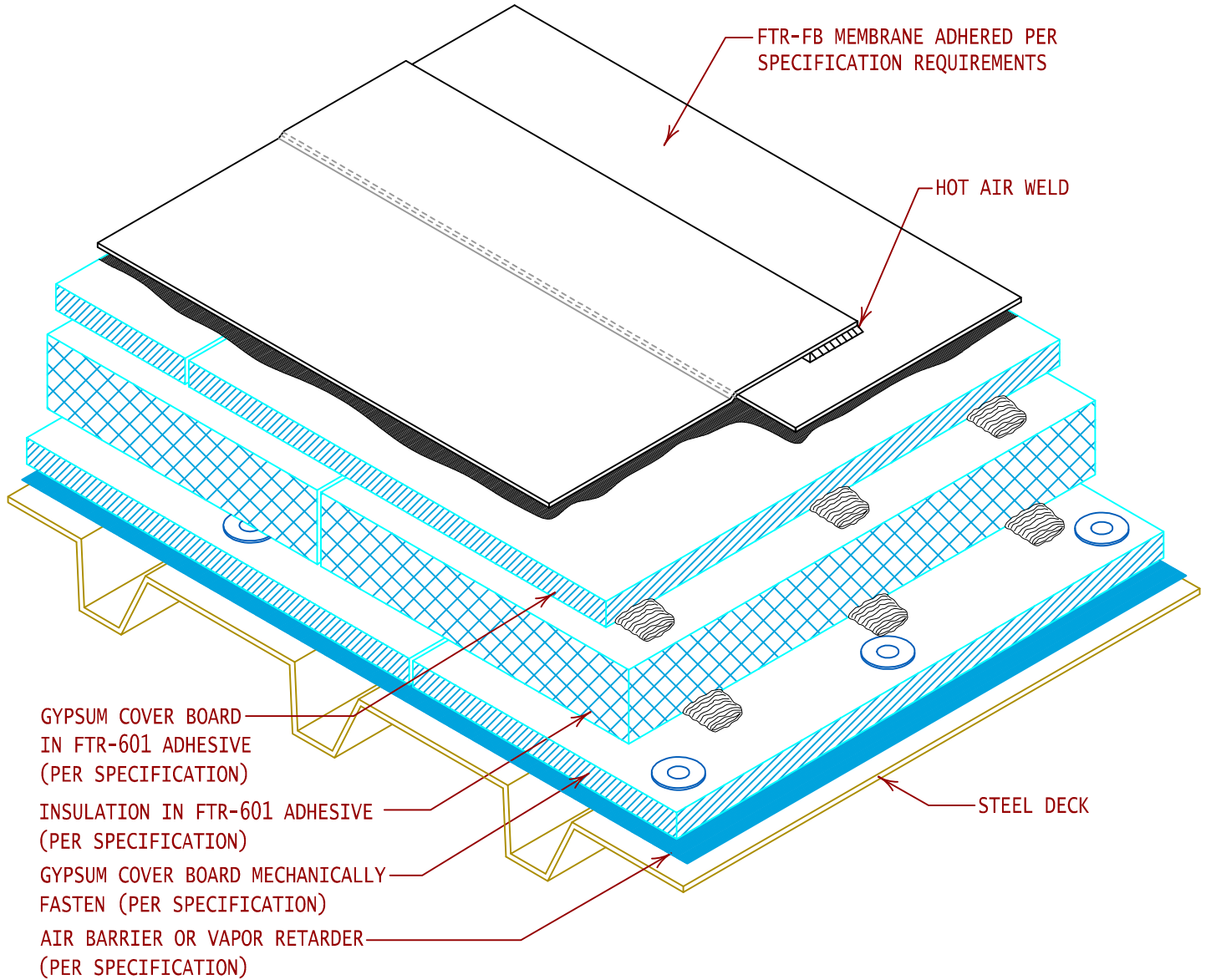

GENERAL REFERENCE:  
 "FTR GS 02/13"  
 APPLICABLE SYSTEMS:  
 "FTR AD 02/13"

ROOF SYSTEM CROSS SECTION  
 (MECH. FAST. COVER BOARD & ADHERED INSUL.)

REVISES DETAIL	ISSUE DATE	DRAWING NUMBER
ALL PREVIOUS	06-16-15	FTR-DAS12SP