

NOTE:
 BOTTOM LAYER OF INSULATION SHALL BE LAID DOWN IN
 A STAGGERED PROFILE. STAGGER AND OFFSET TOP LAYER
 OF INSULATION FROM BOTTOM LAYER TO PREVENT
 ALIGNED EDGES.

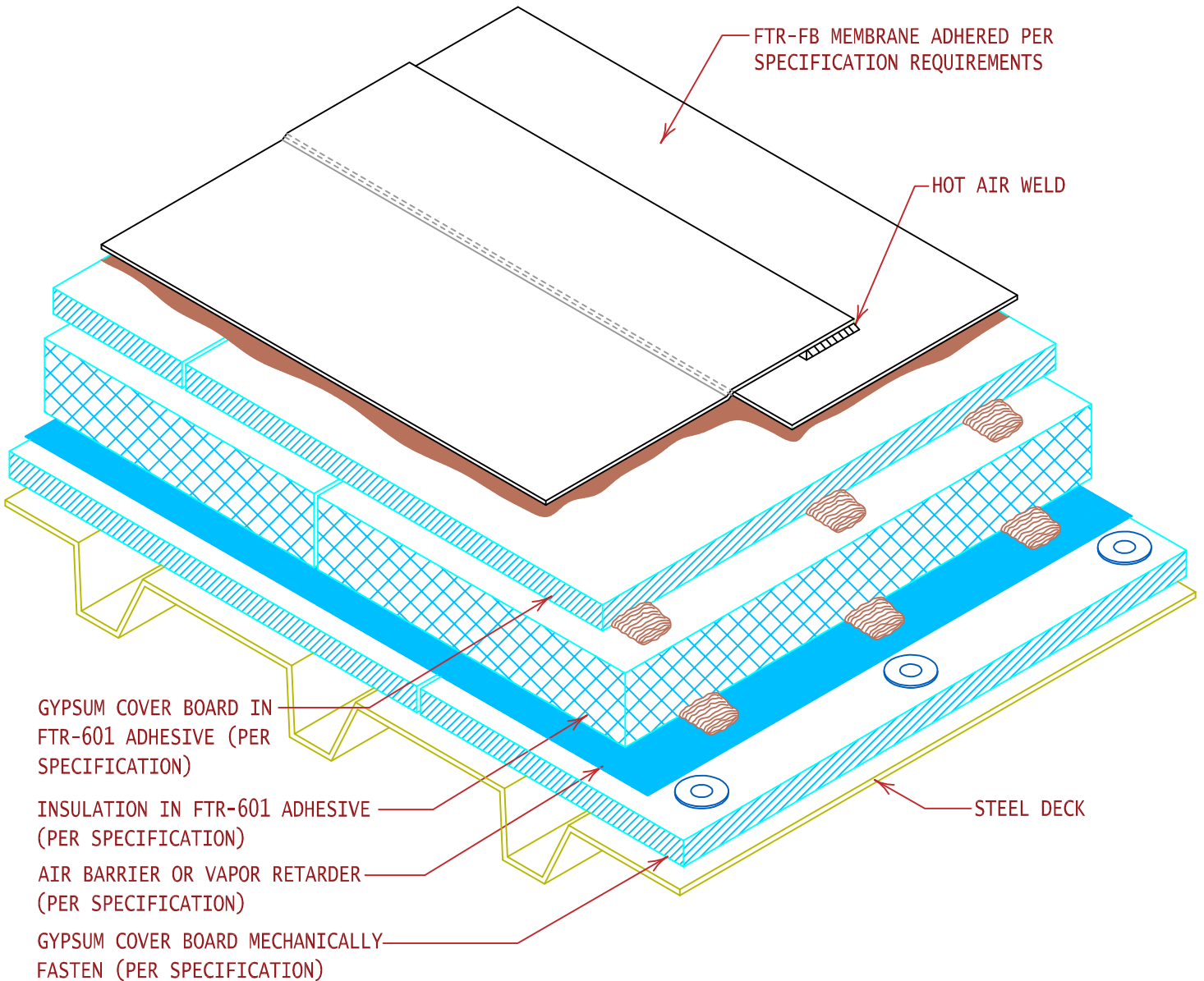

GENERAL REFERENCE:
 "FTR GS 02/13"
 APPLICABLE SYSTEMS:
 "FTR MP 02/13"

ROOF SYSTEM CROSS SECTION
 (MECH. FAST. & ADHERED INSUL.)

REVISES DETAIL	ISSUE DATE	DRAWING NUMBER
ALL PREVIOUS	06-16-15	FTR-DAS18SP