

NOTE:  
 BOTTOM LAYER OF INSULATION SHALL BE LAID DOWN IN  
 A STAGGERED PROFILE. STAGGER AND OFFSET TOP LAYER  
 OF INSULATION FROM BOTTOM LAYER TO PREVENT  
 ALIGNED EDGES.

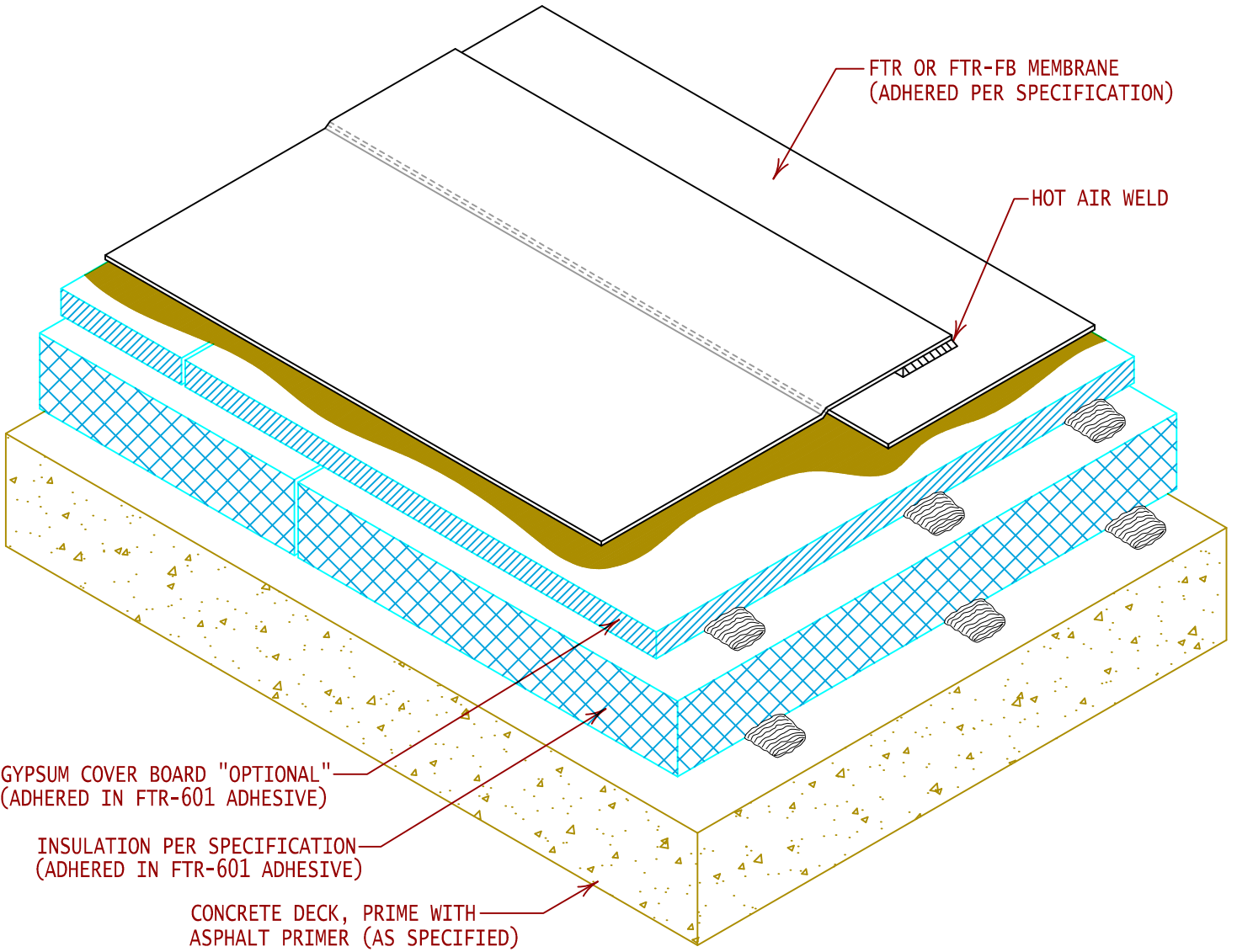

FTR OR FTR-FB MEMBRANE  
 (ADHERED PER SPECIFICATION)

HOT AIR WELD

GYPSUM COVER BOARD "OPTIONAL"  
 (ADHERED IN FTR-601 ADHESIVE)

INSULATION PER SPECIFICATION  
 (ADHERED IN FTR-601 ADHESIVE)

CONCRETE DECK, PRIME WITH  
 ASPHALT PRIMER (AS SPECIFIED)



GENERAL REFERENCE:  
 "FTR GS 02/13"  
 APPLICABLE SYSTEMS:  
 "FTR AD 02/13"

COMPOSITE ROOF SYSTEM CROSS SECTION  
 (ADHERED INSULATION IN FTR-601 ADHESIVE)

REVISES DETAIL	ISSUE DATE	DRAWING NUMBER
ALL PREVIOUS	02-10-14	FTR-DAS2