

# "FSS-316" STANDARD TRIM SKETCHES

GA. # \_\_\_\_\_ COLOR \_\_\_\_\_

17

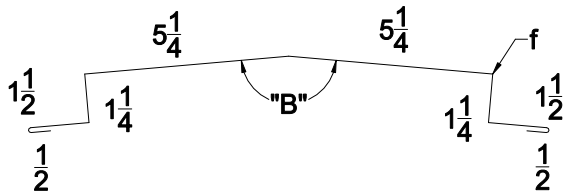

REQ'D: \_\_\_\_\_ PCS. @ 10'-0" LG.

GA. # \_\_\_\_\_ COLOR \_\_\_\_\_

14 <sup>5</sup>/<sub>8</sub>

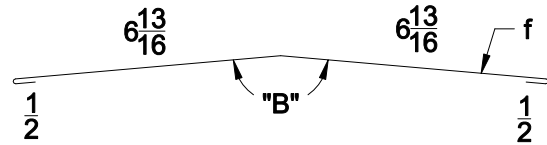

REQ'D: \_\_\_\_\_ PCS. @ 1'-6" LG.

## "SS3-01-1" RIDGE CAP

GA. # \_\_\_\_\_ COLOR \_\_\_\_\_

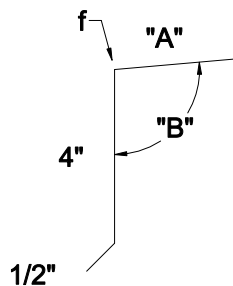

REQ'D: \_\_\_\_\_ PCS. @ 10'-0" LG.

## "SS3-01-1A" RIDGE CAP

GA. # \_\_\_\_\_ COLOR \_\_\_\_\_

7 <sup>1</sup>/<sub>4</sub>

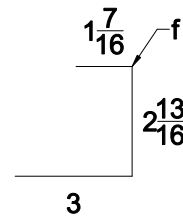

REQ'D: \_\_\_\_\_ PCS. @ 10'-0" LG.

## "SS3-02-2" EAVE TRIM

## "SS3-01-2" CEE CLOSURE

### NOTES:

1. ALL TRIM IS MANUFACTURED IN 10'-0" LENGTHS UNLESS SPECIFIED OTHERWISE.
2. MAXIMUM LENGTH OF TRIM IS 10'-0".
3. PLEASE INSERT GAUGE OF MATERIAL IN SPACES PROVIDED.
4. PLEASE INSERT COLOR OF MATERIAL IN SPACES PROVIDED.
5. PLEASE INSERT QUANTITY DESIRED WHERE SHOWN.
6. PLEASE INSERT REQ'D DIMENSIONS.



BOX 515 RAILROAD STREET  
SANDY LAKE, PENNSYLVANIA 16145-0515  
PHONE: 800-245-0396 ° FAX: 724-376-3864

"Fss-316" Standing  
Seam Details

DRAWN BY: K.Kemmer DATE: 9-1-00

REVISED BY: DATE:

"Fss-316" Standard Trim  
Sketches

DRAWING NO.  
FSS316-22