

PRODUCT CONSTRUCTION EXAMPLE

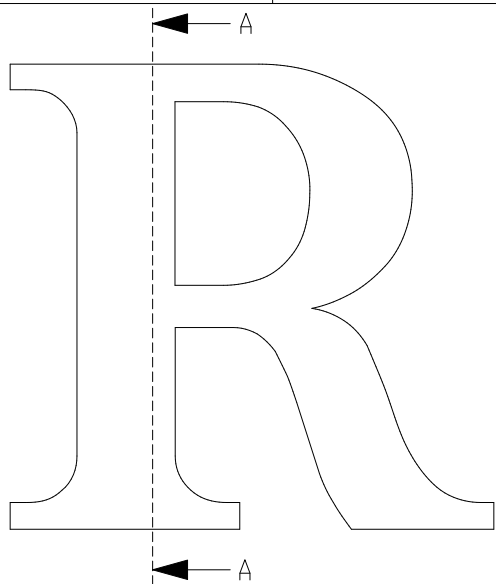

FRONT VIEW II SCALE 1:5

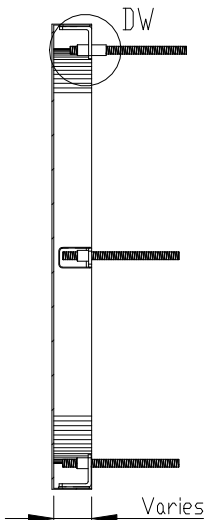

SECTION A-A II SCALE 1:5

18 gauge face material - up to 24" high - All strokes  
 18 gauge face material - over 24" high - up to 8" stroke  
 16 gauge face material - over 24" high - over 8" stroke

Lead free continuous solder inside face

Letter finish varies

"L" bracket secured with high resistance epoxy to return

Optional spacer sleeve (Size varies)

Threaded Stud Boss (Size varies by bracket)

Stainless steel mounting stud (Size varies (see table))

DETAIL DW II SCALE 1:1

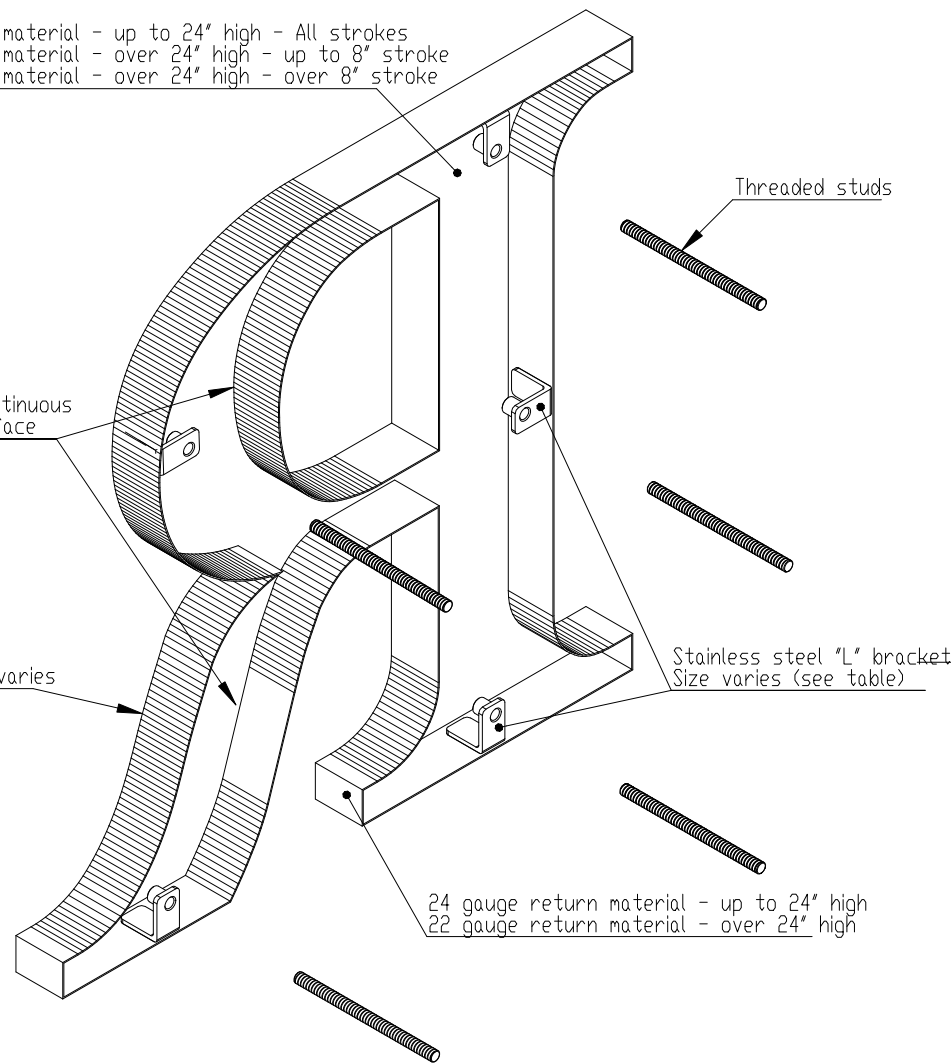

ISOMETRIC BACK VIEW II SCALE 1:3

LETTER SIZE	MIN. DEPTH AND STROKE		BRACKET	STUD
up to 8"	0.6"	15 mm	Small	6 - 32
over 8" to 24"	1.0"	25.4 mm	Medium	10 - 24
over 24"	2.0"	44.5 mm	Large	1/4 - 20

NOTES:  
 - Min. 3/8" stroke  
 - 2"- 4" high, return grain will be in long direction  
 MATERIAL OPTIONS  
 Standard - 304 prefinished stainless steel  
 Optional - 316 prefinished stainless steel (more corrosion resistant)  
 - 304 prefinished stainless with titanium coating



TITLE: METAL FACE NO BACK - SIDE MOUNT	
MATERIAL: STAINLESS STEEL	PRODUCT TYPE: FABRICATED METAL
DWG No. FAB10	REV. 03/13/17
SCALE: AS INDICATED	SHEET 1 OF 1