

**SIDE ELEVATION OF DOOR**

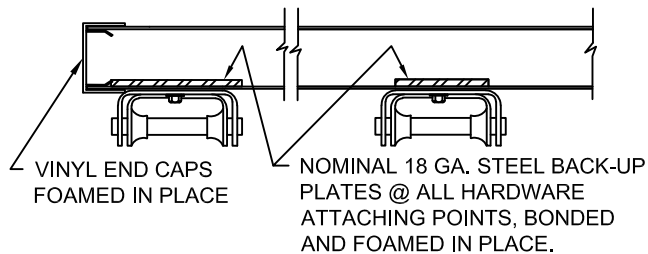

**HINGE DETAIL**

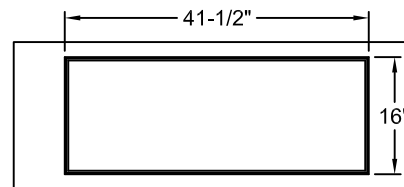

**PANEL DIMENSIONS**

**ADDITIONAL NOTES:**

AVAILABLE SECTION HEIGHTS ARE 18" AND 21", INSULATED BY FOAMING-IN-PLACE WITH HIGH DENSITY POLYURETHANE FOAM, MINIMUM 2.20 LBS./CUBIC FT.. EACH SECTION IS CONSTRUCTED TO PROVIDE FOR FULL THERMAL BREAK AT TOP, BOTTOM AND ENDS OF SECTION. NOMINAL THICKNESS OF SECTION WITH END STILES TO BE 2" FOR 2000 SERIES, 1-3/4" FOR 700 SERIES AND 1-3/8" FOR 600 SERIES. STEEL SKINS TO BE PRE-PAINTED WITH A URETHANE PRIMER BASE COAT AND A BAKED-ON POLYESTER TOP COAT.

MODEL NUMBER

**2063/763/663**

320 Sycamore St.  
Wauseon, Ohio 43567  
© Copyright 2020

