

FRONT

SIDE

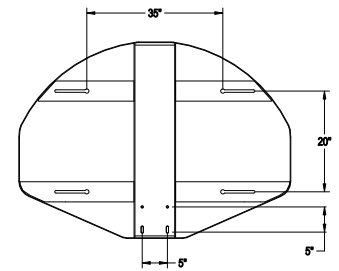

REAR

Backboard shall be constructed of formed and welded steel with a 39" x 54" fan-shaped playing surface. Skin shall be 12 ga. mild steel and support structure shall be 7 ga. and 10 ga. All skin edges shall be formed to create a 1 1/2" lip to add strength. The backboard shall be coated with a white polyester powder coated finish and have an official orange shooter's square and border. Backboard shall accept time with a 5" x 5" hole pattern and be manufactured in the USA. Backboard shall carry a minimum 10-year limited warranty. Installation to be completed in accordance to manufacturer's instructions. Do not scale drawings. Weigh approximately 100#.



PRODUCT SPECIFICATION

BA495 DURA STEEL™ FAN-SHAPED PLAYGROUND BACKBOARD

REVISED 8/1/17

603 L Street, Lincoln, NE 68508 - Phone: (800) 637-7968 - Fax: (800) 638-0698 - www.ipbybison.com - sales@ipbybison.com