

"Blind Thread" Version:

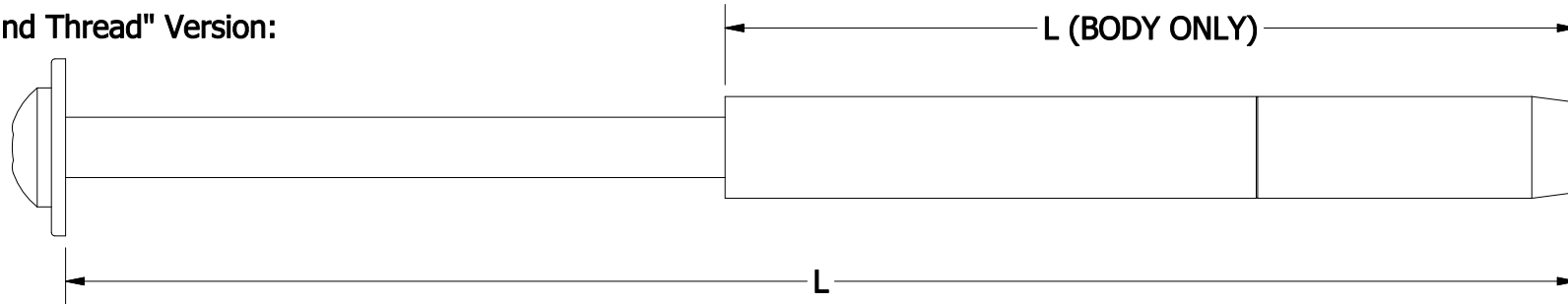

"Complete Threaded" Version:

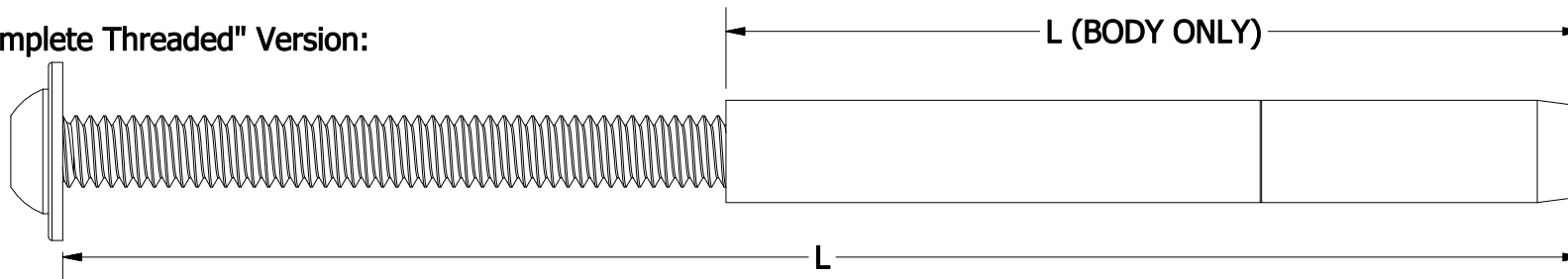

Cat No.	Cable Size	Thread size * see note	Open Length (L)	Closed Length (L)	Description
80-101	1/8"	10-24	3-3/4"	2-5/8"	Complete
80-103	3/16"	1/4" - 20	5-9/16"	4-3/8"	Complete
80-107	1/4"	5/16" - 18	7-1/4"	5-1/4"	Complete
80-54	1/8"	10-24	---	2-1/2"	Body Only
80-56	3/16"	1/4" - 20	---	3"	Body Only
80-66	1/4"	5/16" - 18	---	3-3/16"	Body Only
80-105	3/16"	1/4" - 20	6-1/2"	5-1/2"	Blind Thread

* Please Note Coarse Thread

JOHNSON ARCHITECTUAL REFERENCE DRAWING:

"The Terminator" Turnbuckle

THIS DRAWING IS THE PROPERTY OF C. SHERMAN JOHNSON CO. INC. ANY REPRODUCTION OF THIS DOCUMENT WITHOUT THE EXPRESSED WRITTEN CONSENT OF C. SHERMAN JOHNSON CO. INC. IS STRICTLY PROHIBITED.

DRAWING No.

MATERIAL

MANUFACTURE

BY

DATE

TTT-01

Type 316 Stainless Steel

C. Sherman Johnson Co., Inc.

SBG

7/31/23



EAST HADDAM, CT 06423

TEL 1-800-874-7455

csjohnson.com