

ACCEPTABLE OVERBURDEN  
(CONCRETE SLAB)

KEMPEROL MEMBRANE

ACCEPTABLE ALKALINITY PROTECTION

APPROVED SUBSTRATE PREPARED  
PER KEMPER REQUIREMENTS

KEMPERTEC PRIMER APPLIED  
TO SUBSTRATE

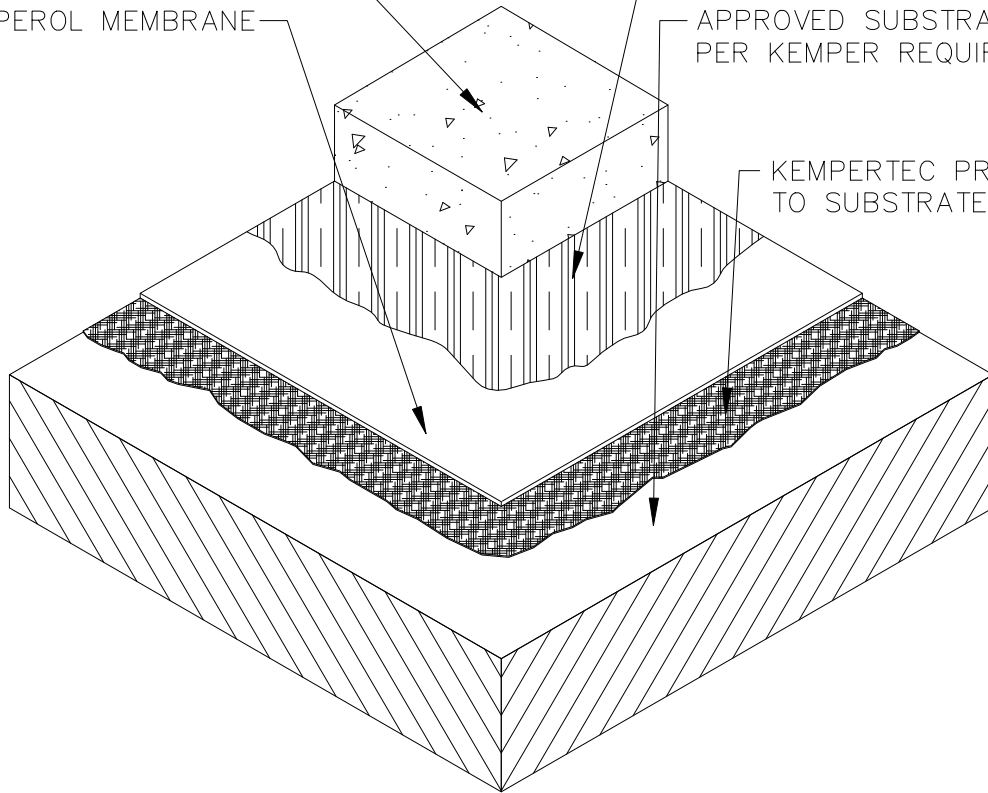

DRAWING NO.

**A-16**

A-16.DWG

## WATERPROOFING ASSEMBLY W/OVERBURDEN

REVISION

10-08-2014

ISSUE DATE

03-01-2011

SCALE

N.T.S.

DRAWN BY

K.S.A.

 **KEMPER**  
SYSTEM