

FIELD REGION

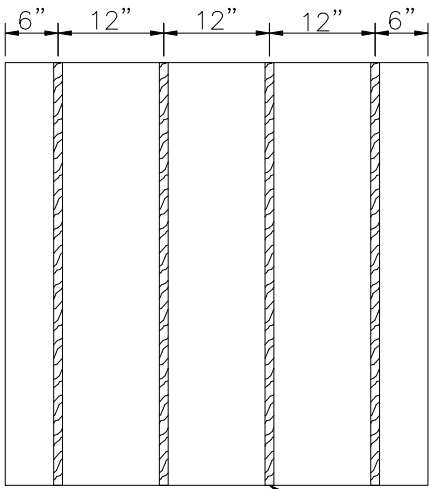

PERIMETER REGION

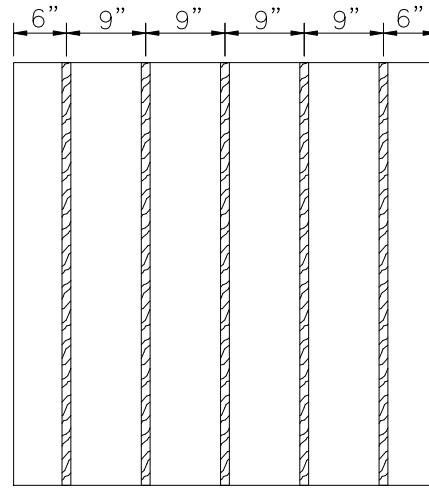

FM-APPROVED 3/4"– 1" WIDE
CONTINUOUS ADHESIVE BEAD
ADHESIVE APPROVED BY
KEMPER TECHNICAL SERVICES

CORNER REGION

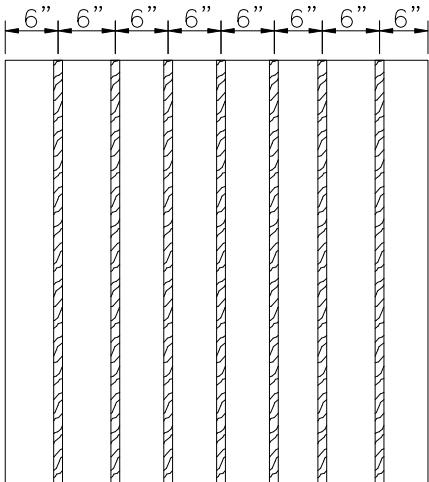

NOTES:

1. THE USE OF THIS 3-ZONE URETHANE ADHESIVE INSULATION ATTACHMENT PATTERN IS MANDATORY FOR ALL APPLICATIONS FOR WHICH AN EXTENDED WIND SPEED WARRANTY IS REQUIRED.
2. ADDITIONAL SECUREMENT IS REQUIRED IN CORNER AND PERIMETER REGIONS, AS IDENTIFIED BY THE DRAWING HW-1, ROOF ZONE LAYOUT.
3. ADDITIONAL SECUREMENT IS PROVIDED BY THE USE OF AN INCREASED DENSITY OF URETHANE ADHESIVE RIBBONS.
4. MAXIMUM BOARD SIZE FOR ADHERED APPLICATIONS IS 4' X 4'.
5. THE USE OF INSULATION BOARDS AND COVER BOARDS APPROVED IN WRITING BY KEMPER SYSTEM, INC. TECHNICAL SERVICES DEPARTMENT IS REQUIRED.
6. SUBSTRATE TYPE MUST BE COMPATIBLE WITH URETHANE ADHESIVE AND APPROVED BY KEMPER SYSTEM, INC. TECHNICAL SERVICES DEPARTMENT
7. 100 FT. HEIGHT LIMITATION UNLESS APPROVED IN WRITING BY KEMPER SYSTEM, INC. TECHNICAL SERVICES DEPARTMENT.

4'
BOARD
SIZE 4'