

CONDITION #1: (TYPICAL)
METAL EDGE AT ROOF EDGE

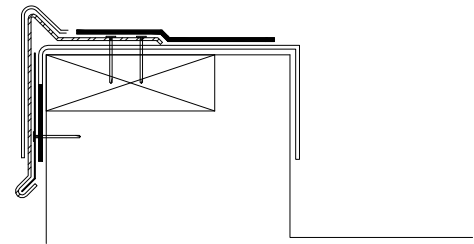

CONDITION #2: (TYPICAL)
METAL EDGE AT PARAPET
WALL EDGE

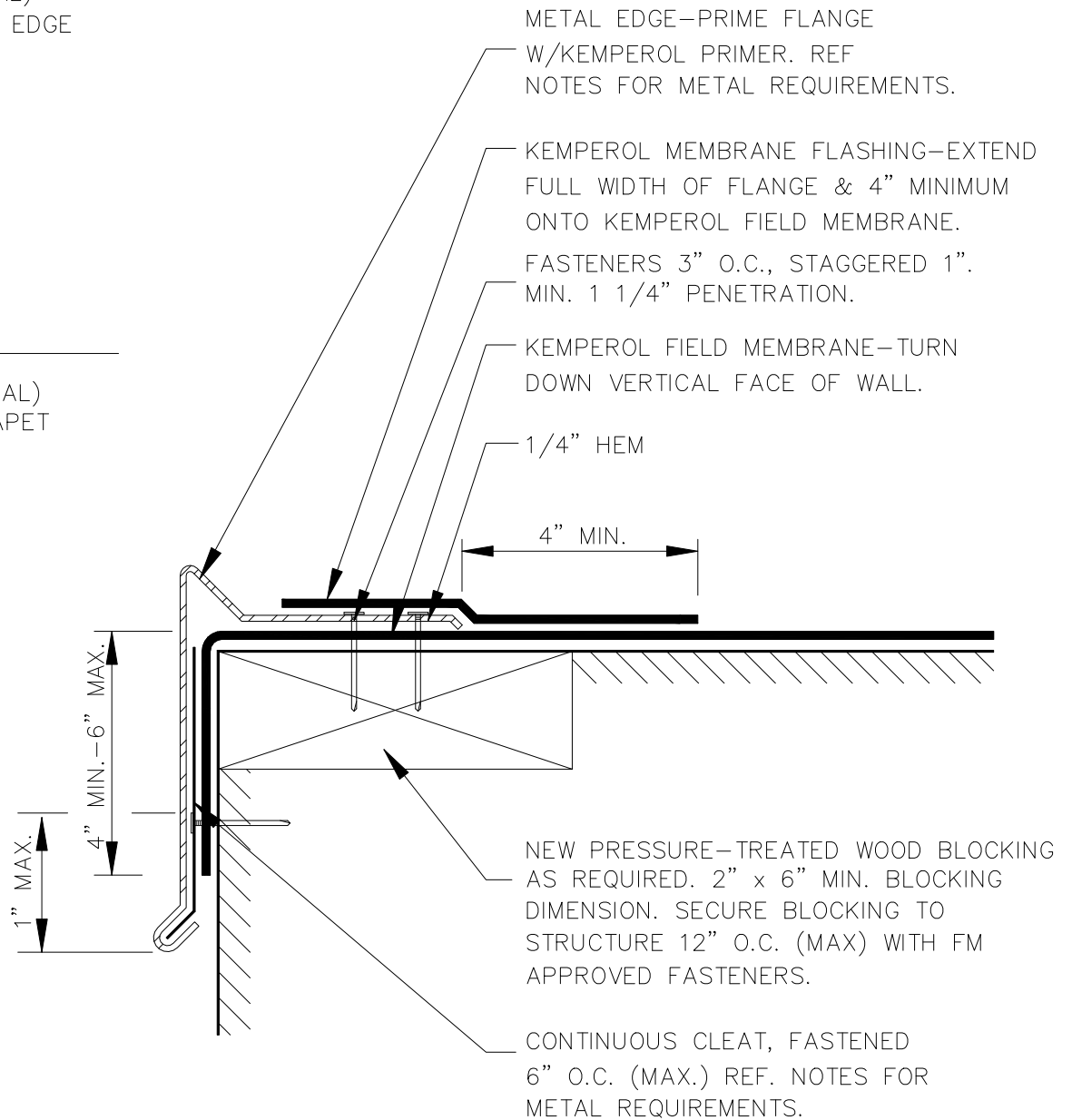

NOTES:

1. THE USE OF THIS METAL EDGE SECUREMENT IS MANDATORY FOR ALL APPLICATIONS FOR WHICH AN EXTENDED WIND SPEED WARRANTY IS REQUIRED.
2. THE USE OF COMMERCIALY AVAILABLE METAL EDGE SYSTEMS RATED FOR HIGH WIND APPLICATIONS MUST BE APPROVED IN WRITING BY KEMPER SYSTEM, INC. TECHNICAL SERVICES DEPARTMENT.
3. MECHANICAL FASTENER TYPE AND PENETRATION DEPTH INTO THE SUBSTRATE MUST MEET FACTORY MUTUAL REQUIREMENTS.
4. MECHANICAL FASTENERS MUST BE SECURED INTO STRUCTURAL CONCRETE, SOLID MASONRY, OR PRESSURE-TREATED WOOD BLOCKING.
5. MINIMUM METAL GAUGES ARE: 20GA. STEEL, .060" ALUMINUM, AND 24 OZ COPPER.
6. 100 FT. HEIGHT LIMITATION UNLESS APPROVED IN WRITING BY KEMPER SYSTEM, INC. TECHNICAL SERVICES DEPARTMENT.