

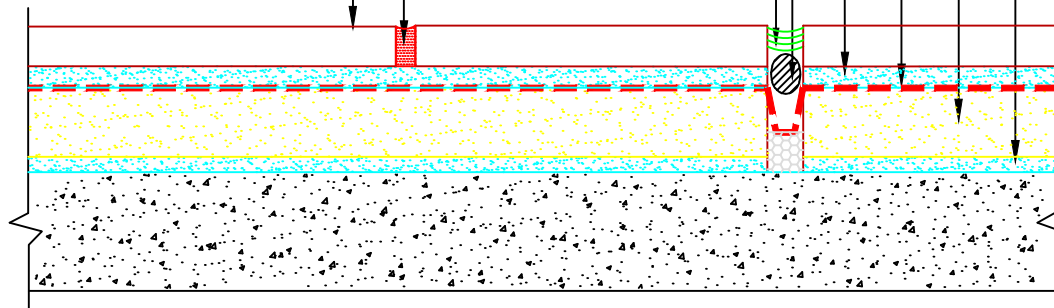

Drawing No. ES EJ10

- Slurry Bond Coat\*
- 3701 Fortified Mortar
- HYDRO BAN® with Waterproofing/Anti-Fracture Fabric
- Tile Installation Mortar\*
- Backer Rod and Compressible Filler
- LATASIL™
- SPECTRALOCK® PRO Premium Grout;  
or, PERMACOLOR® Select
- Ceramic Tile or Stone



\*Slurry bond coat, and tile installation mortar to be either 257 TITANIUM, 254 Platinum, or MULTIMAX LITE.

Revision Date: 2/20 Scale: N.T.S.

AS A PROFESSIONAL COURTESY, LATICRETE OFFERS TECHNICAL SERVICES FREE OF CHARGE. THE USER MAINTAINS ALL RESPONSIBILITY FOR VERIFYING THE APPLICABILITY AND SUITABILITY OF THE TECHNICAL SERVICE OR INFORMATION PROVIDED.

(C)2020 LATICRETE INTERNATIONAL, INC. ALL RIGHTS RESERVED. THE RIGHT TO UTILIZE LATICRETE DETAILS FOR COMMERCIAL PURPOSES IS GRANTED EXCLUSIVELY TO CONTRACTORS, ARCHITECTS, QUANTITY SURVEYORS, ENGINEERS, AND SPECIFICATIONS WRITERS. ALL TRADEMARKS SHOWN ARE THE INTELLECTUAL PROPERTY OF THEIR RESPECTIVE OWNERS.