



# Drawing No. ES F105

Width of deck and maximum joist spacing to be specified by architect or design team.

Structural Ribbed Self-Supporting Boards

Portland Cement Mortar Fill

HYDRO BAN<sup>®</sup> XP

Tile Installation Mortar\*

PERMACOLOR<sup>®</sup> Select Grout

Ceramic Tile

Flashing over Tile Base

LATASIL<sup>™</sup> w/backer rod

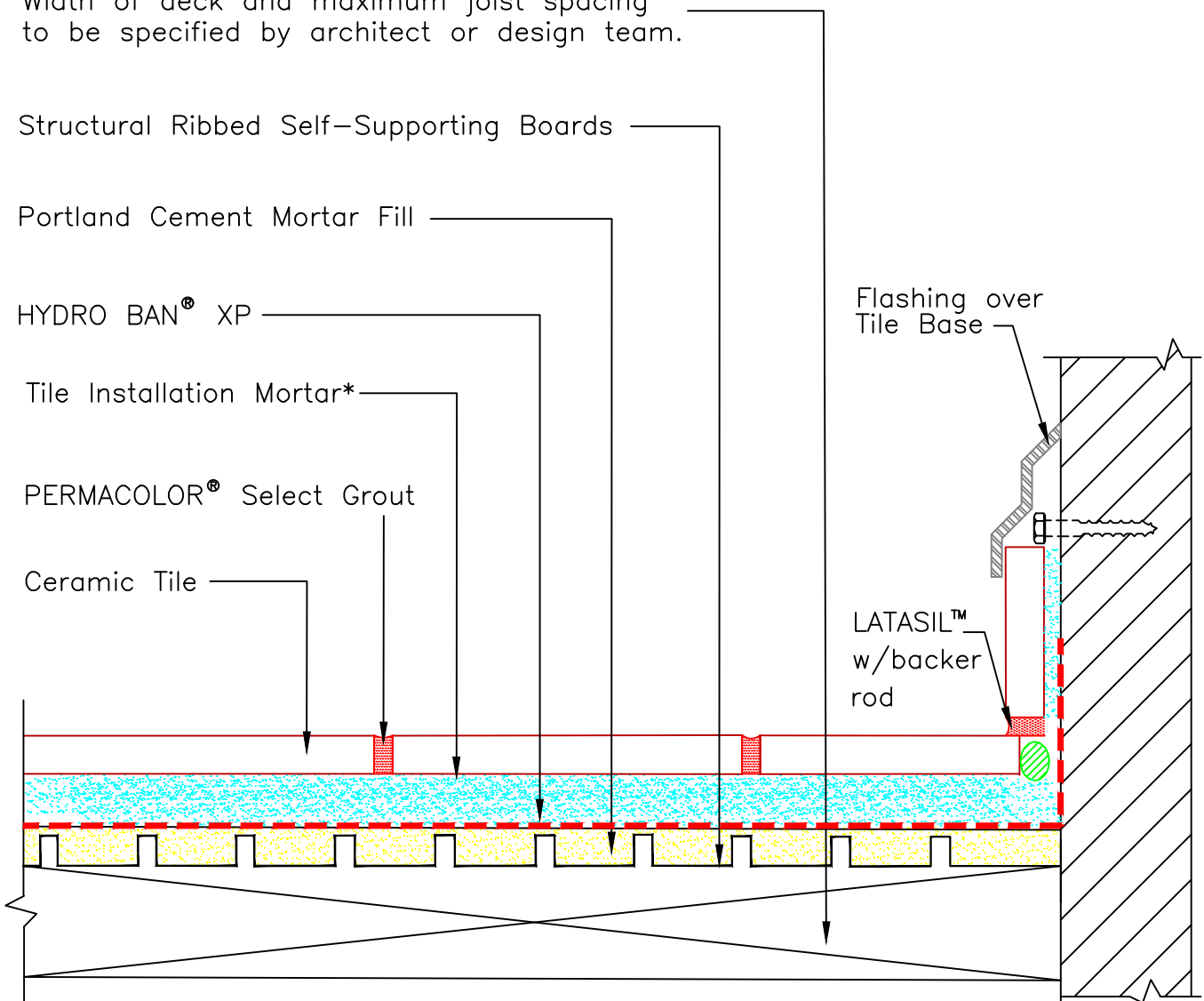

\* Tile installation mortar to be either 254 Platinum, 257 TITANIUM<sup>™</sup> or MULTIMAX<sup>™</sup> LITE.

NOTE: This method is not for use over living space.

Revision Date: 11/21

Scale: N.T.S.

AS A PROFESSIONAL COURTESY, LATICRETE OFFERS TECHNICAL SERVICES FREE OF CHARGE. THE USER MAINTAINS ALL RESPONSIBILITY FOR VERIFYING THE APPLICABILITY AND SUITABILITY OF THE TECHNICAL SERVICE OR INFORMATION PROVIDED.

(C)2021 LATICRETE INTERNATIONAL, INC. ALL RIGHTS RESERVED. THE RIGHT TO UTILIZE LATICRETE DETAILS FOR COMMERCIAL PURPOSES IS GRANTED EXCLUSIVELY TO CONTRACTORS, ARCHITECTS, QUANTITY SURVEYORS, ENGINEERS, AND SPECIFICATIONS WRITERS. ALL TRADEMARKS SHOWN ARE THE INTELLECTUAL PROPERTY OF THEIR RESPECTIVE OWNERS.