

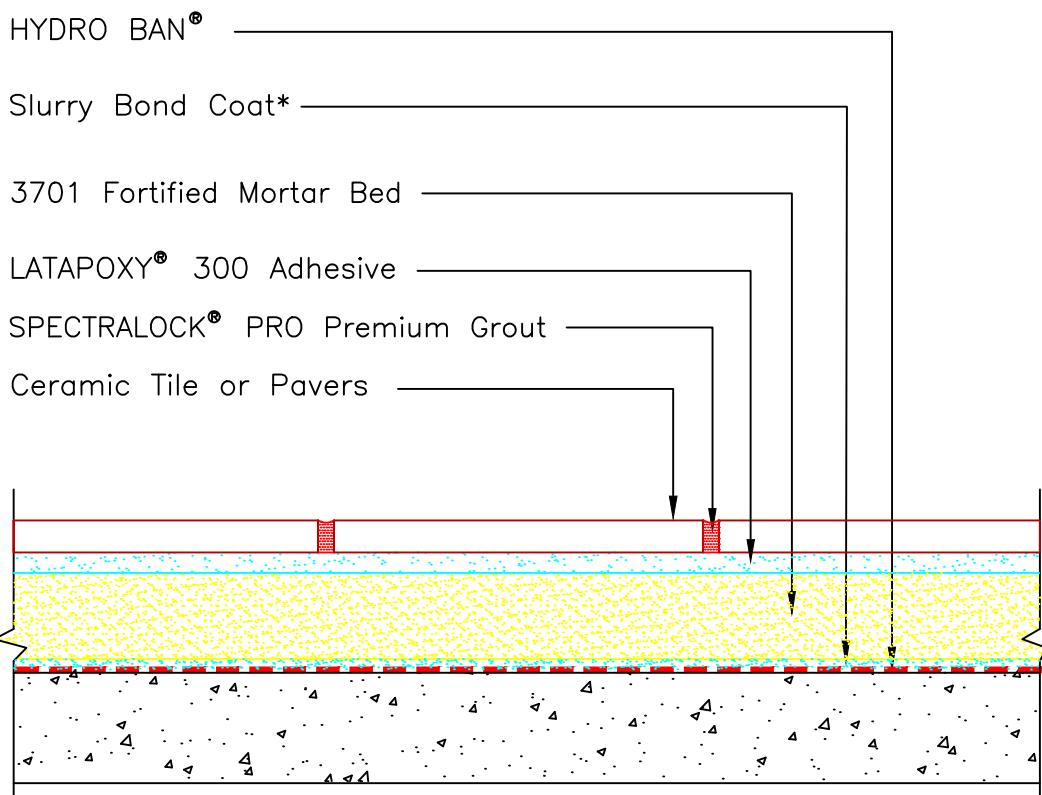

Drawing No. ES F132  
(not for industrial or commercial  
kitchen applications)



\*Slurry Bond Coat to be either 257 TITANIUM, 254 Platinum,  
or MULTIMAX LITE.

Revision Date: 2/20 Scale: N.T.S.

AS A PROFESSIONAL COURTESY, LATICRETE OFFERS  
TECHNICAL SERVICES FREE OF CHARGE. THE USER  
MAINTAINS ALL RESPONSIBILITY FOR VERIFYING THE  
APPLICABILITY AND SUITABILITY OF THE TECHNICAL  
SERVICE OR INFORMATION PROVIDED.

(C)2020 LATICRETE INTERNATIONAL, INC. ALL RIGHTS RESERVED. THE RIGHT TO UTILIZE  
LATICRETE DETAILS FOR COMMERCIAL PURPOSES IS GRANTED EXCLUSIVELY TO CONTRACTORS,  
ARCHITECTS, QUANTITY SURVEYORS, ENGINEERS, AND SPECIFICATIONS WRITERS. ALL  
TRADEMARKS SHOWN ARE THE INTELLECTUAL PROPERTIES OF THEIR RESPECTIVE OWNERS.