



Drawing No. ES-P602

HYDRO BAN[®] Cementitious Waterproofing

3701 Fortified Mortar

Tile Installation Mortar*

SPECTRALOCK[®] PRO Premium Grout; or,
PERMACOLOR[®] Select

Ceramic, Glass or Stone Tile

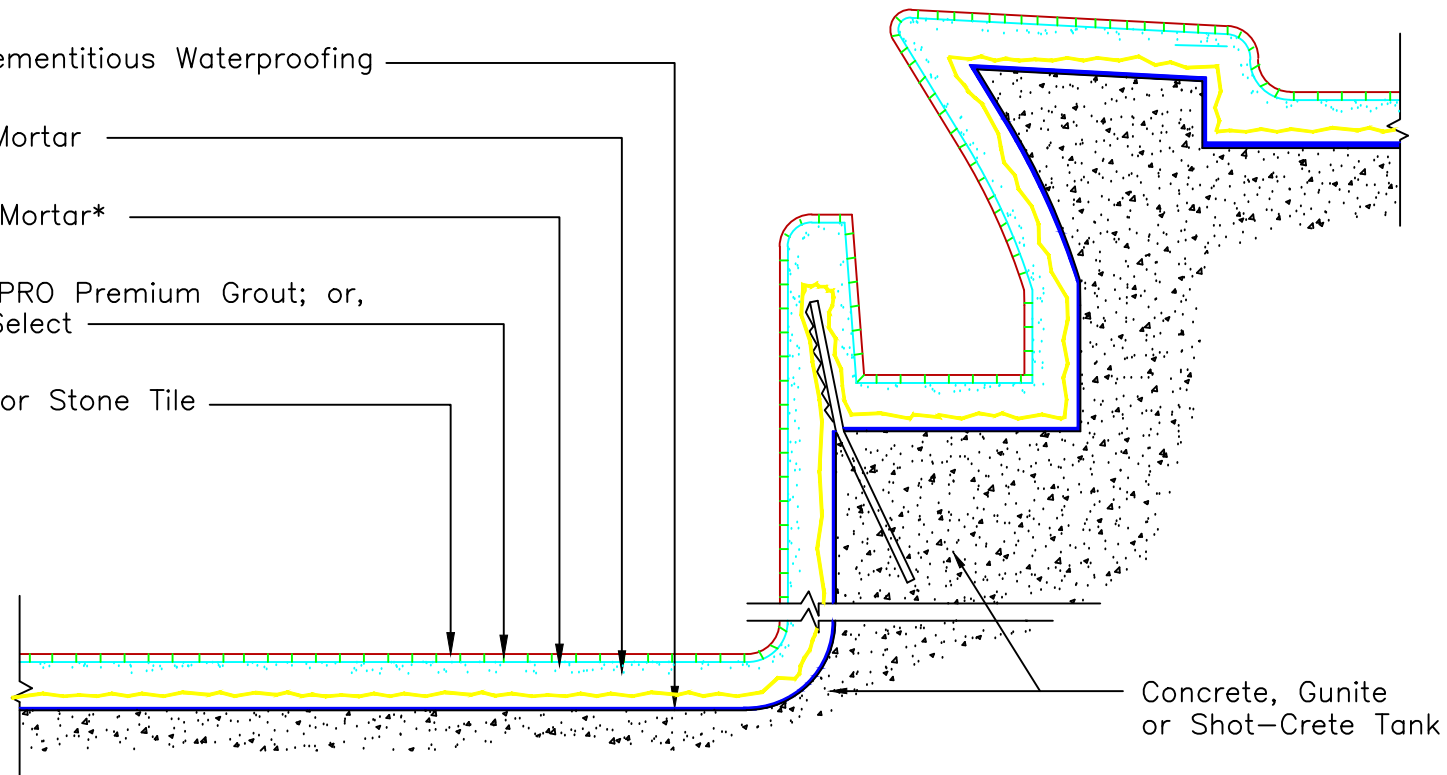

Concrete, Gunite
or Shot-Crete Tank

NOTE: Slurry Bond Coat of Tile Installation Mortar is required under the mortar bed at all horizontal surfaces.

*Tile Installation Mortar to be either 257 TITANIUM, 254 Platinum, or MULTIMAX LITE.

Revision Date: 2/20

Scale: N.T.S.

AS A PROFESSIONAL COURTESY, LATICRETE OFFERS TECHNICAL SERVICES FREE OF CHARGE. THE USER MAINTAINS ALL RESPONSIBILITY FOR VERIFYING THE APPLICABILITY AND SUITABILITY OF THE TECHNICAL SERVICE OR INFORMATION PROVIDED.

(C)2020 LATICRETE INTERNATIONAL, INC. ALL RIGHTS RESERVED. THE RIGHT TO UTILIZE LATICRETE DETAILS FOR COMMERCIAL PURPOSES IS GRANTED EXCLUSIVELY TO CONTRACTORS, ARCHITECTS, QUANTITY SURVEYORS, ENGINEERS, AND SPECIFICATIONS WRITERS. ALL TRADEMARKS SHOWN ARE THE INTELLECTUAL PROPERTIES OF THEIR RESPECTIVE OWNERS.