

ES P601 Concrete Swimming Pool Tank

LATICRETE® 226 Thick Bed Mortar mixed with
LATICRETE 3701 Mortar Admix

LATICRETE 9235 Waterproofing Membrane

LATICRETE 254 Platinum

LATICRETE SpectraLOCK® PRO Grout;
or LATICRETE 1500 Sanded Grout
or 1600 Unsanded Grout mixed with
LATICRETE 1776 Grout Enhancer

Ceramic Tile or Stone

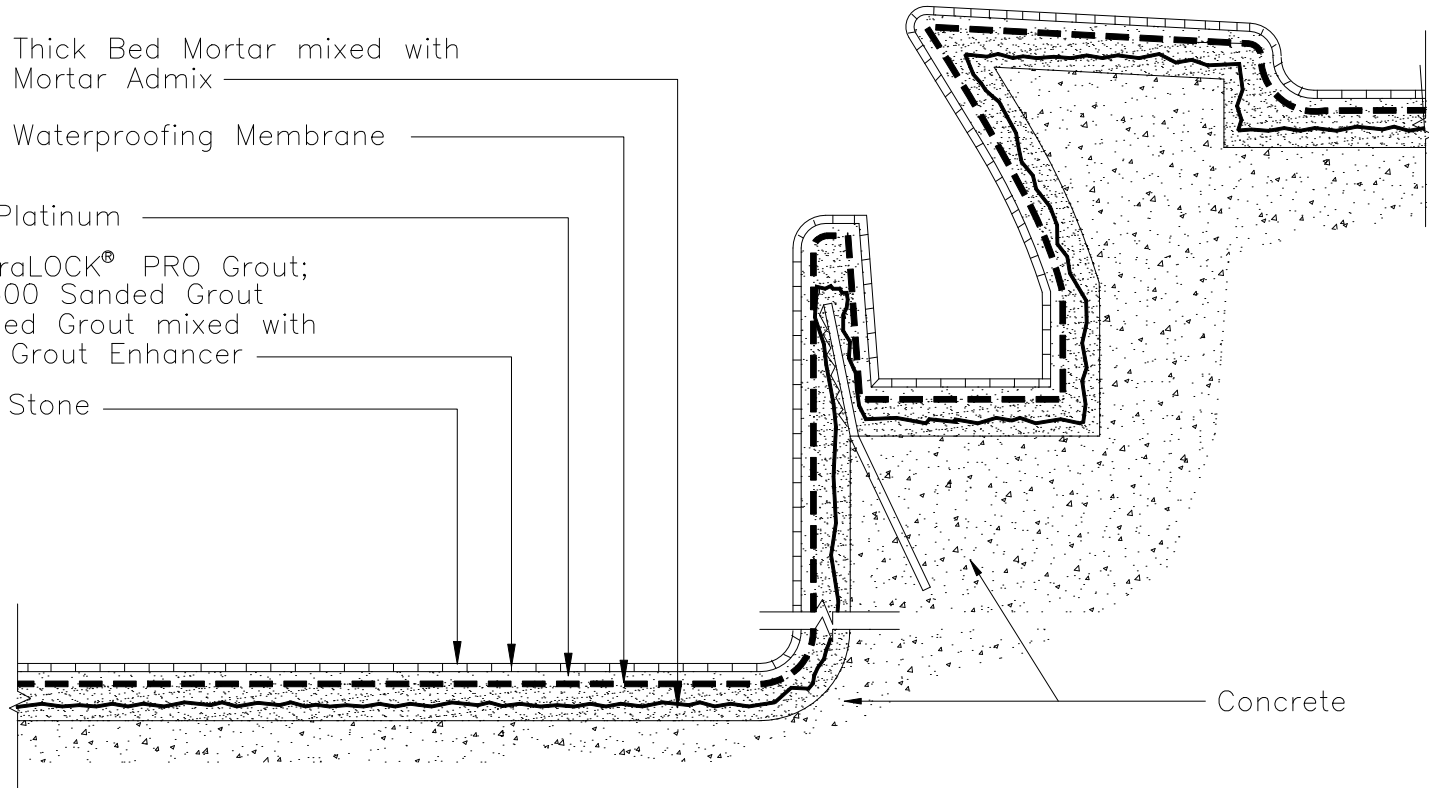

Note:
Slurry Bond Coat of LATICRETE 254 Platinum is required
under the mortar bed at all horizontal surfaces.

Revision Date: 5/08 Scale: N.T.S.

AS A PROFESSIONAL COURTESY, LATICRETE OFFERS
TECHNICAL SERVICES FREE OF CHARGE. THE USER
MAINTAINS ALL RESPONSIBILITY FOR VERIFYING THE
APPLICABILITY AND SUITABILITY OF THE TECHNICAL
SERVICE OR INFORMATION PROVIDED.

(C)2008 LATICRETE INTERNATIONAL, INC. ALL RIGHTS RESERVED. THE RIGHT TO UTILIZE
LATICRETE DETAILS FOR COMMERCIAL PURPOSES IS GRANTED EXCLUSIVELY TO CONTRACTORS,
ARCHITECTS, QUANTITY SURVEYORS, ENGINEERS, AND SPECIFICATIONS WRITERS. LATICRETE (R),
LATAPOXY (R) ARE REGISTERED TRADEMARKS OF LATICRETE INTERNATIONAL, INC. US &
FOREIGN PATENT AND TRADEMARK OFFICES. MARCA REGISTRADA. ALL OTHER TRADEMARKS ARE
PROPERTY OF THEIR RESPECTIVE COMPANIES.