

# BATHTUB / SHOWER WALLS

Bathtub or Shower with Prefabricated Receptor  
Cement Backer Board or Fiber-Cement Backer Board  
Ceramic Tile

MAPEI: MB412  
TCNA: B412-16  
TTMAC: N/A  
Version 2016

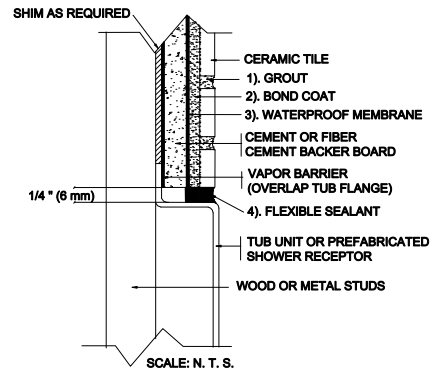

## MAPEI Products Assembly

### 1. Grout Options:

- |    |                                       |                  |
|----|---------------------------------------|------------------|
| A. | <i>Ultracolor<sup>®</sup> Plus</i>    | ISO 13007 CG2WAF |
| B. | <i>Keracolor<sup>™</sup> U</i>        | ISO 13007 CG2WA  |
| C. | <i>Kerapoxy<sup>®</sup></i>           | ISO 13007 RG     |
| D. | <i>Kerapoxy CQ</i>                    | ISO 13007 RG     |
| E. | <i>MAPEI Flexcolor<sup>™</sup> CQ</i> |                  |

### 2. Bond Coat Options:

- |    |                                                               |                    |
|----|---------------------------------------------------------------|--------------------|
| A. | <i>Kerabond<sup>™</sup> T / Keralastic<sup>™</sup> System</i> | ISO 13007 C2ES2P2  |
| B. | <i>Kerabond / Keralastic<sup>™</sup> System</i>               | ISO 13007 C2ES2P2  |
| C. | <i>Granirapid<sup>®</sup> System</i>                          | ISO 13007 C2FS2P2  |
| D. | <i>MAPEI Ultralite<sup>™</sup> Mortar</i>                     | ISO 13007 C2TES1P1 |
| E. | <i>Ultraflex<sup>™</sup> 3</i>                                | ISO 13007 C2ES1P1  |
| F. | <i>Kerapoxy 410</i>                                           | ISO 13007 R2       |