

# INTERIOR FLOORS OVER WOOD

Joist 24" (600 mm) o.c. / Plywood Subfloor  
 Plywood Underlayment  
 Uncoupled Membrane  
 Ceramic Tile

MAPEI: MF147  
 TCNA: F147-16  
 TTMAC: 313F-D  
 Version: 2016

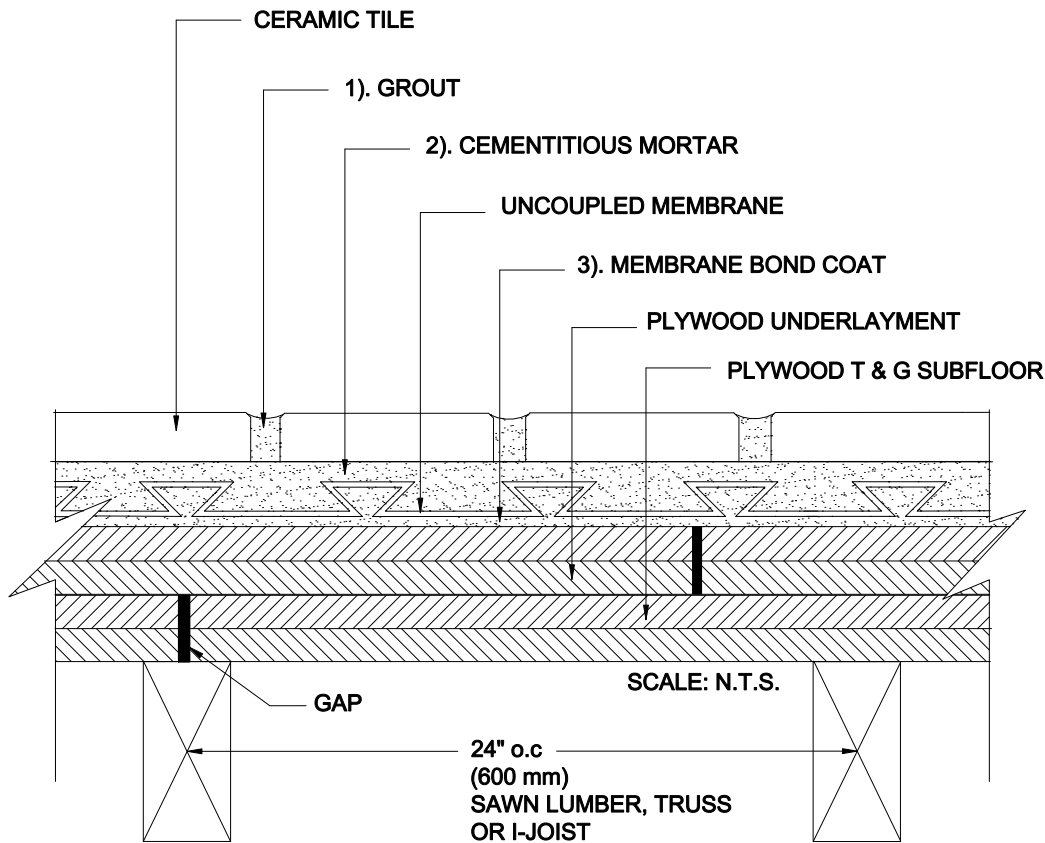

## MAPEI Products Assembly

1. Grout Options:
 

A. Ultracolor <sup>®</sup> Plus	ISO 13007 CG2WAF
B. Keracolor <sup>™</sup> U	ISO 13007 CG2WA
C. Kerapoxy <sup>®</sup> , Kerapoxy CQ	ISO 13007 RG
D. MAPEI Flexcolor <sup>™</sup> CQ	
2. Cementitious Mortar:
  - A. Refer to manufacturer of uncoupled membrane for recommendation based on ANSI Standards.
3. Membrane Bond Coat:
  - A. Refer to manufacturer of uncoupled membrane for recommendation based on ANSI Standards.