

# INTERIOR FLOORS OVER WOOD

Joist 24" (600 mm) o.c. / Plywood Subfloor

Plywood Underlayment

Ceramic Tile

MAPEI: MF149

TCNA: F149-16

TTMAC: 313F-A

Version: 2016

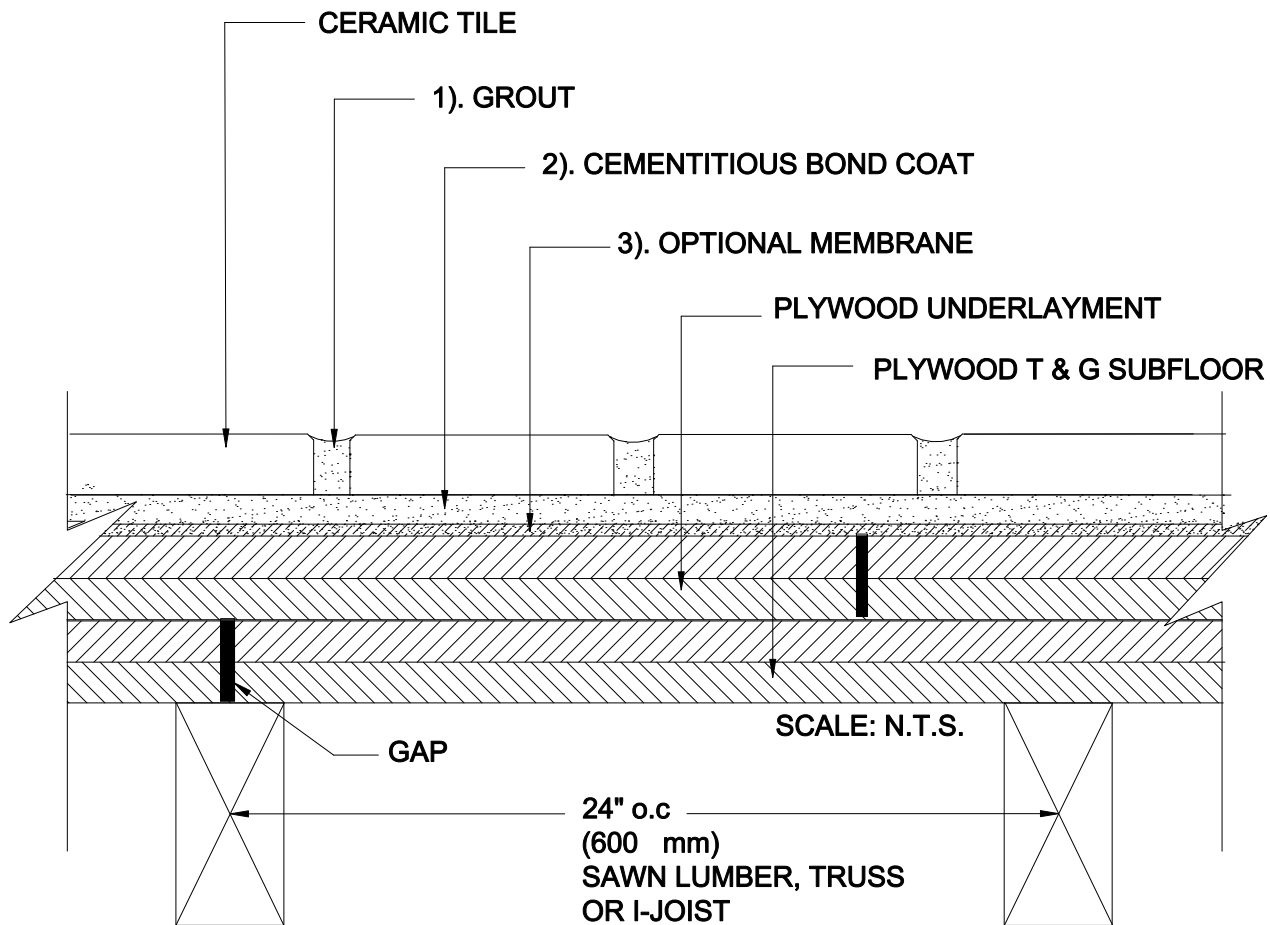

## MAPEI Products Assembly

### 1. Grout Optional:

A.	Ultrasol <sup>®</sup> Plus	ISO 13007 CG2WAF
B.	Keracolor <sup>™</sup> U	ISO 13007 CG2WA
C.	Kerapoxy <sup>®</sup> , Kerapoxy CO	ISO 13007 RG
D.	MAPEI Flexcolor <sup>™</sup> CO	

### 2. Cementitious Bond Coat Optional:

A.	Kerbond/Kerastatic <sup>™</sup> System	ISO 13007 CG252P2
B.	Kerbond <sup>™</sup> T / Kerastatic <sup>™</sup> System	ISO 13007 CG252P2
C.	Granipid <sup>®</sup> System	ISO 13007 CG252P2

### 3. Optional Membrane Optional:

A.	(Crack Isolation) Megalastic <sup>™</sup> CI
B.	(Waterproofing / Crack Isolation) Megalastic AquaDefense
C.	(Waterproofing / Crack Isolation) Megalastic 315
D.	(Crack Isolation / Sound Control) Mepeguard <sup>™</sup> 2 Requires MAPEI SM Primer <sup>™</sup>