

INTERIOR FLOORS OVER WOOD

Joists 24" (609 mm) o.c. / Plywood Subfloor
 Coated Glass Mat Water-Resistant Gypsum Backer Board
 Ceramic Tile

MAPEI: MF151
 TCNA: F151-16
 TTMAC: N/A
 Version: 2016

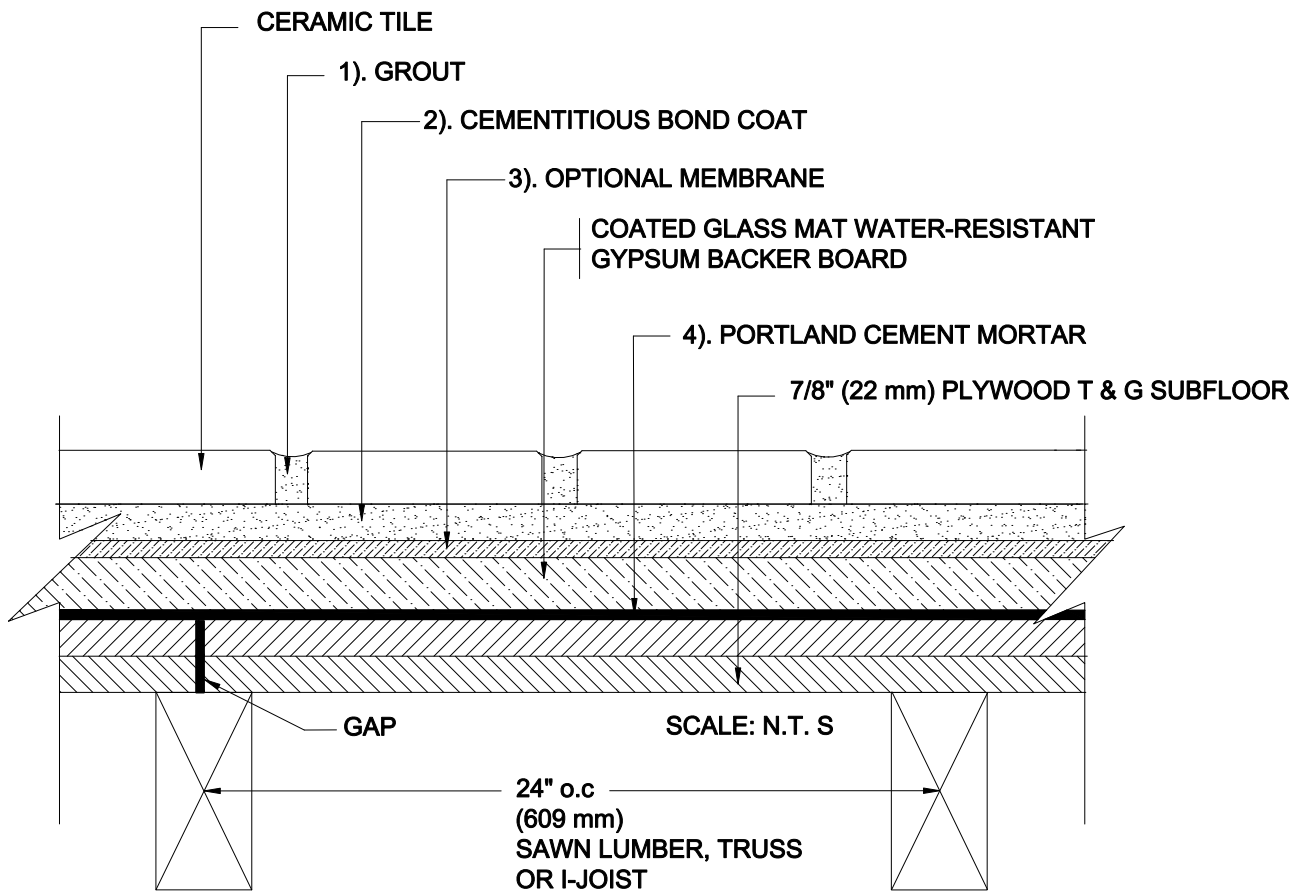

MAPEI Products Assembly

1. Grout Options:

A.	Ultrasol® Plus	ISO 13007 CG2WAF
B.	Kenscolor™ U	ISO 13007 CG2WA
C.	Kenscolor®, or Kenscolor CD	ISO 13007 RG
D.	MAPEI Flexcolor™ CD	

2. Cementitious Bond Coat Options:

A.	Kensbond/Kenslastic™ System	ISO 13007 C2G53P2
B.	Kensbond™ T / Kenslastic™ System	ISO 13007 C2G53P2
C.	Granispid® System	ISO 13007 C2F53P2
D.	Ultraflex™ LFT™	ISO 13007 C2TF51P1
E.	Ultraflex LFT Rapid	ISO 13007 C2TF51P1
F.	Ultraflex J	ISO 13007 C2G51P1

3. Optional Membrane Options:

- A. Waterproofing / Crack Isolation:
 - 1. Mapelastic™ AquaDefense
 - 2. Mapelastic 315
- B. Crack Isolation / Sound Control (sheet membrane)
 - 1. Mapeguard™ 2
 - a. MAPEI SM Primer™

4.

- A. Crack Isolation
 - 1. Mapelastic CI

5. Portland Cement Mortar:

A.	Kensbond	ISO 13007 C1
B.	Kensbond T	ISO 13007 C1T