

INTERIOR FLOORS OVER WOOD

Joist 24" (609 mm) o.c. / Plywood Subfloor
 Exterior Glue / Laminated Wood Panel (EG/LWP) Underlayment
 Ceramic Tile

MAPEI: MF160
 TCNA: F160-16
 TTMAC: N/A
 Version: 2016

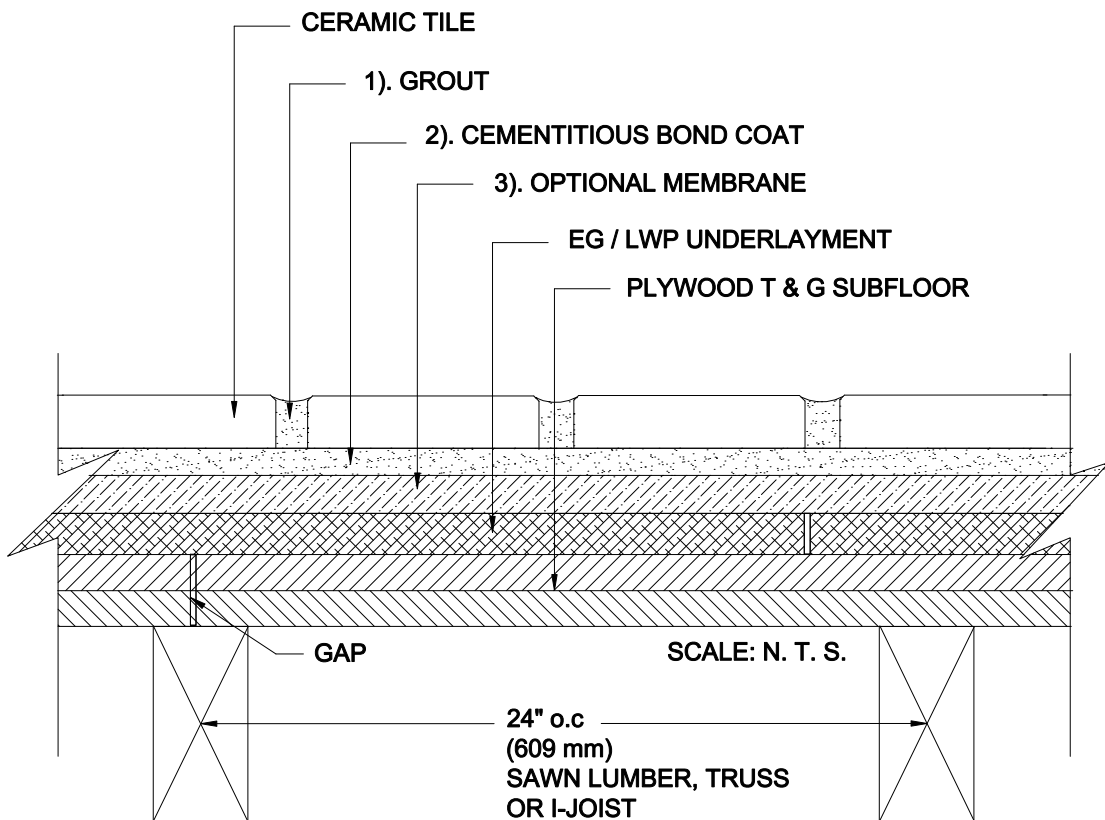

MAPEI Products Assembly

1. Grout Options:

A. Ultracolor [®] Plus	ISO 13007 CG2WAF
B. Keracolor [™] U	ISO 13007 CG2WA
C. Kerapoxy [®] , Kerapoxy CQ	ISO 13007 RG
D. MAPEI Flexcolor [™] CQ	

2. Cementitious Bond Coat Options:

A. Kerabond/Keralastic [™] System	ISO 13007 C2ES2P2
B. Kerabond [™] T / Keralastic [™] System	ISO 13007 C2ES2P2
C. Gran/rapid [®] System	ISO 13007 C2FS2P2
D. Ultraflex [™] LFT [™]	ISO 13007 C2TES1P1
E. Ultraflex LFT Rapid	ISO 13007 C2TFS1P1
F. Ultraflex 3	ISO 13007 C2ES1P1

3. Optional Membrane Options:

A. Waterproofing / Crack Isolation	
1. Mapelastic [™] AquaDefense	
2. Mapelastic 315	
B. Crack Isolation	
1. Mapelastic CI	
C. Crack Isolation / Sound Control (sheet membrane)	
1. Mapeguard [™] 2	
a. MAPEI S/M Primer [™]	