

STAIRS

Concrete, Ceramic Tile

MAPEI: MS151-Concrete

TCNA: S151-Concrete

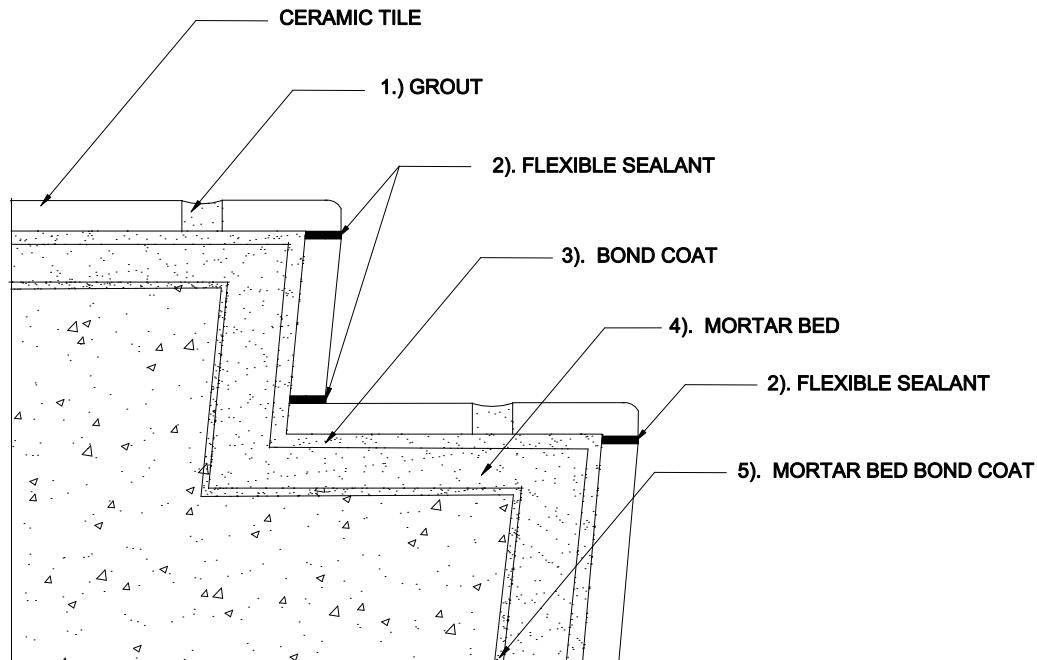

MAPEI Products Assembly

1. Grout Options:

- | | |
|------------------------|------------------|
| A. Kerapoxy® | ISO 13007 RG |
| B. Kerapoxy CQ | ISO 13007 RG |
| C. Ultracolor® Plus | ISO 13007 CG2WAF |
| D. Keracolor™ U | ISO 13007 CG2WA |
| E. MAPEI Flexcolor™ CQ | |

2. Flexible Sealant:

- A. Mapesil

3. Cementitious Bond Coat Options:

- | | |
|-----------------------------------|--------------------|
| A. Kerabond™ T/Keralastic™ System | ISO 13007 C2ES2P2 |
| B. Kerabond/Keralastic™ System | ISO 13007 C2ES2P2 |
| C. Granirapid® System | ISO 13007 C2FS2P2 |
| D. Ultraflex™ LFT™ | ISO 13007 C2TES1P1 |
| E. Ultraflex LFT Rapid | ISO 13007 C2TFS1P1 |

4. Mortar Bed:

- A. Modified Mortar Bed

5. Mortar Bed Bond Coat:

- A. Modified Mortar Bed