

# INTERIOR WALLS OVER MASONRY OR CONCRETE

Masonry or Concrete  
Ceramic Tile

MAPEI: MW202I  
TCNA: W202I-16  
TTMAC: 303-W  
Version: 2016

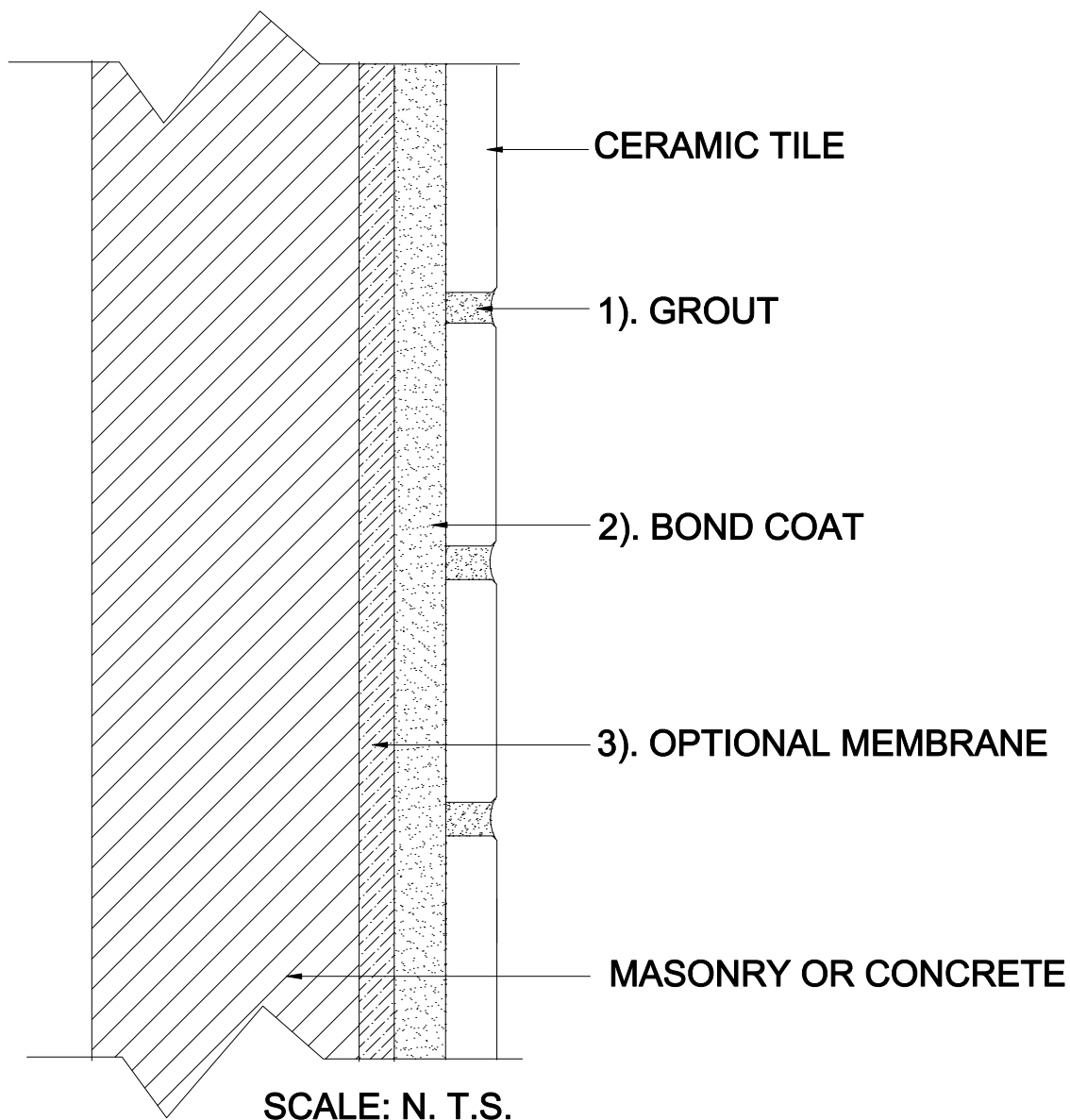

## MAPEI Products Assembly

### 1. Grout Options:

- |    |   |                  |
|----|---|------------------|
| A. | <i>Kerapoxy<sup>®</sup></i> or <i>Kerapoxy CQ</i> | ISO 13007 RG     |
| B. | <i>Ultracolor<sup>®</sup> Plus</i>                | ISO 13007 CG2WAF |
| C. | <i>Keracolor<sup>™</sup> U</i>                    | ISO 13007 CG2WA  |
| D. | <i>MAPEI Flexcolor<sup>™</sup> CQ</i>             |                  |

### 2. Bond Coat Options:

- |    |   |                    |
|----|---|--------------------|
| A. | <i>Kerabond<sup>™</sup> T / Keralastic<sup>™</sup> System</i> | ISO 13007 C2ES2P2  |
| B. | <i>Kerabond/Keralastic<sup>™</sup> System</i>                 | ISO 13007 C2ES2P2  |
| C. | <i>Granirapid<sup>®</sup> System</i>                          | ISO 13007 C2FS2P2  |
| D. | <i>Ultraflex<sup>™</sup> LFT<sup>™</sup></i>                  | ISO 13007 C2TES1P1 |
| E. | <i>Ultraflex LFT Rapid</i>                                    | ISO 13007 C2TFS1P1 |
| F. | <i>Ultraflex 3</i>  | ISO 13007 C2ES1P1  |
| G. | <i>Kerapoxy<sup>®</sup> 410</i>                               | ISO 13007 ISO R2   |

### 3. Optional Membrane:

- |    |   |  |
|----|---|--|
| A. | <i>Mapelastic<sup>™</sup> AquaDefense</i><br>(for use with Cementitious Bond Coat only) |  |
|----|---|--|