

INTERIOR WALLS OVER SOLID BACKING

Mortar Bed (One-Coat Method)

Ceramic Tile

MAPEI: MW222

TCNA: W222-16

TTMAC: N/A

Version: 2016

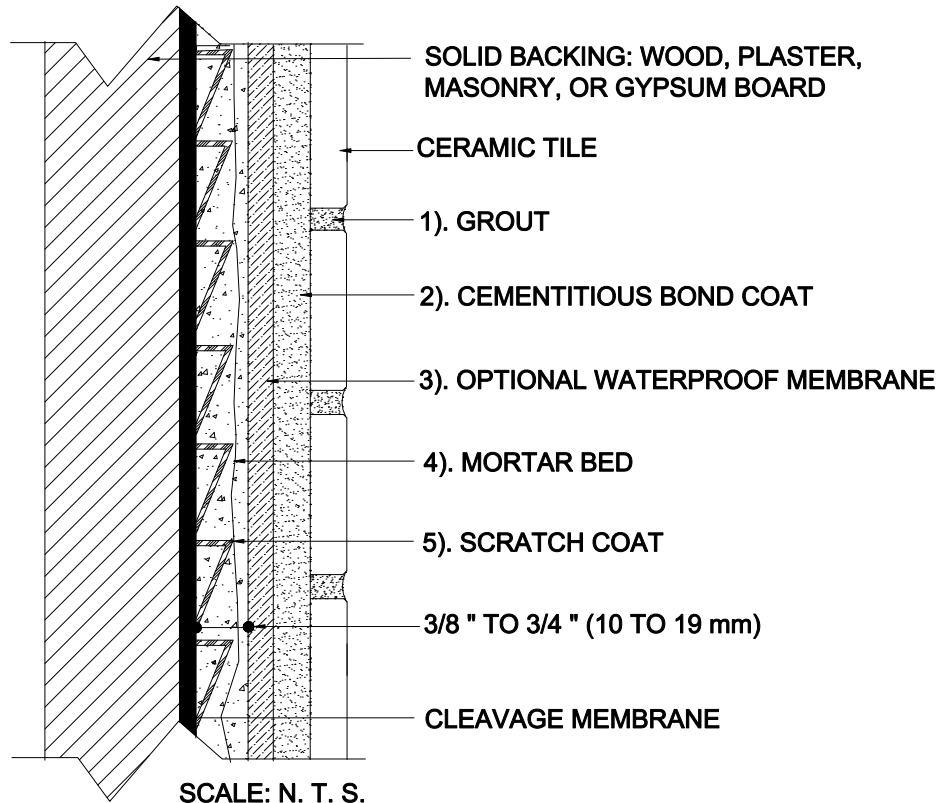

MAPEI Products Assembly

1. **Grout Options:**
 - A. *Ultracolor[®] Plus* ISO 13007 CG2WAF
 - B. *Keracolor[™] U* ISO 13007 CG2WA
 - C. *Kerapoxy[®] or Kerapoxy CQ* ISO 13007 RG
 - D. *MAPEI Flexcolor[™] CQ*
2. **Cementitious Bond Coat Options:**
 - A. *Kerabond[™] T / Keralastic[™] System* ISO 13007 C2ES2P2
 - B. *Kerabond/Keralastic[™] System* ISO 13007 C2ES2P2
 - C. *Granirapid[®] System* ISO 13007 C2FS2P2
 - D. *Ultraflex[™] LFT[™]* ISO 13007 C2TES1P1
 - E. *Ultraflex LFT Rapid* ISO 13007 C2TFS1P1
 - F. *Ultraflex 3* ISO 13007 C2ES1P1
3. **Optional Waterproofing Membrane Options:**
 - A. *Mapelastic[™] AquaDefense*
 - B. *Mapelastic 315*
4. **Mortar Bed:**
 - A. *Modified Mortar Bed*
5. **Scratch Coat:**
 - A. *Modified Mortar Bed*