

# INTERIOR WALLS OVER WOOD OR METAL STUDS

Wood or Metal Studs  
Glass Mat Water-Resistant Gypsum Backer Board  
Ceramic Tile

MAPEI MW248  
TCNA: W248-16  
TTMAC: N/A  
Version: 2016

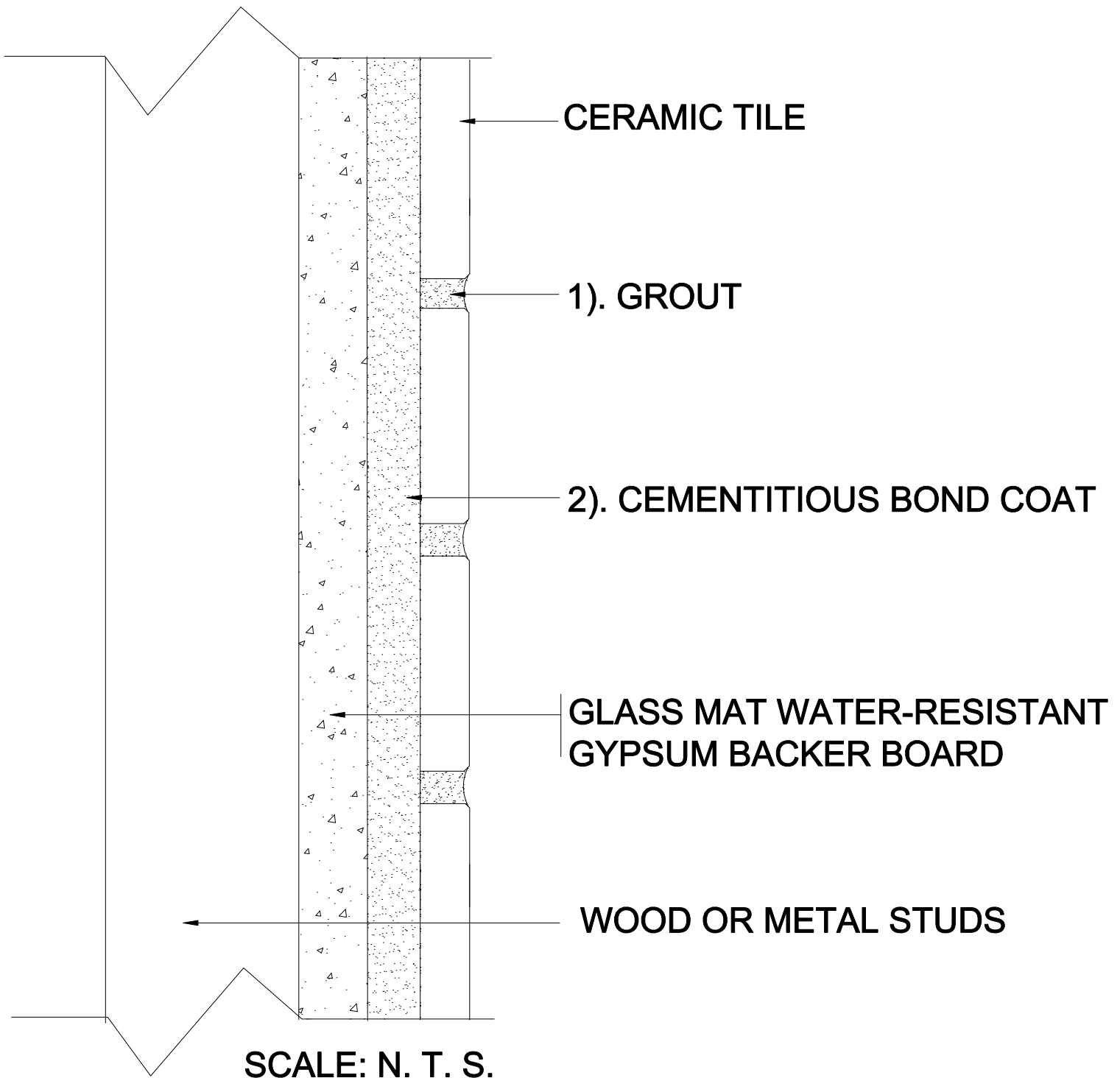

## MAPEI Products Assembly

### 1. Grout Options:

- |  |                  |
|--|------------------|
| A. <i>Ultracolor<sup>®</sup> Plus</i>                  | ISO 13007 CG2WAF |
| B. <i>Keracolor<sup>™</sup> U</i>                      | ISO 13007 CG2WA  |
| C. <i>Kerapoxy<sup>®</sup></i> , or <i>Kerapoxy CQ</i> | ISO 13007 RG     |
| D. <i>MAPEI Flexcolor<sup>™</sup> CQ</i>               |                  |

### 2. Cementitious Bond Coat Options:

- |  |                    |
|--|--------------------|
| A. <i>Kerabond<sup>™</sup> T/Keralastic<sup>™</sup> System</i> | ISO 13007 C2ES2P2  |
| B. <i>Kerabond/Keralastic<sup>™</sup> System</i>               | ISO 13007 C2ES2P2  |
| C. <i>Granirapid<sup>®</sup> System</i>                        | ISO 13007 C2FS2P2  |
| D. <i>Ultraflex<sup>™</sup> 3</i>                              | ISO 13007 C2ES1P1  |
| E. <i>Ultraflex LFT<sup>™</sup></i>                            | ISO 13007 C2TES1P1 |
| F. <i>Ultraflex LFT Rapid</i>                                  | ISO 13007 C2TFS1P1 |
| G. <i>MAPEI Ultralite<sup>™</sup> Mortar</i>                   | ISO 13007 C2TES1P1 |
| H. <i>Adesilex<sup>™</sup> P10 (for glass tile)</i>            | ISO 13007 C2TE     |