

EXTERIOR BALCONY / DECK FLOORS

Balcony or Deck, Drainage Mat, Mortar Bed
Stone Tile

MAPEI: MF104-Stone
TCNA: F104-16-Stone
TTMAC: 325ED-A
Version: 2016

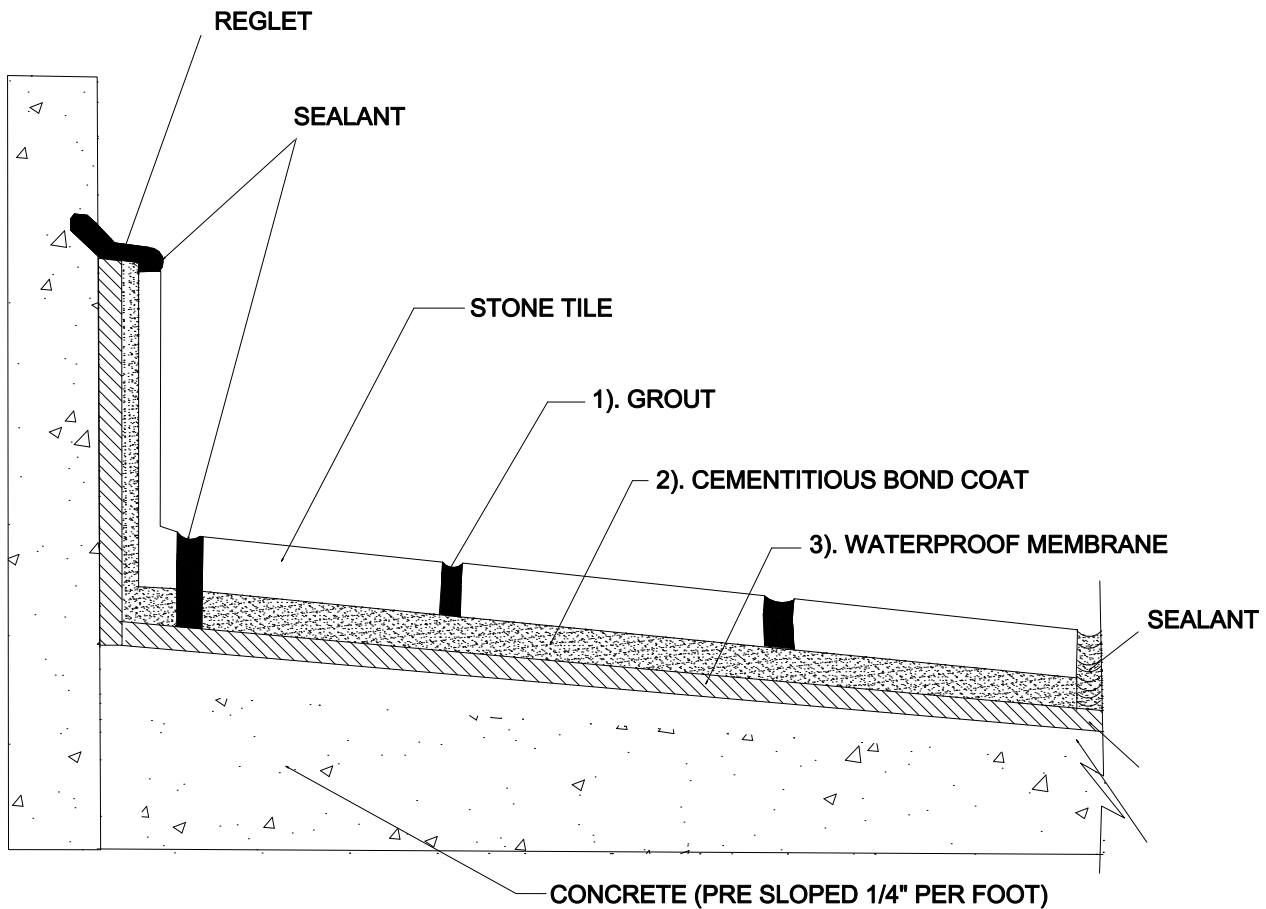

MAPEI Products Assembly

1. Grout Options:

A. Ultracolor® Plus	ISO 13007 CG2WAF
B. Keracolor™ U	ISO 13007 CG2WA
C. MAPEI Flexcolor™ CQ	

2. Cementitious Bond Coat

A. Kerabond/Keralastic™ System	ISO 13007 C2ES2P2
B. Kerabond™ T / Keralastic System	ISO 13007 C2ES2P2
C. Graniraplo® System	ISO 13007 C2FS2P2

3. Waterproofing Membrane Options (combined with Mapeband™ accessories):

A. Mapelastic™ 315	
B. Mapelastic AquaDefense	