

INTERIOR FLOORS OVER CONCRETE

On-Ground or Above-Ground Concrete
Unbonded Mortar Bed, Waterproof Membrane
Stone Tile

MAPEI: MF121-Stone
TCNA: F121-16-Stone
TTMAC: N/A
Version: 2016

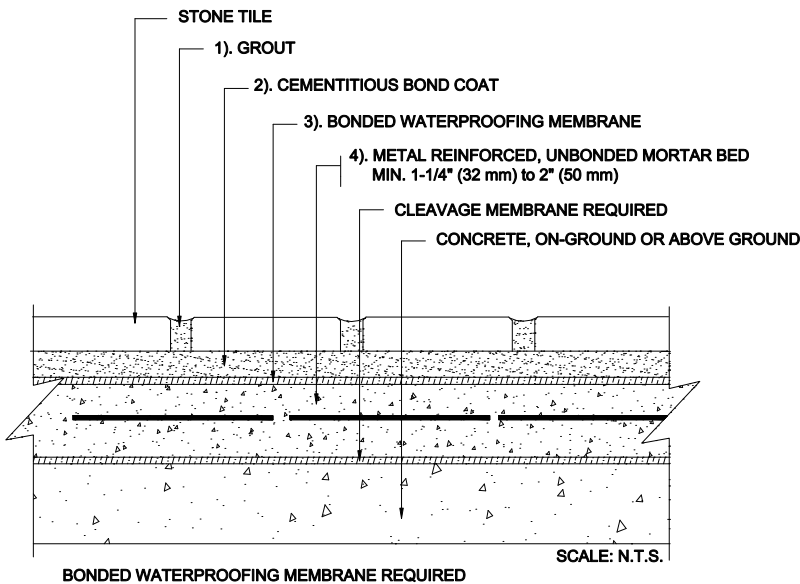

MAPEI Products Assembly

1. Grout Options:

A. <i>Ultracolor[®] Plus</i>	ISO 13007 CG2WAF
B. <i>Keracolor[™] U</i>	ISO 13007 CG2WA
C. <i>Kerapoxy[®]</i>	ISO 13007 RG
D. <i>Kerapoxy CQ</i>	ISO 13007 RG
E. <i>MAPEI Flexcolor[™] CQ</i>	

2. Cementitious Bond Coat Options:

A. <i>Kerabond/Keralastic[™] System</i>	ISO 13007 C2ES2P2
B. <i>Kerabond[™] T / Keralastic[™] System</i>	ISO 13007 C2ES2P2
C. <i>Granirapid[™] System</i>	ISO 13007 C2FS2P2
D. <i>Ultraflex[™] 3</i>	ISO 13007 C2ES1P1
E. <i>Ultraflex LFT[™]</i>	ISO 13007 C2TES1P1
F. <i>Ultraflex LFT Rapid</i>	ISO 13007 C2TFS1P1

3. Bonded Waterproof Membrane Options:

A. <i>Mapelastic[™] AquaDefense</i>
B. <i>Mapelastic 315</i>

4. Metal-Reinforced, Unbonded Mortar Bed:

A. <i>Modified Mortar Bed</i>
