

EXTERIOR WALLS

Masonry or Concrete
Stone Tile

MAPEI: MW202E-Stone
TCNA: W202E-16-Stone
TTMAC: 303-W
Version: 2016

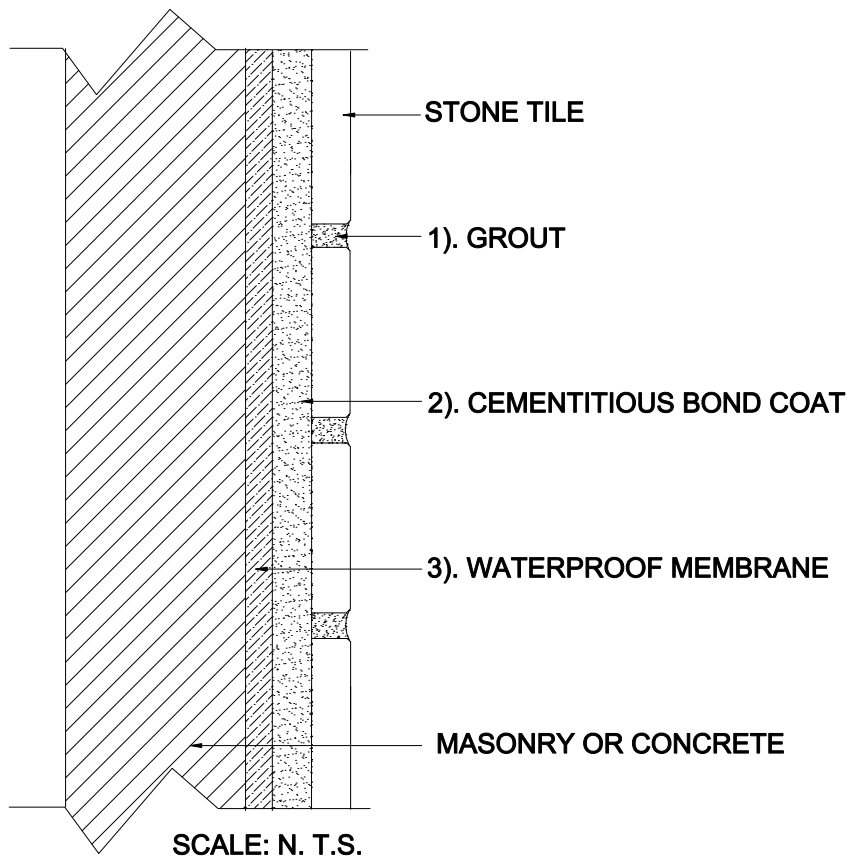

MAPEI Products Assembly

1. **Grout:**
 - A. *Ultracolor[®] Plus* ISO 13007 CG2WAF

2. **Cementitious Bond Coat Options:**
 - A. *Kerabond[™] T / Keralastic[™] System* ISO 13007 C2ES2P2
 - B. *Kerabond/Keralastic[™] System* ISO 13007 C2ES2P2
 - C. *Granirapid[®] System* ISO 13007 C2FS2P2
 - D. *Ultraflex[™] LFT[™]* ISO 13007 C2TES1P1
 - E. *Ultraflex LFT Rapid* ISO 13007 C2TFS1P1
 - F. *Ultraflex 3* ISO 13007 C2ES1P1

3. **Waterproofing Membrane Options:**
 - A. *Mapelastic[™] AquaDefense*
 - B. *Mapelastic 315*