

INTERIOR WALLS OVER MASONRY OR CONCRETE

Masonry or Concrete
Stone Tile

MAPEI: MW202I-Stone
TCNA: W202I-16-Stone
TTMAC: 303-W
Version: 2016

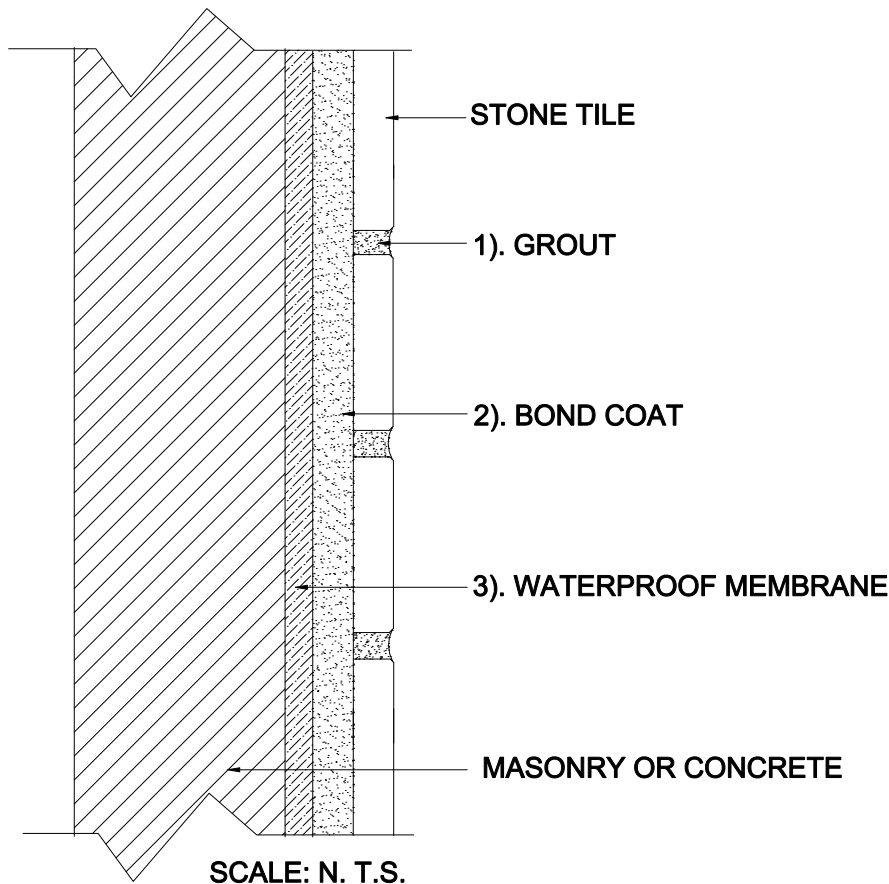

MAPEI Products Assembly

1. **Grout Options:**

A. Kerapoxy® or Kerapoxy CQ	ISO 13007 RG
B. Ultracolor® Plus	ISO 13007 CG2WAF
C. Keracolor™ U	ISO 13007 CG2WA
D. MAPEI Flexcolor™ CQ	

2. **Bond Coat Options:**

A. Kerabond™ T / Kerabond™ System	ISO 13007 C2E81P1
B. Kerabond/Kerabond™ System	ISO 13007 C2E81P1
C. Graniplo® System	ISO 13007 C2F82P2
D. Ultraflex™ LFT™	ISO 13007 C2TE81P1
E. Ultraflex LFT Rapid	ISO 13007 C2TF81P1
F. Ultraflex 3	ISO 13007 C2E81P1
G. Kerapoxy® 410	ISO 13007 R2

3. **Waterproof Membrane:**

A. Mapelastic™ AquaDefense	
----------------------------	--

(for use with Cementitious Bond Coat only)