

# INTERIOR WALLS OVER WOOD OR METAL STUDS

Wood or Metal Studs  
Gypsum Board  
Cementitious Bond Coat  
Stone Tile

MAPEI: MW243-Stone  
TCNA: W243-16-Stone  
TTMAC: 304-W  
Version: 2016

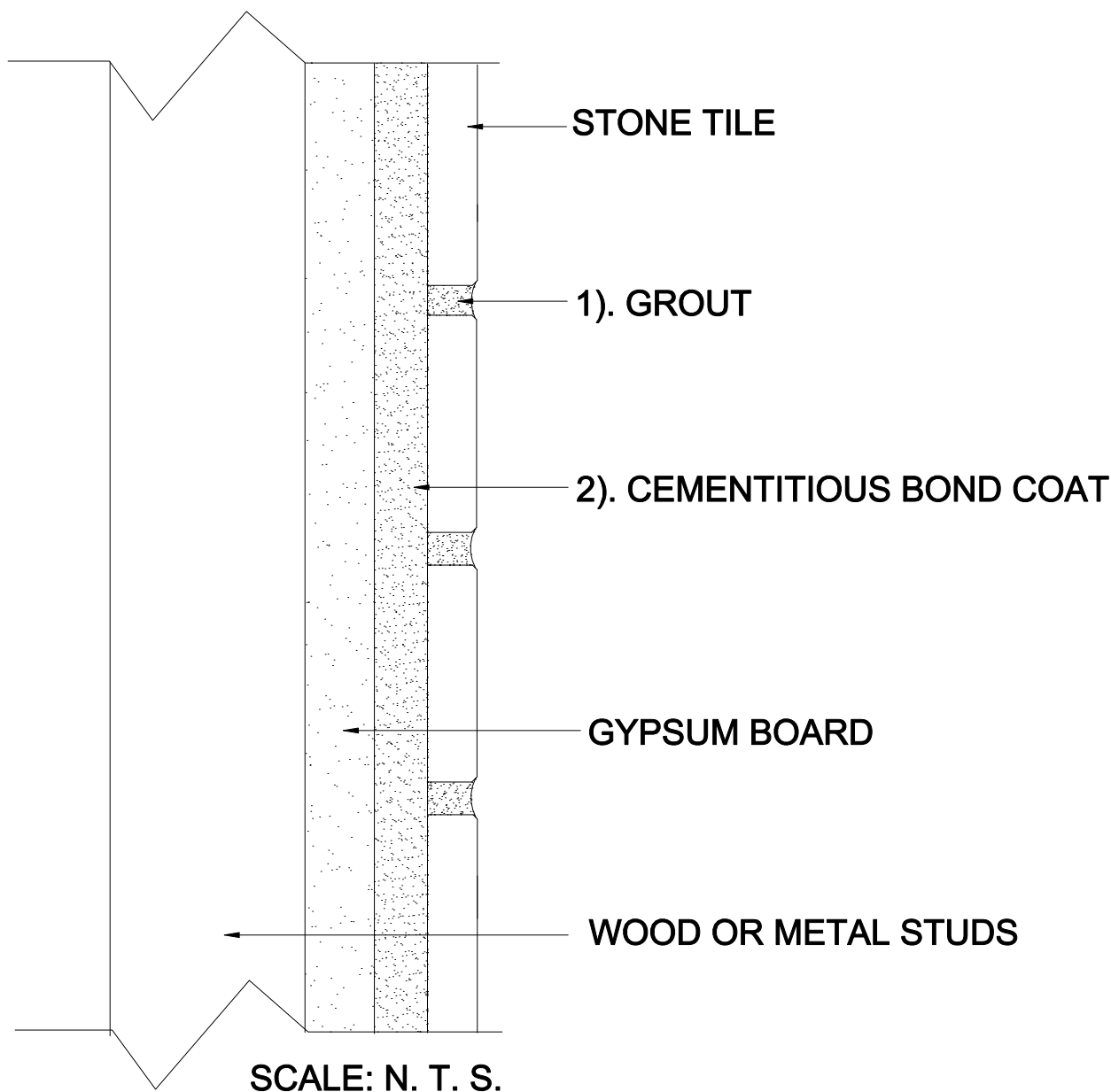

## MAPEI Products Assembly

### 1. Grout Options:

- |   |                  |
|---|------------------|
| A. Ultracolor <sup>®</sup> Plus         | ISO 13007 CG2WAF |
| B. Keracolor <sup>™</sup> U             | ISO 13007 CG2WA  |
| C. Kerapoxy <sup>®</sup> or Kerapoxy CQ | ISO 13007 RG     |
| D. MAPEI Flexcolor <sup>™</sup> CQ      |                  |

### 2. Cementitious Bond Coat Options:

- |   |                    |
|---|--------------------|
| A. Kerabond <sup>™</sup> T / Keralestic <sup>™</sup> System | ISO 13007 C2E82P2  |
| B. Kerabond/Keralestic <sup>™</sup> System                  | ISO 13007 C2E82P2  |
| C. Granireal <sup>®</sup> System                            | ISO 13007 C2F82P2  |
| D. MAPEI Ultralite <sup>™</sup> Mortar                      | ISO 13007 C2TE81P1 |
| E. Ultraflex <sup>™</sup> LFT <sup>™</sup>                  | ISO 13007 C2TE81P1 |
| F. Ultraflex LFT Rapid                                      | ISO 13007 C2TF81P1 |
| G. Ultraflex 3  | ISO 13007 C2E81P1  |