

- CEILING PANEL FASTENER SPACING NOTES:**
1. WALL PANEL CLIPS – FASTENER LOCATED TO PENETRATE EACH CLIP'S TOP FLANGE.
 2. HANGER CLIP – QUANTITY OF FASTENERS PER CLIP AS SPECIFIED FOR DESIGN LOAD.

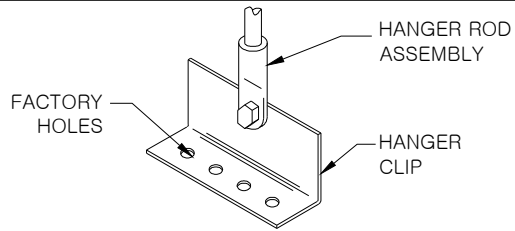

HANGER CLIP DETAIL

HANGER ROD ASSEMBLY ROD DIAMETER AND SPACING AS SPECIFIED PER DESIGN (NOT BY METL-SPAN)

1/4-14 HWH TYPE 3 FASTENER WITH SEALING WASHER (SEE NOTE FOR FASTENER SPACING.)
NOTE: MARK LOCATION OF WALL PANEL CLIPS ON THE CEILING PANEL AS THEY ARE BEING INSTALLED.

1/4-14x 7/8" HWH TYPE 1 SELF DRILLING LAP FASTENER AT 8" O.C.

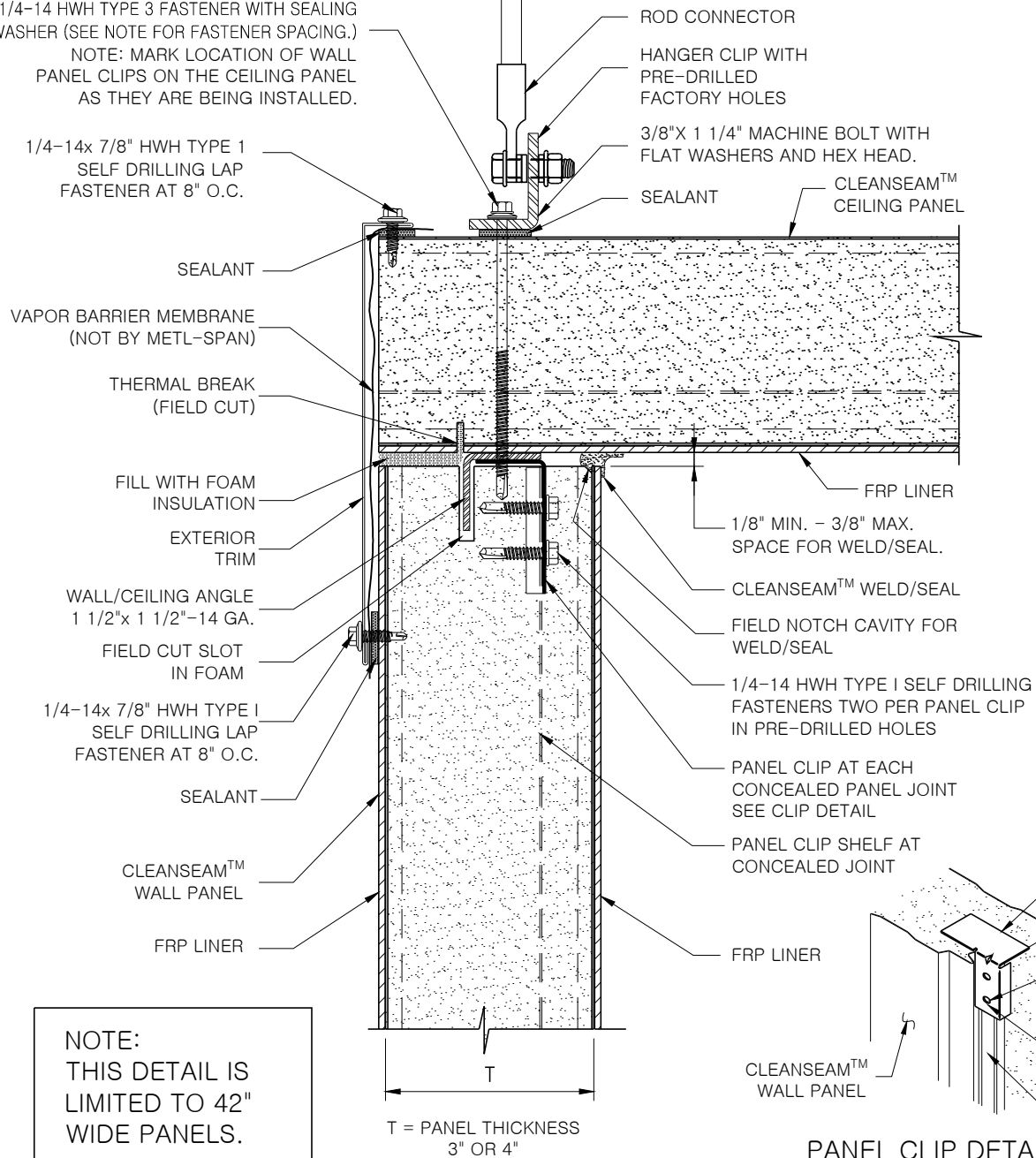

NOTE:
THIS DETAIL IS LIMITED TO 42" WIDE PANELS.

PANEL CLIP DETAIL

**APPLICATION:
PROCESSING**

CLEANSEAM™
PARTITION TO CEILING DETAIL
CONCEALED FRAMING

CSM-CG-12

DATE: Nov. 9, 2016