

Boral Steel® Architectural Details are divided into three (3) categories based on the install method used:

BATTEN (Panel is exposed fastened & mounted onto a wood 2x2 batten or steel hat channel)

DIRECT (Panel is exposed fastened & mounted Direct-to-the roof-deck)

GRANITE-RIDGE Shingle (Panel is hidden fastened & mounted Direct-to-the roof-deck)

Architectural details provided for Boral Steel® customers only

***Batten Fasteners omitted for clarity.**

See fastening drawings for panel and batten attachment.

Battens: to be nominal 2"x2" spruce pine fir #2 or better.
Fastener number, spacing and size as per fastener chart.
Install using appropriate Boral Steel "Batten Spacers".

Boral Steel Z-Bar
Boral Steel Under Pan: For use in limited clearance locations

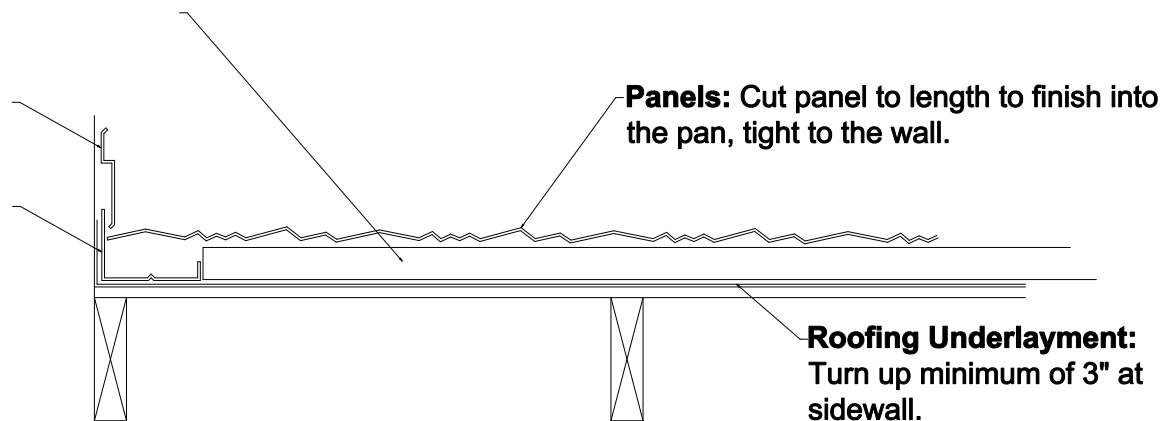

Profiles:
PINE-CREST Shake
BARREL-VAULT Tile
PACIFIC Tile

Batten Spacing

PINE-CREST Shake: 14 $\frac{1}{4}$ "

PACIFIC Tile: 14 $\frac{1}{4}$ "

BARREL-VAULT Tile: 14"

**BATTEN
Side-Wall Underpan**

Boral Steel Stone Coated Roofing
7575 Irvine Ctr Dr Suite 100, Irvine, CA 92618

Drawings
are not to
scale