

*Note: Tiles to be installed in such a fashion as to prevent water diversion of blockage. Fasteners shall be of sufficient length to penetrate $\frac{3}{4}$ " into, or through the roof sheathing, which ever is less. See Table 1A and 1B for more information.

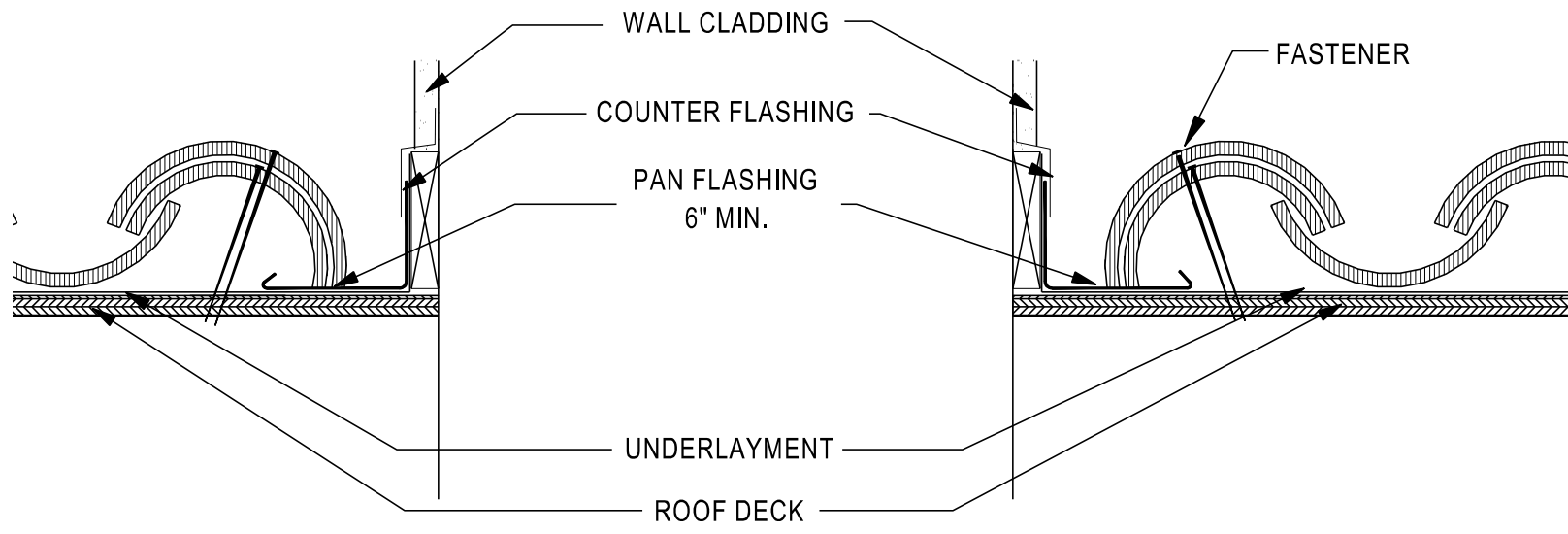

Notes:

1. Underlayment should extend a minimum of 4" up vertical wood blocking or wall.
2. See MC-12B for additional flashing details.

