

NOTE:

REV.	0
------	---

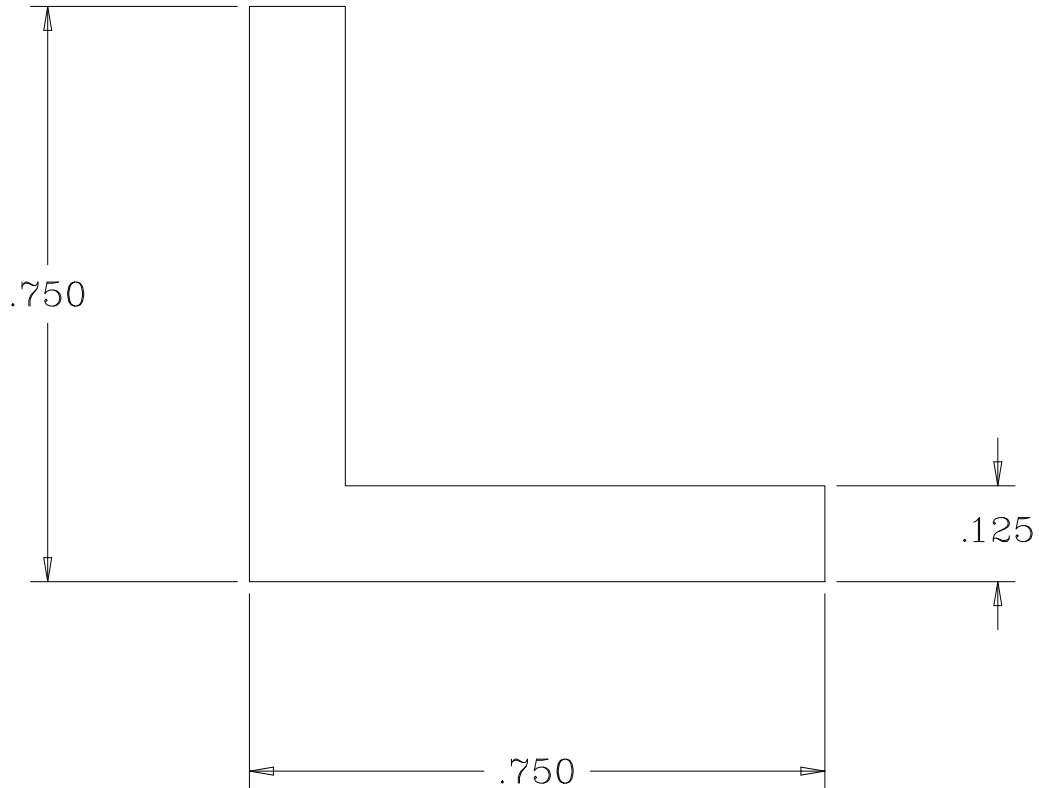

MORSE
INDUSTRIES
Working Solutions in Aluminum, Plastics and Stainless Steel

Telephone: (253) 852-1399
Fax: (253) 520-9972
www.morseindustries.com

DR BY: ADAM FINCH 6/28/04

CUT LENGTH: (240") 20' +/- .063"

FINISH: AEY ; VEL ; BZD

AREA: 0.1719 INCH²

WPF: 0.202 LB

PART NUMBER: A40-1185

DIE: 000218 RFQ: 0000

UNSPECIFIED CORNERS: 0.010

ALLOY: 6063-T5

WALL: 0.125

±1/64	FRACTION X.X X.XX X.XXX X.XXXX
±0.1000	
±0.0070	
±0.0005	

UNIT OF TOL.
ANGLE ±1°