

NOTES:

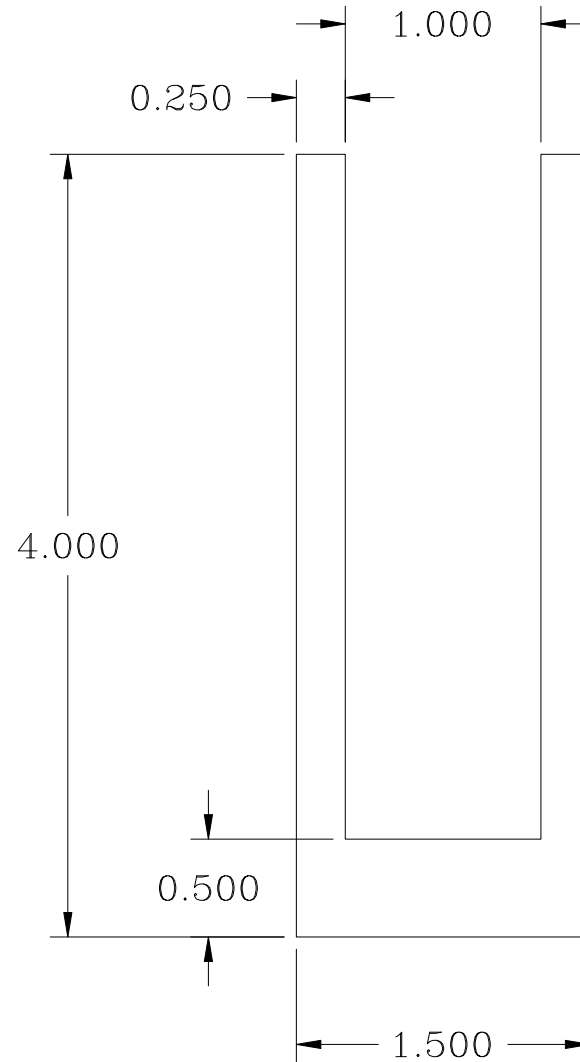

**MORSE**  
INDUSTRIES  
Working Solutions in Aluminum, Plastics and Stainless Steel

Telephone: (253) 852-1399  
Fax: (253) 520-9972  
www.morseindustries.com

DR BY: ADAM FINCH 6/16/03  
CUT LENGTH 12'  
FINISH  
AREA: 2.5000 INCH<sup>2</sup> WPF: 2.937 LB

PART NUMBER: A42-1002  
DESCRIPTION:  
UNSPECIFIED CORNERS: 0.007  
ALLOY: 6063-T5 WALL: 0.063

±1/64	FRACTION
±0.1600	X.X
±0.0160	X.XX
±0.0005	X.XXX
	X.XXXX
SUBTRACT 5 PTS. FOR EACH UNIT OF TOL. ANGLE ±1°	