

NOTES:

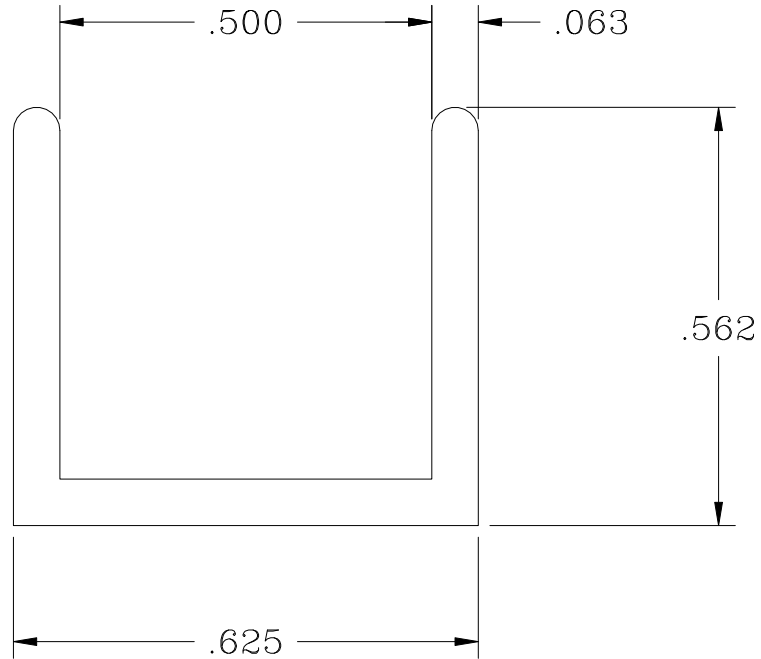
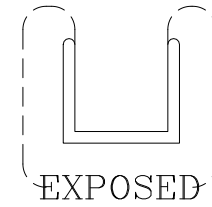

**MORSE**  
INDUSTRIES  
Working Solutions in Aluminum, Plastics and Stainless Steel

DR BY: ADAM FINCH	9/30/03	PART NUMBER: RFQ_5404	±1/64	FRACTION X.X X.XX X.XXX X.XXXX
CUT LEGHT	12'	DESCRIPTION: A50-8525	±0.0100	
FINISH:		UNSPECIFIED CORNERS	±0.0005	
AREA: 0.1007 inch <sup>2</sup>	WPF: 0.118lb	ALLOY: 6463-T1	WALL: 0.063	SUBTRACT 5 PTS. FOR EACH UNIT OF TOL. ANGLE ±1°

Telephone: (253) 852-1399  
 Fax: (253) 520-9972  
 www.morseindustries.com