

NOTES:

1. ALL FAB AND DEBURRING TO BE DONE BEFORE ANODIZING

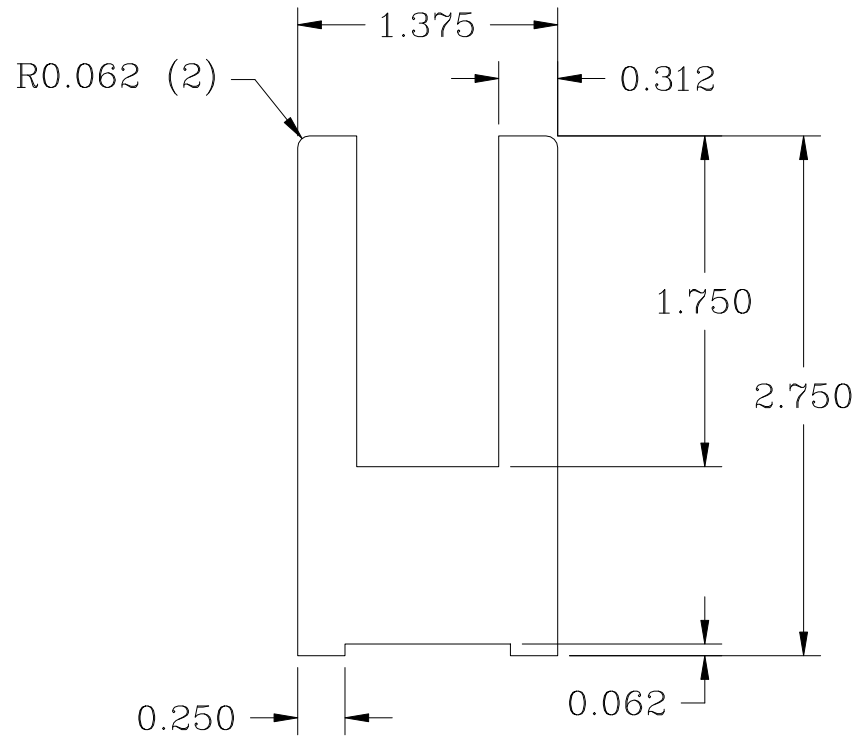

MORSE
INDUSTRIES
Working Solutions in Aluminum, Plastics and Stainless Steel

Telephone: (253) 852-1399
Fax: (253) 520-9972
www.morseindustries.com

DR BY: ADAM FINCH 1/27/04

CUT LENGTH 20'

FINISH

AREA: 2.4111 INCH²

WPF: 2.833 LB

PART NUMBER: A42-0064

DESCRIPTION:

UNSPECIFIED CORNERS: 0.010

ALLOY: 6063-T5

WALL: 0.312

±1/64	FRACTION
±0.1600	X.X
±0.0160	X.XX
±0.0005	X.XXX
	X.XXXX
SUBTRACT 5 PTS. FOR EACH UNIT OF TOL. ANGLE ±1°	