

# Motorized Retractable Wall Screen

## Recessed Roller Placement Details -

### Minimum Cavity Size for 5" Roller

#### PRODUCT LIMITATION

SIZE LIMITATION FOR THE 5 INCH ROLLER IS:  
25 FEET (Wide) x 16 FEET (High/Pull Length)

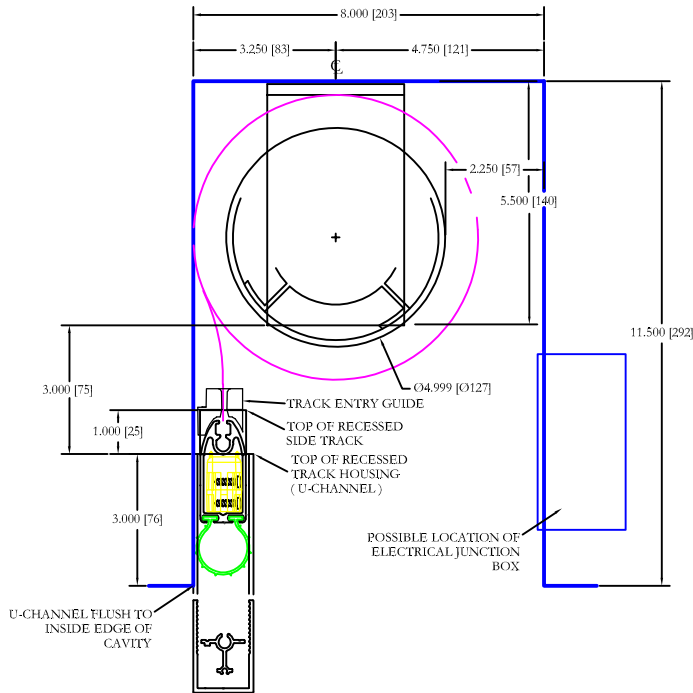

PLACEMENT OF 5" ROLLER,  
5-1/2" ROLLER MOUNTING BRACKET  
AND RECESSED SIDE TRACK

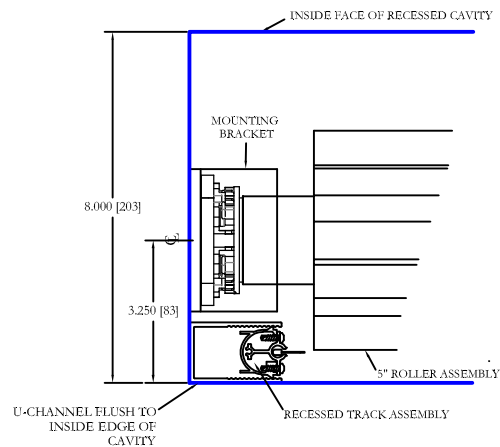

RELATIONSHIP OF U-CHANNEL  
TO MOTOR BRACKET IN A MINIMUM  
RECESSED CAVITY C/W 5" ROLLER

All dimensions are given in inches, millimeters conversion in brackets

#### NOTE:

Smaller cavity sizes may be available for  
your application;  
Please check with your local Phantom  
Authorized Distributor.

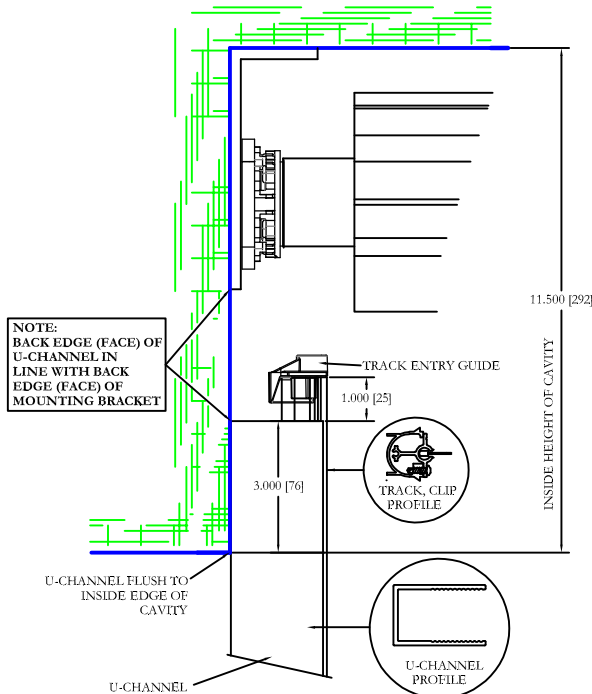

RELATIONSHIP OF THE  
SIDE TRACK U-CHANNEL  
TO THE 5-1/2" MOTOR MOUNTING BRACKET

Rev 02	Title change	N.D.R.	03/06/18
Rev 01	Addition of Track Entry Guide on Recessed Track and updated cavity dimensions	N.D.R.	01/19/16

Rev #	Description of Revision	Approved by	Rev Date
Creator:	Date:	Approved By/Date:	
N.D.R.	07/30/2015		
Drawing Title:			
PSEXECINSTALLMINCAVITYSIZE5INCH02			
© 2016 Phantom Mfg. Intl Ltd.			Scale: 1 : 1