

REVISION HISTORY			
REV	DESCRIPTION	DATE	APPROVED

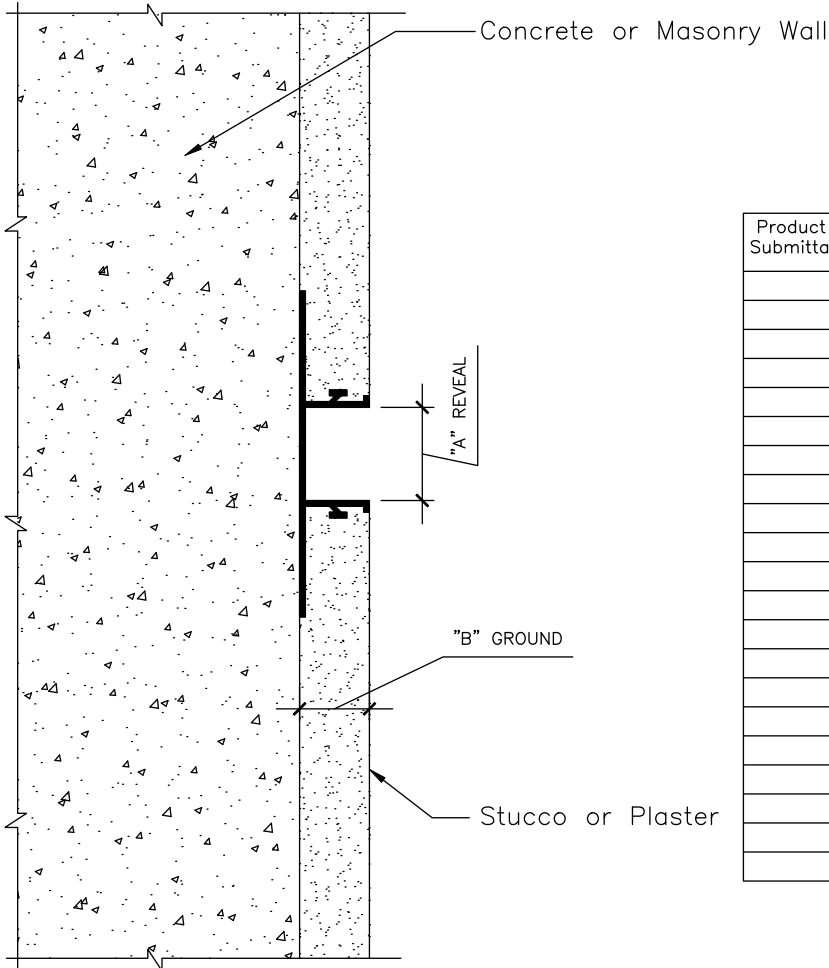

Product Submittal	Product Number	Dimension "A" Reveal	Dimension "B" Ground
	707-25	1/2" [13 mm]	1/4" [6 mm]
	707-38	1/2" [13 mm]	3/8" [10 mm]
	707-50	1/2" [13 mm]	1/2" [13 mm]
	707-58	1/2" [13 mm]	5/8" [16 mm]
	707-75	1/2" [13 mm]	3/4" [19 mm]
	707-78	1/2" [13 mm]	7/8" [22 mm]
	708-25	3/4" [19 mm]	1/4" [6 mm]
	708-38	3/4" [19 mm]	3/8" [10 mm]
	708-50	3/4" [19 mm]	1/2" [13 mm]
	708-58	3/4" [19 mm]	5/8" [16 mm]
	708-75	3/4" [19 mm]	3/4" [19 mm]
	708-78	3/4" [19 mm]	7/8" [22 mm]
	709-25	1" [25 mm]	1/4" [6 mm]
	709-38	1" [25 mm]	3/8" [10 mm]
	709-50	1" [25 mm]	1/2" [13 mm]
	709-58	1" [25 mm]	5/8" [16 mm]
	709-75	1" [25 mm]	3/4" [19 mm]
	709-78	1" [25 mm]	7/8" [22 mm]

Product Submittal	Product Number	Dimension "A" Reveal	Dimension "B" Ground
	710-25	1 1/2" [38 mm]	1/4" [6 mm]
	710-38	1 1/2" [38 mm]	3/8" [10 mm]
	710-50	1 1/2" [38 mm]	1/2" [13 mm]
	710-58	1 1/2" [38 mm]	5/8" [16 mm]
	710-75	1 1/2" [38 mm]	3/4" [19 mm]
	710-78	1 1/2" [38 mm]	7/8" [22 mm]
	711-25	2" [51 mm]	1/4" [6 mm]
	711-38	2" [51 mm]	3/8" [10 mm]
	711-50	2" [51 mm]	1/2" [13 mm]
	711-58	2" [51 mm]	5/8" [16 mm]
	711-75	2" [51 mm]	3/4" [19 mm]
	712-50	2 1/2" [64 mm]	1/2" [13 mm]
	712-58	2 1/2" [64 mm]	5/8" [16 mm]
	712-75	2 1/2" [64 mm]	3/4" [19 mm]
	713-50	3" [76 mm]	1/2" [13 mm]
	713-58	3" [76 mm]	5/8" [16 mm]
	713-75	3" [76 mm]	3/4" [19 mm]
	714-50	4" [102 mm]	1/2" [13 mm]
	714-58	4" [102 mm]	5/8" [16 mm]
	714-75	4" [102 mm]	3/4" [19 mm]
	714-78	4" [102 mm]	7/8" [22 mm]

ULTRA-TRAC System Plaster Reveal

SCALE: 6" = 1'-0"

- NOTES:**
1. Typical installation shown.
 2. Actual installation shall meet all local building codes and ASTM standards.
 3. All butt joints, intersections, ends and corners shall be caulked at the time of installation using an elastomeric sealant, such as Plastic Components "Ultra Tech" (PC-ULTW).

	NAME	DATE	PLASTIC COMPONENTS, Inc.	
DRAWN	JKW	1/6/2012	9051 NW 97th Terrace ~ Miami, FL 33178	
CHECKED			800-327-7077 ~ www.plasticcomponents.com	
ENG APPR			TITLE	
MGR APPR			ULTRA-TRAC System Plaster Reveal	
UNLESS OTHERWISE SPECIFIED DIMENSIONS ARE IN INCHES ANGLES ±X.X° 2 PL ±X.XX 3 PL ±X.XXX			SIZE	REV
			DWG NO A uLTRA-TRAC 700 Series	
			FILENAME: ULTRA-TRAC-700-Series.dwg	
			SCALE:	WEIGHT:
			SHEET 1 OF 1	