

ALUMINUM ALTERNATING TREAD LADDER w/ WALK-THRU

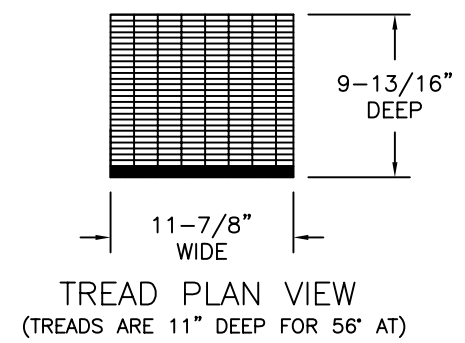

Ⓐ 19-SGI-4 BAR GRATING TREAD (GROOVED NOSING)

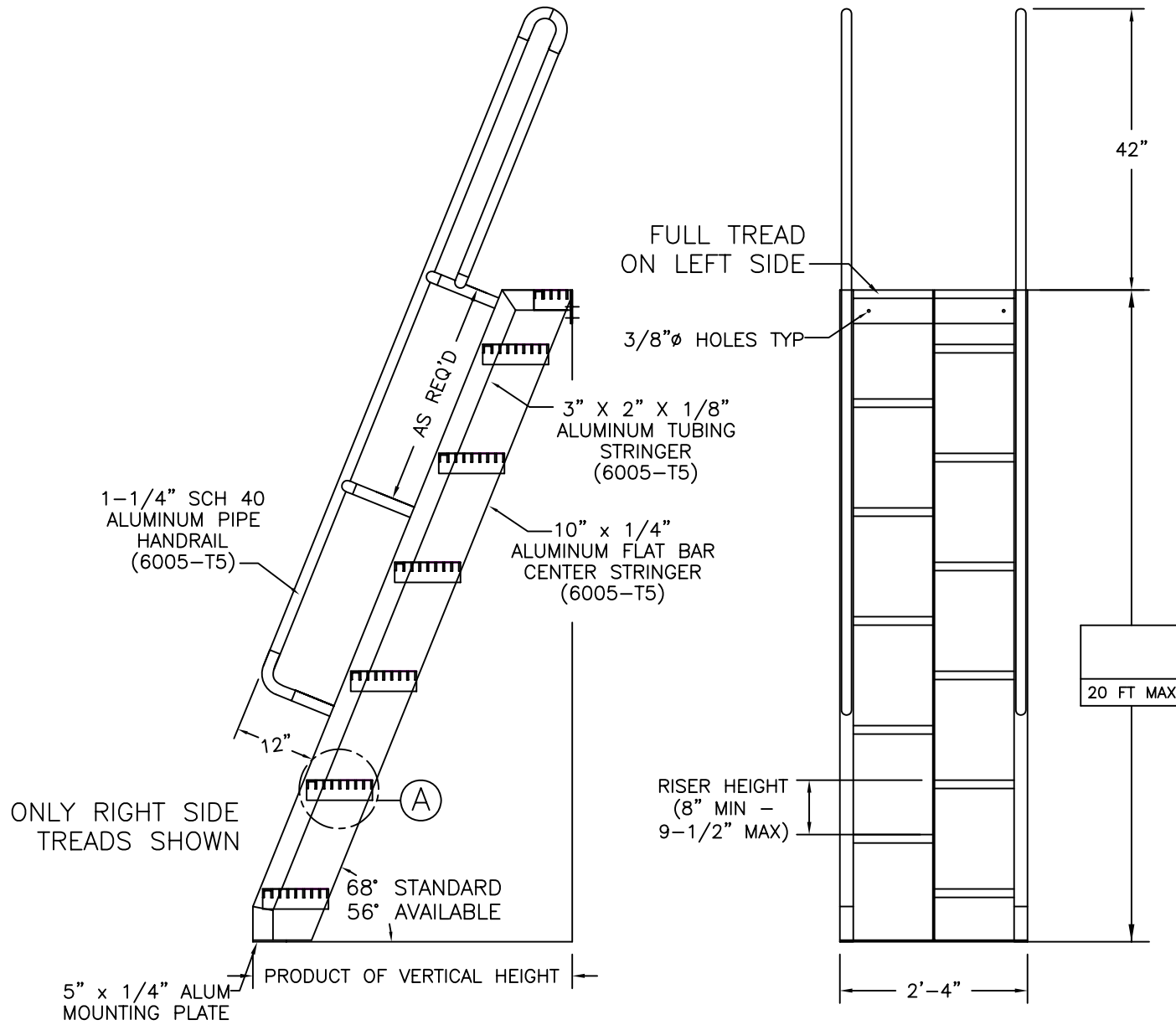
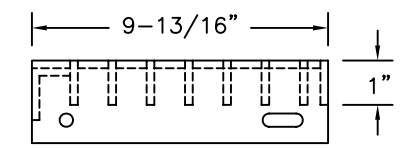

TREAD WELDED AND BOLTED TO STRINGER WITH 3/8" HEX HEAD BOLTS

NOTE: ALL BOLTS/FASTENERS NECESSARY TO ANCHOR LADDER ARE BY OTHERS.

FACTORY FINISH
ALUMINUM-MILL FINISH AT-2

Precision Ladders, LLC
 P.O. BOX 2279 Morristown, TN 37816-2279
 Ph: (423) 586-2265 Fax: (423) 586-2091
 www.PrecisionLadders.com

WORK ORDER: ()	DWG. CHECK	ARCH'T OR ENG'R.	PROJECT		PRECISION REP
	BUILT BY:	PURCHASE ORDER	DATE	PURCHASER	SERIAL#
	CHECKED BY:	DRAWN BY:	DATE	MODEL#	QTY.
		DNH	10/19/15	AT-	