

# FIXED LADDER w/OVERSHOOT

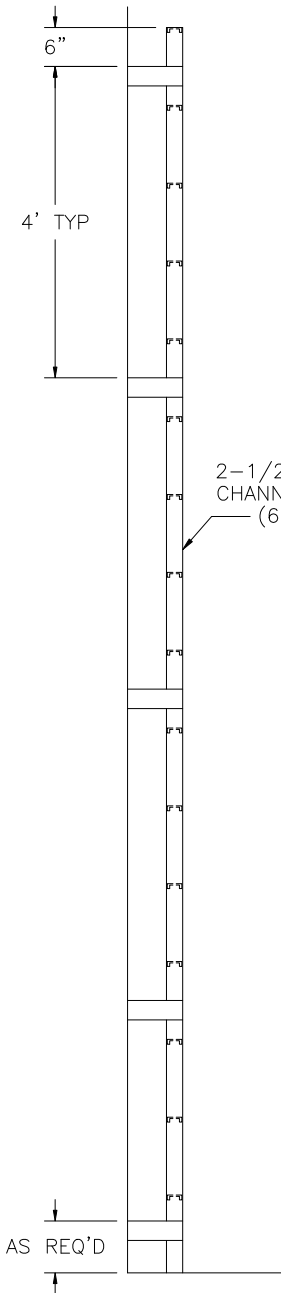

2-1/2" ALUMINUM CHANNEL SIDERAIL (6005-T5)

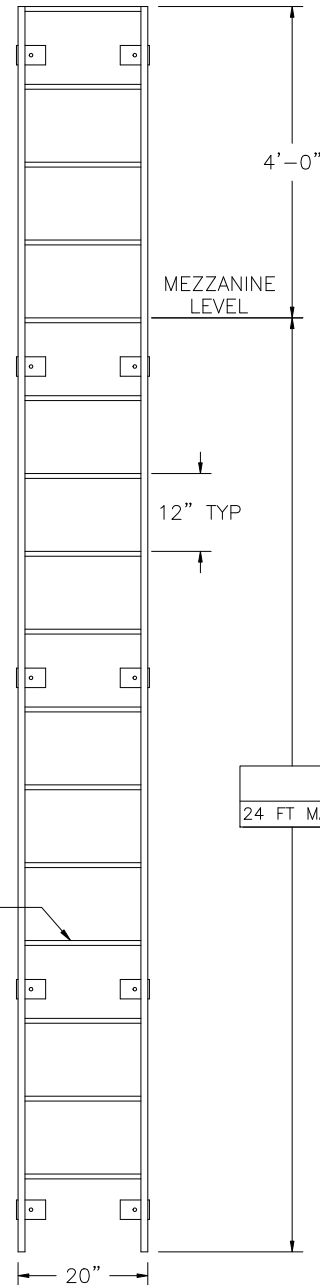

2-1/4" SERRATED ALUMINUM RUNG (6005-T5)

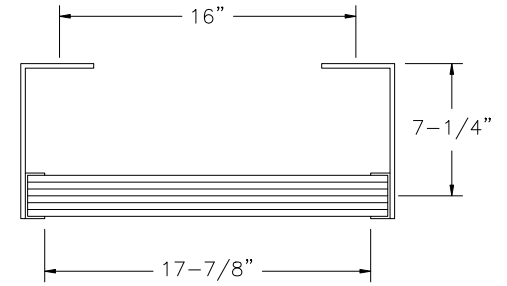

PLAN

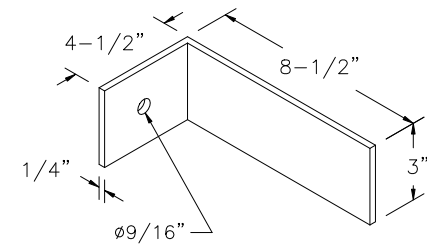

BRACKET DETAIL

NOTE:  
ALL BOLTS/FASTENERS  
NECESSARY TO ANCHOR  
LADDER ARE BY OTHERS.

FACTORY FINISH  
ALUMINUM-MILL FINISH

FL-04

NOTE: FALL ARREST SYSTEM REQUIRED ON LADDERS EXCEEDING 24'-0" (SEE DETAIL FL-13-FAS)

LADDERS MANUFACTURED BY PRECISION LADDERS, LLC  
COMPLY WITH OSHA 1910 SUBPART D AND ANSI 14.3

LADDER RATED AT 1,500 LBS

Precision Ladders, LLC  
P.O. BOX 2279 Morristown, TN 37816-2279  
Ph: (423) 586-2265 Fax: (423) 586-2091  
www.PrecisionLadders.com

WORK ORDER: ( )

DWG. CHECK	ARCHT OR ENG'R.	PROJECT		PRECISION REP
BUILT BY:	PURCHASE ORDER	REVISION	PURCHASER	SERIAL#
CHECKED BY:	DRAWN BY: DNH	DATE 4/4/19	MODEL# FL-	QTY.